



ADDENDUM # 015

Date: 07/13/18

RE: Cherokee Nation Entertainment
Tahlequah Casino

From: James R Childers Architect, Inc.
45 South 4th Street
Fort Smith, Arkansas 72901

This addendum forms part of the Contract Documents, and modifies the documents as noted below. Bidder must acknowledge receipt of this addendum in the FMC Bid Form. Failure to do so may subject the bidder to disqualification.

- Item 1** Civil Drawings
- Item 2** Landscape Drawings
- Item 3** IT Drawings
- Item 4** Mechanical Drawings
- Item 5** Electrical Drawings



ADG. PC
 920 W Main
 Oklahoma City, OK 73106
 405.232.5700 ▪ www.adgokc.com

Addendum 15

DATE: 7/13/2018

PROJECT: CNE Tahlequah Casino

PROJECT NO: 18-010

To the Prospective Bidders of the Work titled above:

This Addendum is to be incorporated into the Contract Documents and modifies the current version of the Contract Documents for the above referenced Project.

The Addendum consists of the following:

<u>Item</u>	<u>Size</u>	<u>No. of Pages</u>
Addendum	8 1/2 x 11	2
Drawings	24" x 36"	1

NARRATIVE SUMMARY OF MODIFICATIONS

The following is a general description of the modifications included in this addendum. The provided list may or may not include all modifications which have been made. The Contractor is advised to make their own review of the Construction Documents to determine all potential impacts to the Contract Price. The Scope of Work presented by the Construction Drawings and Specifications included herein shall be considered included in the submitted bid price.

1. Routing of proposed telecommunication services has been adjusted per comments from Owner and IT Consultant.

REVISIONS TO THE PROJECT MANUAL

None

REVISIONS TO THE CONSTRUCTION DRAWINGS

- Item 1. Refer to Drawings: As shown below replace the entire drawing sheet with the revised drawings sheet included in this addendum as an attachment.

Replace:

Number	Name	Issue Date
C2.02b	UTILITY PLAN INDEX	June 11, 2018

With the attached:

Number	Name	Issue Date
C2.02b	UTILITY PLAN INDEX	July 13, 2018

END OF ADDENDUM

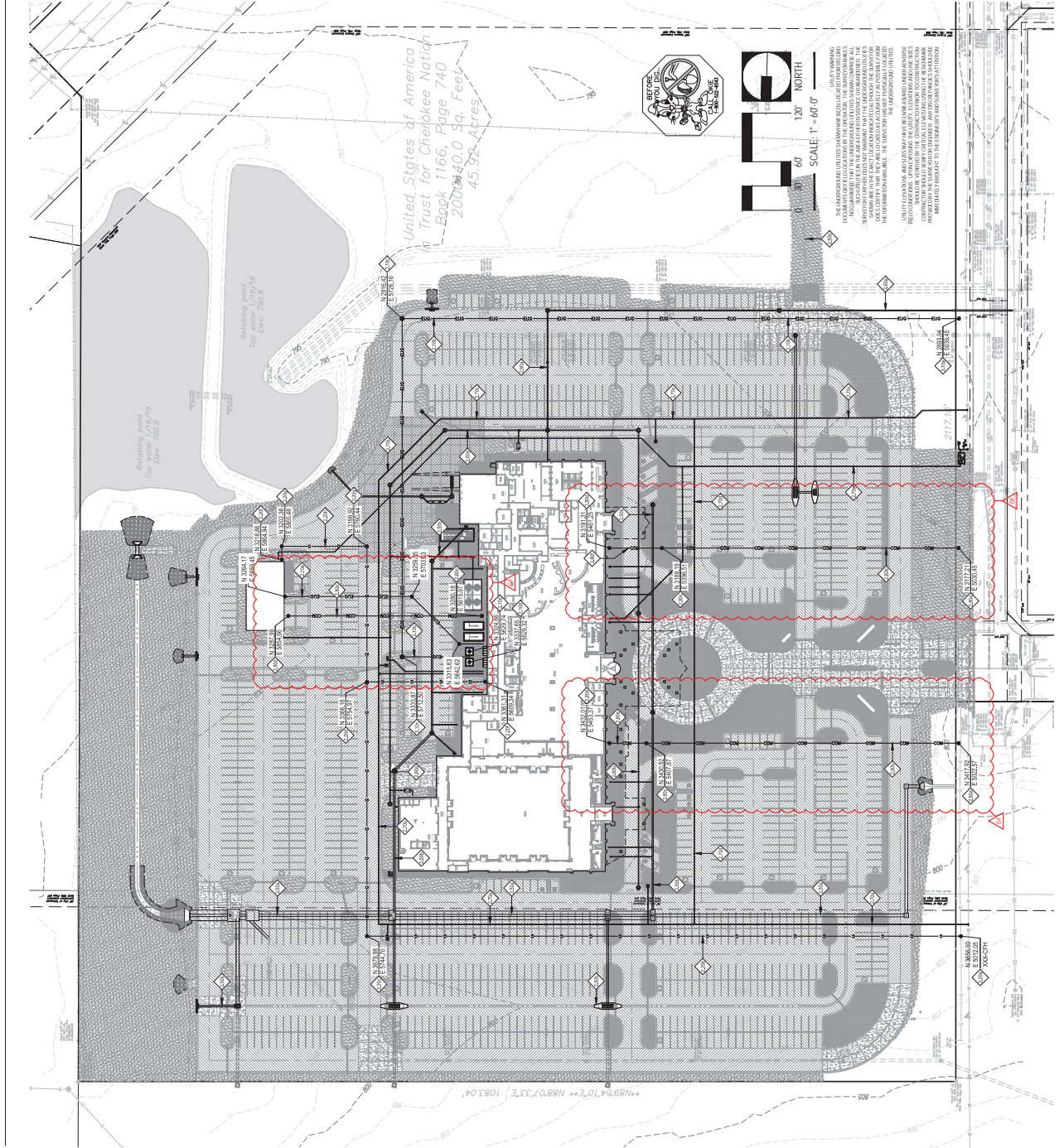

01 PLAN VIEW: INSET
SCALE: 1" = 60'

LEGEND

- PROPPOSED CONCRETE FINISH FLOOR
- PROPPOSED ASPHALT FINISH FLOOR
- PROPPOSED GRAVEL FINISH FLOOR
- PROPPOSED POLYMER CONCRETE FINISH FLOOR
- PROPPOSED 3/4" BARS IN 4" CONC. (SEE SPECIFICATIONS)
- PROPPOSED 1" BARS IN 6" CONC. (SEE SPECIFICATIONS)
- PROPPOSED 2" BARS IN 10" CONC. (SEE SPECIFICATIONS)
- PROPPOSED 4" BARS IN 16" CONC. (SEE SPECIFICATIONS)
- PROPPOSED 6" BARS IN 20" CONC. (SEE SPECIFICATIONS)
- PROPPOSED 8" BARS IN 24" CONC. (SEE SPECIFICATIONS)
- PROPPOSED 10" BARS IN 28" CONC. (SEE SPECIFICATIONS)
- PROPPOSED 12" BARS IN 32" CONC. (SEE SPECIFICATIONS)
- PROPPOSED 14" BARS IN 36" CONC. (SEE SPECIFICATIONS)
- PROPPOSED 16" BARS IN 40" CONC. (SEE SPECIFICATIONS)
- PROPPOSED 18" BARS IN 44" CONC. (SEE SPECIFICATIONS)
- PROPPOSED 20" BARS IN 48" CONC. (SEE SPECIFICATIONS)
- PROPPOSED 22" BARS IN 52" CONC. (SEE SPECIFICATIONS)
- PROPPOSED 24" BARS IN 56" CONC. (SEE SPECIFICATIONS)
- PROPPOSED 26" BARS IN 60" CONC. (SEE SPECIFICATIONS)
- PROPPOSED 28" BARS IN 64" CONC. (SEE SPECIFICATIONS)
- PROPPOSED 30" BARS IN 68" CONC. (SEE SPECIFICATIONS)
- PROPPOSED 32" BARS IN 72" CONC. (SEE SPECIFICATIONS)
- PROPPOSED 34" BARS IN 76" CONC. (SEE SPECIFICATIONS)
- PROPPOSED 36" BARS IN 80" CONC. (SEE SPECIFICATIONS)
- PROPPOSED 38" BARS IN 84" CONC. (SEE SPECIFICATIONS)
- PROPPOSED 40" BARS IN 88" CONC. (SEE SPECIFICATIONS)
- PROPPOSED 42" BARS IN 92" CONC. (SEE SPECIFICATIONS)
- PROPPOSED 44" BARS IN 96" CONC. (SEE SPECIFICATIONS)
- PROPPOSED 46" BARS IN 100" CONC. (SEE SPECIFICATIONS)
- PROPPOSED 48" BARS IN 104" CONC. (SEE SPECIFICATIONS)
- PROPPOSED 50" BARS IN 108" CONC. (SEE SPECIFICATIONS)

UTILITY PLAN KEYNOTES

- | ID | DESCRIPTION |
|------|--|
| 2100 | PROPOSED POINT OF ENTRY (POE) FOR UTILITY SERVICE AT THE EXTENSION OF EXISTING UTILITY SERVICE TO THE PROPERTY. THE PROPOSED UTILITY SERVICE SHALL OPERATE UNDER PRESSURE. |
| 2101 | PROPOSED 12" DIAMETER POLYETHYLENE GLASS REINFORCED CONCRETE UTILITY SERVICE MAIN TO BE CONSTRUCTED TO THE PROPERTY. THE PROPOSED UTILITY SERVICE MAIN SHALL OPERATE UNDER PRESSURE. |
| 2102 | PROPOSED 12" DIAMETER POLYETHYLENE GLASS REINFORCED CONCRETE UTILITY SERVICE MAIN TO BE CONSTRUCTED TO THE PROPERTY. THE PROPOSED UTILITY SERVICE MAIN SHALL OPERATE UNDER PRESSURE. |
| 2103 | PROPOSED 12" DIAMETER POLYETHYLENE GLASS REINFORCED CONCRETE UTILITY SERVICE MAIN TO BE CONSTRUCTED TO THE PROPERTY. THE PROPOSED UTILITY SERVICE MAIN SHALL OPERATE UNDER PRESSURE. |
| 2104 | PROPOSED 12" DIAMETER POLYETHYLENE GLASS REINFORCED CONCRETE UTILITY SERVICE MAIN TO BE CONSTRUCTED TO THE PROPERTY. THE PROPOSED UTILITY SERVICE MAIN SHALL OPERATE UNDER PRESSURE. |
| 2105 | PROPOSED 12" DIAMETER POLYETHYLENE GLASS REINFORCED CONCRETE UTILITY SERVICE MAIN TO BE CONSTRUCTED TO THE PROPERTY. THE PROPOSED UTILITY SERVICE MAIN SHALL OPERATE UNDER PRESSURE. |
| 2106 | PROPOSED 12" DIAMETER POLYETHYLENE GLASS REINFORCED CONCRETE UTILITY SERVICE MAIN TO BE CONSTRUCTED TO THE PROPERTY. THE PROPOSED UTILITY SERVICE MAIN SHALL OPERATE UNDER PRESSURE. |
| 2107 | PROPOSED 12" DIAMETER POLYETHYLENE GLASS REINFORCED CONCRETE UTILITY SERVICE MAIN TO BE CONSTRUCTED TO THE PROPERTY. THE PROPOSED UTILITY SERVICE MAIN SHALL OPERATE UNDER PRESSURE. |
| 2108 | PROPOSED 12" DIAMETER POLYETHYLENE GLASS REINFORCED CONCRETE UTILITY SERVICE MAIN TO BE CONSTRUCTED TO THE PROPERTY. THE PROPOSED UTILITY SERVICE MAIN SHALL OPERATE UNDER PRESSURE. |
| 2109 | PROPOSED 12" DIAMETER POLYETHYLENE GLASS REINFORCED CONCRETE UTILITY SERVICE MAIN TO BE CONSTRUCTED TO THE PROPERTY. THE PROPOSED UTILITY SERVICE MAIN SHALL OPERATE UNDER PRESSURE. |
| 2110 | PROPOSED 12" DIAMETER POLYETHYLENE GLASS REINFORCED CONCRETE UTILITY SERVICE MAIN TO BE CONSTRUCTED TO THE PROPERTY. THE PROPOSED UTILITY SERVICE MAIN SHALL OPERATE UNDER PRESSURE. |
| 2111 | PROPOSED 12" DIAMETER POLYETHYLENE GLASS REINFORCED CONCRETE UTILITY SERVICE MAIN TO BE CONSTRUCTED TO THE PROPERTY. THE PROPOSED UTILITY SERVICE MAIN SHALL OPERATE UNDER PRESSURE. |
| 2112 | PROPOSED 12" DIAMETER POLYETHYLENE GLASS REINFORCED CONCRETE UTILITY SERVICE MAIN TO BE CONSTRUCTED TO THE PROPERTY. THE PROPOSED UTILITY SERVICE MAIN SHALL OPERATE UNDER PRESSURE. |
| 2113 | PROPOSED 12" DIAMETER POLYETHYLENE GLASS REINFORCED CONCRETE UTILITY SERVICE MAIN TO BE CONSTRUCTED TO THE PROPERTY. THE PROPOSED UTILITY SERVICE MAIN SHALL OPERATE UNDER PRESSURE. |
| 2114 | PROPOSED 12" DIAMETER POLYETHYLENE GLASS REINFORCED CONCRETE UTILITY SERVICE MAIN TO BE CONSTRUCTED TO THE PROPERTY. THE PROPOSED UTILITY SERVICE MAIN SHALL OPERATE UNDER PRESSURE. |
| 2115 | PROPOSED 12" DIAMETER POLYETHYLENE GLASS REINFORCED CONCRETE UTILITY SERVICE MAIN TO BE CONSTRUCTED TO THE PROPERTY. THE PROPOSED UTILITY SERVICE MAIN SHALL OPERATE UNDER PRESSURE. |
| 2116 | PROPOSED 12" DIAMETER POLYETHYLENE GLASS REINFORCED CONCRETE UTILITY SERVICE MAIN TO BE CONSTRUCTED TO THE PROPERTY. THE PROPOSED UTILITY SERVICE MAIN SHALL OPERATE UNDER PRESSURE. |
| 2117 | PROPOSED 12" DIAMETER POLYETHYLENE GLASS REINFORCED CONCRETE UTILITY SERVICE MAIN TO BE CONSTRUCTED TO THE PROPERTY. THE PROPOSED UTILITY SERVICE MAIN SHALL OPERATE UNDER PRESSURE. |
| 2118 | PROPOSED 12" DIAMETER POLYETHYLENE GLASS REINFORCED CONCRETE UTILITY SERVICE MAIN TO BE CONSTRUCTED TO THE PROPERTY. THE PROPOSED UTILITY SERVICE MAIN SHALL OPERATE UNDER PRESSURE. |
| 2119 | PROPOSED 12" DIAMETER POLYETHYLENE GLASS REINFORCED CONCRETE UTILITY SERVICE MAIN TO BE CONSTRUCTED TO THE PROPERTY. THE PROPOSED UTILITY SERVICE MAIN SHALL OPERATE UNDER PRESSURE. |
| 2120 | PROPOSED 12" DIAMETER POLYETHYLENE GLASS REINFORCED CONCRETE UTILITY SERVICE MAIN TO BE CONSTRUCTED TO THE PROPERTY. THE PROPOSED UTILITY SERVICE MAIN SHALL OPERATE UNDER PRESSURE. |

NOTE TO CONTRACTOR: COORDINATE WITH ALL OTHER UTILITY SERVICES AND PROVIDE THE NECESSARY PROTECTION FOR EXISTING UTILITY SERVICES. THE CONTRACTOR SHALL BE RESPONSIBLE FOR OBTAINING ALL NECESSARY PERMITS AND APPROVALS FROM THE APPLICABLE AGENCIES. THE CONTRACTOR SHALL BE RESPONSIBLE FOR OBTAINING ALL NECESSARY PERMITS AND APPROVALS FROM THE APPLICABLE AGENCIES. THE CONTRACTOR SHALL BE RESPONSIBLE FOR OBTAINING ALL NECESSARY PERMITS AND APPROVALS FROM THE APPLICABLE AGENCIES.

James R. Childers
Architect, Inc.
1015 East Main Street
Ft. Smith, AR 72533
www.jrchilders.com



ADG
1015 East Main Street
Ft. Smith, AR 72533
www.adg.com

Cherokee Nation
CHEROKEE NATION CASINO
1015 East Main Street
Ft. Smith, AR 72533

TAHLEQUAH CASINO
CHEROKEE NATION ENTERTAINMENT
TAHLEQUAH, OKLAHOMA

NO.	DATE	DESCRIPTION
1	10/15/18	ISSUED FOR BIDDING
2	10/15/18	REVISED
3	10/15/18	REVISED
4	10/15/18	REVISED

BID PACKAGE 02
(100% SET)

02/27/18
17-06
C2.02b
UTILITY PLAN INSET

PROPOSED LEGEND

NO.	SYMBOL	COMMON NAME	REMARKS
1	1/2" BERMUDA SOG	1/2" BERMUDA SOG	
2	W/VE STONE LARGE BOLLARD	W/VE STONE LARGE BOLLARD	
3	PURPLE CORNFLOWER	PURPLE CORNFLOWER	
4	EMERSON PRUNELLA	EMERSON PRUNELLA	
5	6 GAL 4 O.C.	6 GAL 4 O.C.	
6	5 GAL 4 O.C.	5 GAL 4 O.C.	
7	5 GAL 3 O.C.	5 GAL 3 O.C.	
8	5 GAL 2 O.C.	5 GAL 2 O.C.	
9	5 GAL 1 O.C.	5 GAL 1 O.C.	
10	5 GAL 0 O.C.	5 GAL 0 O.C.	
11	6" O.C. B&B	6" O.C. B&B	
12	4" O.C. B&B	4" O.C. B&B	
13	2" O.C. B&B	2" O.C. B&B	
14	AS SHOWN	AS SHOWN	
15	AS SHOWN	AS SHOWN	
16	AS SHOWN	AS SHOWN	
17	AS SHOWN	AS SHOWN	
18	AS SHOWN	AS SHOWN	
19	AS SHOWN	AS SHOWN	
20	AS SHOWN	AS SHOWN	
21	AS SHOWN	AS SHOWN	
22	AS SHOWN	AS SHOWN	
23	AS SHOWN	AS SHOWN	
24	AS SHOWN	AS SHOWN	
25	AS SHOWN	AS SHOWN	
26	AS SHOWN	AS SHOWN	
27	AS SHOWN	AS SHOWN	
28	AS SHOWN	AS SHOWN	
29	AS SHOWN	AS SHOWN	
30	AS SHOWN	AS SHOWN	
31	AS SHOWN	AS SHOWN	
32	AS SHOWN	AS SHOWN	
33	AS SHOWN	AS SHOWN	
34	AS SHOWN	AS SHOWN	
35	AS SHOWN	AS SHOWN	
36	AS SHOWN	AS SHOWN	
37	AS SHOWN	AS SHOWN	
38	AS SHOWN	AS SHOWN	
39	AS SHOWN	AS SHOWN	
40	AS SHOWN	AS SHOWN	
41	AS SHOWN	AS SHOWN	
42	AS SHOWN	AS SHOWN	
43	AS SHOWN	AS SHOWN	
44	AS SHOWN	AS SHOWN	
45	AS SHOWN	AS SHOWN	
46	AS SHOWN	AS SHOWN	
47	AS SHOWN	AS SHOWN	
48	AS SHOWN	AS SHOWN	
49	AS SHOWN	AS SHOWN	
50	AS SHOWN	AS SHOWN	
51	AS SHOWN	AS SHOWN	
52	AS SHOWN	AS SHOWN	
53	AS SHOWN	AS SHOWN	
54	AS SHOWN	AS SHOWN	
55	AS SHOWN	AS SHOWN	
56	AS SHOWN	AS SHOWN	
57	AS SHOWN	AS SHOWN	
58	AS SHOWN	AS SHOWN	
59	AS SHOWN	AS SHOWN	
60	AS SHOWN	AS SHOWN	
61	AS SHOWN	AS SHOWN	
62	AS SHOWN	AS SHOWN	
63	AS SHOWN	AS SHOWN	
64	AS SHOWN	AS SHOWN	
65	AS SHOWN	AS SHOWN	
66	AS SHOWN	AS SHOWN	
67	AS SHOWN	AS SHOWN	
68	AS SHOWN	AS SHOWN	
69	AS SHOWN	AS SHOWN	
70	AS SHOWN	AS SHOWN	
71	AS SHOWN	AS SHOWN	
72	AS SHOWN	AS SHOWN	
73	AS SHOWN	AS SHOWN	
74	AS SHOWN	AS SHOWN	
75	AS SHOWN	AS SHOWN	
76	AS SHOWN	AS SHOWN	
77	AS SHOWN	AS SHOWN	
78	AS SHOWN	AS SHOWN	
79	AS SHOWN	AS SHOWN	
80	AS SHOWN	AS SHOWN	
81	AS SHOWN	AS SHOWN	
82	AS SHOWN	AS SHOWN	
83	AS SHOWN	AS SHOWN	
84	AS SHOWN	AS SHOWN	
85	AS SHOWN	AS SHOWN	
86	AS SHOWN	AS SHOWN	
87	AS SHOWN	AS SHOWN	
88	AS SHOWN	AS SHOWN	
89	AS SHOWN	AS SHOWN	
90	AS SHOWN	AS SHOWN	
91	AS SHOWN	AS SHOWN	
92	AS SHOWN	AS SHOWN	
93	AS SHOWN	AS SHOWN	
94	AS SHOWN	AS SHOWN	
95	AS SHOWN	AS SHOWN	
96	AS SHOWN	AS SHOWN	
97	AS SHOWN	AS SHOWN	
98	AS SHOWN	AS SHOWN	
99	AS SHOWN	AS SHOWN	
100	AS SHOWN	AS SHOWN	

LANDSCAPE PLAN NOTES

1. THE CONTRACTOR SHALL FURNISH LABOR, MATERIALS, TOOLS, EQUIPMENT, AND RELATED ITEMS REQUIRED FOR THE COMPLETE INSTALLATION OF LANDSCAPE.
2. ALL PLANT MATERIAL SHALL BE NURSERY GROWN. PLANT MATERIAL SIZES AND GRADING SHALL COMPLY WITH THE STANDARD SPECIFICATIONS FOR NURSERY STOCK PUBLISHED BY THE AMERICAN NURSERY AND LANDSCAPE ASSOCIATION.
3. ALL PLANT MATERIAL SHALL BE HEALTHY AND FREE FROM ALL VISIBLE SIGNS OF DISEASE OR PEST INFESTATION.
4. CONTRACTOR SHALL ASCERTAIN LOCATION OF ALL UTILITIES PRIOR TO EXCAVATION. PRIOR TO EXCAVATION, THE CONTRACTOR SHALL OBTAIN ALL NECESSARY PERMITS FROM THE CITY OF TULSA.
5. ANY CHANGES TO APPROVED PLANT SCHEDULE WILL BE ALLOWED WITHOUT THE APPROVAL OF THE OWNER AND THE OWNER'S REPRESENTATIVE.
6. ALL TREES SHALL BE INSTALLED, MULCHED, GUYED AND STAKED PER THE DETAILS. ALL SHRUBS SHALL BE INSTALLED AND MULCHED PER THE DETAILS.
7. 2-INCH MINIMUM DIAMETER, NATURAL RIVER ROCK MULCH, A MINIMUM OF 2" DEEP SHALL BE APPLIED TO ALL PLANT MATERIAL.
8. WEED BARRIER FABRIC SHALL BE INSTALLED TO ALL PROPOSED BED AREAS, BENEATH RIVER ROCK MULCH AND TO ALL EXISTING BED AREAS TO BE REINSTALLED.
9. THE CONTRACTOR SHALL PROVIDE A MINIMUM WARRANTY FOR ALL PLANT MATERIALS AND INSTALLATION FROM THE DATE OF ACCEPTANCE.
10. THE CONTRACTOR SHALL SPILL ANY EXCESS TOPSOIL LOCATED ON THE SITE THAT IS NOT REQUIRED TO PERFORM LANDSCAPE OPERATIONS. IF SUFFICIENT TOPSOIL IS NOT PRESENT ON SITE, THE CONTRACTOR SHALL PERFORM SOIL TESTS ON THE EXISTING AND IMPORTED TOPSOIL AND APPLY LIME AND FERTILIZERS RECOMMENDED BY THE TESTING AGENCY.
11. ALL PLANT MATERIALS SHALL BE WATERED WITH TWELVE (12) INCHES OF TOPSOIL AND A MINIMUM OF SIX INCHES OF COMPOST FILLED INTO THE BEDS.
12. ALL PROPOSED TREES, SHRUBS, LAWNS AND BEDS ARE TO BE IRRIGATED. IRRIGATION DESIGN TO BE PROVIDED BY IRRIGATION CONTRACTOR USING THE PROVIDED PERFORMANCE SPECIFICATION.
13. ALL SODDED LAWN AREAS ARE TO BE IRRIGATED ON SEPARATE STATIONS AS LANDSCAPE BEDS.
14. ALL DISTURBED AREAS ARE TO BE SODDED AND IRRIGATED.

SODDING NOTE

ALL AREAS TO BE SODDED SHALL BE TOPDRESSED TO A MINIMUM DEPTH OF 4" FERTILIZED AT A RATE OF 250 POUNDS PER ACRE AND SODDED WITH BERMUDA GRASS (SEE THE PLAN FOR LOCATIONS). EDGES OF SOD SHALL BE FINISHED IN A SLOPE THAT IS ABOVE 10%.

IRRIGATION CONTRACTOR SHALL WATER AND MAINTAIN THE GRASS UNTIL A HEALTHY PERMANENT STAND IS ESTABLISHED.

NOTE: HYDRO-CANALS SHALL NOT BE USED.

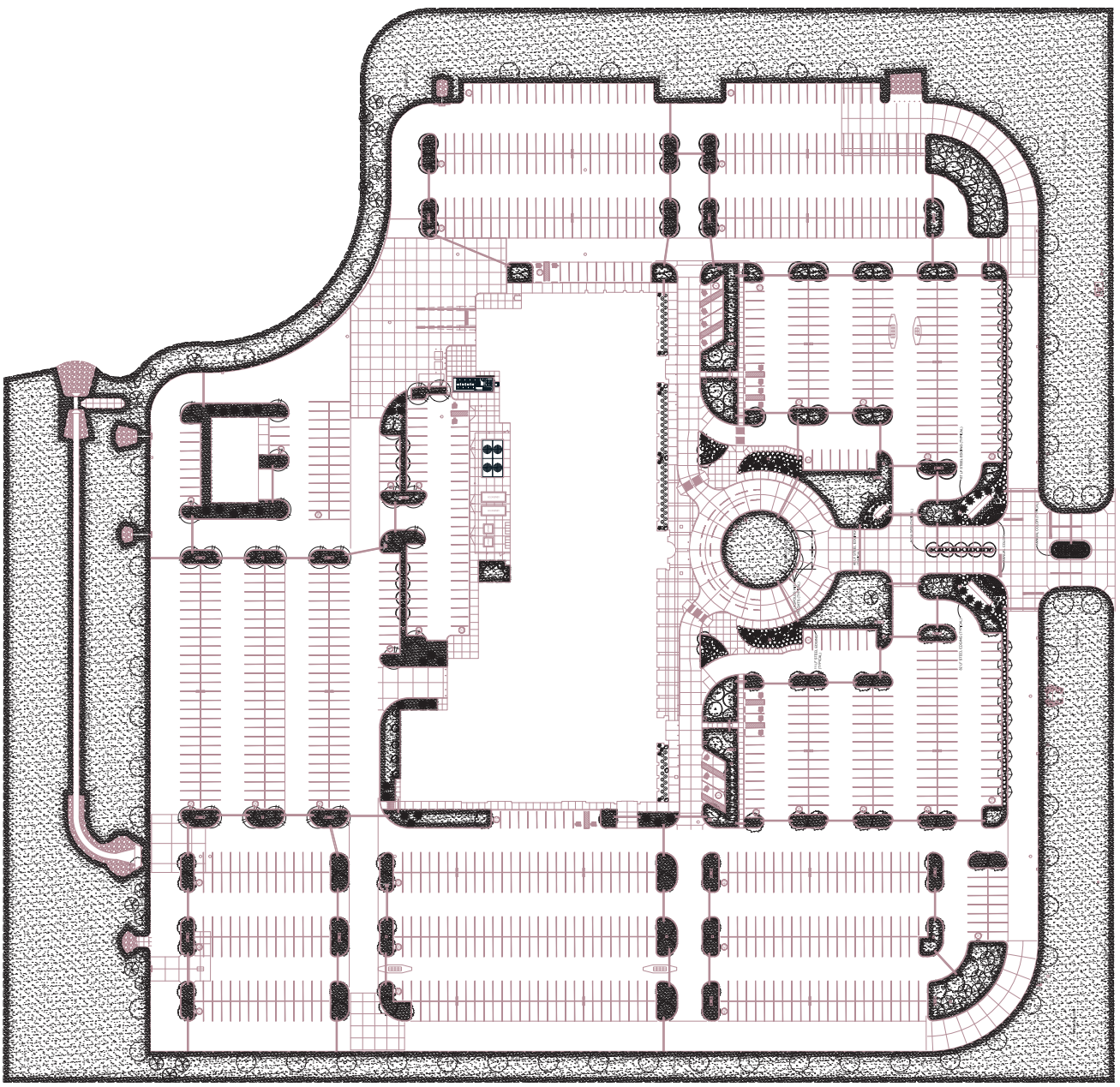
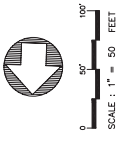

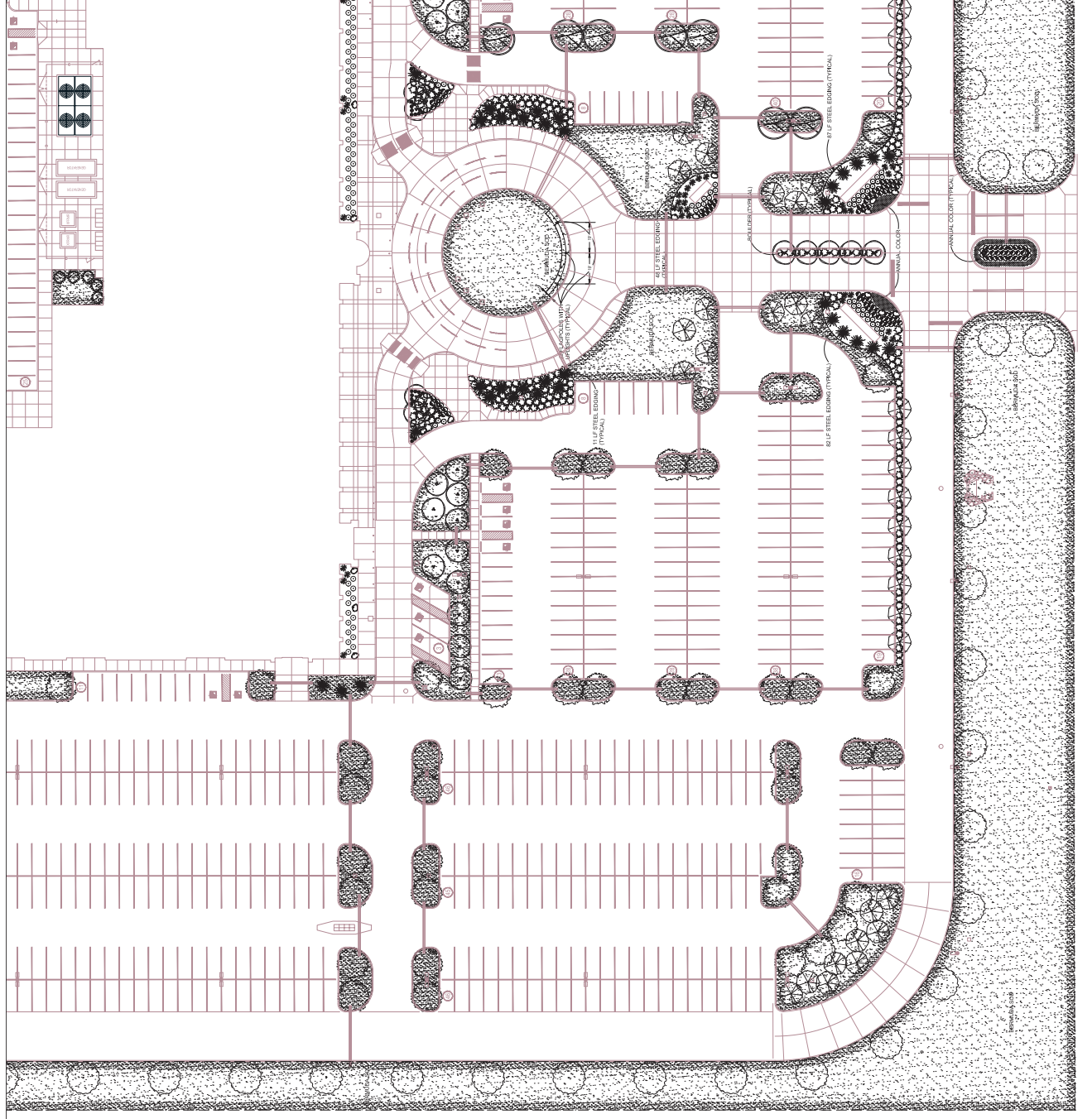

SCHEDULE OF PLANT SPECIES

NO.	SYMBOL	COMMON NAME	REMARKS
38	38-200 3 Y.	1 1/2" BERMUDA SOO	
39	39-200 1 Y.	NATIVE STONE LARGE BOLDUR	
34	34-200 1 Y.	PURPLE CORNER CLOVER	Establish in spring
38	38-200 1 Y.	5 GAL 4" C.C.	Establish in spring
46	46-200 1 Y.	5 GAL 4" C.C.	Establish in spring
80	80-200 1 Y.	5 GAL 4" C.C.	Establish in spring
90	90-200 1 Y.	5 GAL 4" C.C.	Establish in spring
232	232-200 1 Y.	5 GAL 4" C.C.	Establish in spring
59	59-200 1 Y.	5 GAL 4" C.C.	Establish in spring
40	40-200 1 Y.	5 GAL 4" C.C.	Establish in spring
73	73-200 1 Y.	5 GAL 4" C.C.	Establish in spring
38	38-200 1 Y.	5 GAL 4" C.C.	Establish in spring
60	60-200 1 Y.	5 GAL 4" C.C.	Establish in spring
62	62-200 1 Y.	5 GAL 4" C.C.	Establish in spring
34	34-200 1 Y.	5 GAL 4" C.C.	Establish in spring

LANDSCAPE PLAN NOTE:

- THE CONTRACTOR SHALL FURNISH ALL LABOR, MATERIALS, TOOLS, EQUIPMENT, AND RELATED ITEMS REQUIRED FOR THE COMPLETE INSTALLATION OF LANDSCAPE.
- ALL PLANTING SHALL BE DONE IN ACCORDANCE WITH THE LATEST EDITION OF THE STANDARD SPECIFICATIONS FOR NURSERY STOCK, PUBLISHED BY THE AMERICAN NURSERY AND LANDSCAPE ASSOCIATION.
- ALL PLANT MATERIAL SHALL BE HEALTHY AND FREE FROM ALL VISIBLE SIGNS OF DISEASE OR PEST INFESTATION. ALL AGENT AND/OR PESTS SHALL BE TREATED PRIOR TO DELIVERY. PRIOR TO COMMENCING ANY WORK, CONTACT 1-800-552-6243.
- NO CHANGES TO APPROVED PLANT SCHEDULE WILL BE ALLOWED WITHOUT THE APPROVAL OF THE OWNER AND THE OWNER'S REPRESENTATIVE.
- ALL TREES SHALL BE INSTALLED, MAINTAINED, AND WATERED FOR ONE YEAR PRIOR TO DELIVERY. ALL SHRUBS SHALL BE INSTALLED, MAINTAINED, AND WATERED FOR ONE YEAR PRIOR TO DELIVERY.
- ALL PLANTING BEDS SHALL BE REMOVED IN FULLY AND SOIL SHALL BE REMOVED WITH 12" OF TOPSOIL. ALL PLANTING BEDS SHALL BE REGRADED AND SOIL SHALL BE RECOMPACTED TO THE ORIGINAL DESIGN SPECIFICATION.
- ALL DISTURBED AREAS SHALL BE REGRADED AND SOIL SHALL BE RECOMPACTED TO THE ORIGINAL DESIGN SPECIFICATION.
- ALL DISTURBED AREAS SHALL BE REGRADED AND SOIL SHALL BE RECOMPACTED TO THE ORIGINAL DESIGN SPECIFICATION.
- ALL DISTURBED AREAS SHALL BE REGRADED AND SOIL SHALL BE RECOMPACTED TO THE ORIGINAL DESIGN SPECIFICATION.
- ALL DISTURBED AREAS SHALL BE REGRADED AND SOIL SHALL BE RECOMPACTED TO THE ORIGINAL DESIGN SPECIFICATION.
- ALL DISTURBED AREAS SHALL BE REGRADED AND SOIL SHALL BE RECOMPACTED TO THE ORIGINAL DESIGN SPECIFICATION.
- ALL DISTURBED AREAS SHALL BE REGRADED AND SOIL SHALL BE RECOMPACTED TO THE ORIGINAL DESIGN SPECIFICATION.
- ALL DISTURBED AREAS SHALL BE REGRADED AND SOIL SHALL BE RECOMPACTED TO THE ORIGINAL DESIGN SPECIFICATION.
- ALL DISTURBED AREAS SHALL BE REGRADED AND SOIL SHALL BE RECOMPACTED TO THE ORIGINAL DESIGN SPECIFICATION.
- ALL DISTURBED AREAS SHALL BE REGRADED AND SOIL SHALL BE RECOMPACTED TO THE ORIGINAL DESIGN SPECIFICATION.

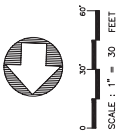

BEFORE DRAINAGE
 NOTE: HYDRO-SALCH WILL NOT BE USED.

SCHEDULE SPECIFICATIONS

NO.	QUANTITY	SYMBOL	COMMON NAME	COMMENTS
30	30	○	NATIVE BETON LAKE BOUNDER	2 1/2" DIAMETER
34	24	●	PURPLE CORNFLOWER	1 GAL 2" O.C.
38	38	●	GRASS PANSIES	5 GAL 4" O.C.
46	46	●	HELLER HOLLY	5 GAL 4" O.C.
80	80	○	AUTUMN SANGRE ENCOCHE SAGEA	5 GAL 4" O.C.
90	90	○	ROSEMOOR ROSE	5 GAL 4" O.C.
332	332	○	BLUE PANTIC JAMBIR	5 GAL 4" O.C.
59	59	○	BLUE ATLANTIC CEDAR	16" DIAM
40	40	○	CORA ALBISIA 'SUNSHINE'	AS SHOWN
41	41	○	LEUCOPHYLLON 'SUNSHINE'	AS SHOWN
71	71	○	CORONADO PRINCESS DOGWOOD	AS SHOWN
38	38	○	CORA BRIDE 'Y' CREWELL PRINCESS	AS SHOWN
60	60	○	OUTDOOR POLYURETHANE	AS SHOWN
62	62	○	OUTDOOR POLYURETHANE	AS SHOWN
34	34	○	AUTUMN FLAME MAPLE	7" CAL. DBH
			Ash Hybrid 'Nimbus' Form	AS SHOWN

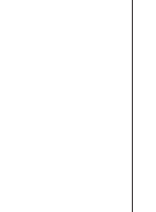
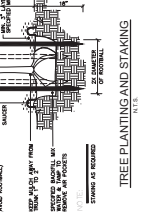
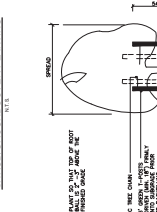
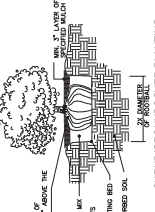
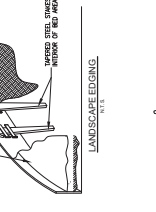
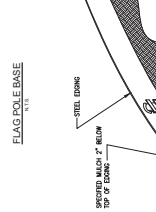
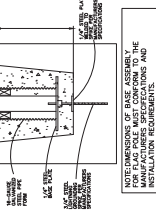
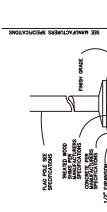

LANDSCAPE PLAN NOTES:

1. THE CONTRACTOR SHALL FURNISH LABOR, MATERIALS, TOOLS, EQUIPMENT, AND RELATED ITEMS REQUIRED FOR THE COMPLETE INSTALLATION OF LANDSCAPE.
2. ALL PLANT MATERIAL SHALL BE NURSERY GROWN. PLANT MATERIAL SIZES AND GRADING SHALL COMPLY WITH THE STANDARDS FOR NURSERY STOCK PUBLISHED BY THE AMERICAN NURSERY AND LANDSCAPE ASSOCIATION.
3. ALL PLANT MATERIAL SHALL BE HEALTHY AND FREE FROM ALL VISIBLE SIGNS OF DISEASE OR PEST INFESTATION.
4. CONTRACTOR SHALL ASCERTAIN LOCATION OF ALL UTILITIES PRIOR TO DEDICATION. PRIOR TO ANY EXCAVATION, THE CONTRACTOR SHALL OBTAIN ALL NECESSARY PERMITS FROM THE CITY OF FORT WORTH AND THE OWNER'S REPRESENTATIVE. SCHEDULE SHALL BE ALLOWED WITHOUT THE APPROVAL OF THE OWNER.
5. ALL CHANGES TO APPROVED PLANT SCHEDULE WILL BE ALLOWED WITHOUT THE APPROVAL OF THE OWNER AND THE OWNER'S REPRESENTATIVE.
6. ALL TREES SHALL BE INSTALLED MULCHED, GUIDED AND STAKED PER THE DETAILS. ALL SHRUBS SHALL BE INSTALLED AND MULCHED PER THE DETAILS.
7. 2-INCH MINIMUM DIAMETER NATURAL RIVER ROCK MULCH, A MINIMUM OF 2" DEEP SHALL BE APPLIED TO ALL PLANT MATERIAL.
8. WEED BARRIER FABRIC SHALL BE INSTALLED TO ALL PROPOSED BED AREAS BENEATH RIVER ROCK MULCH.
9. ALL PLANT MATERIAL SHALL BE INSTALLED WITH A MINIMUM WARRANTY FOR ALL PLANT MATERIALS AND NOT FALLING FROM THE DATE OF ACCEPTANCE.
10. THE CONTRACTOR SHALL SPILL ANY EXCESS TOPSOIL LOCATED ON THE SITE THAT IS NOT REQUIRED TO PERFORM LANDSCAPE OPERATIONS. IF SUFFICIENT TOPSOIL IS NOT PRESENT ON SITE, THE CONTRACTOR SHALL FURNISH SUFFICIENT TOPSOIL TO PERFORM LANDSCAPE OPERATIONS. THE CONTRACTOR SHALL PERFORM A SOIL TEST ON THE EXISTING AND IMPORTED TOPSOIL AND APPLY LIME AND FERTILIZERS RECOMMENDED BY THE TESTING AGENCY.
11. ALL PLANT MATERIALS SHALL BE WATERED WITH TWELVE (12) INCHES OF TOPSOIL AND A MINIMUM OF SIX INCHES OF COMPOST FILLED INTO THE BEDS.
12. ALL PROPOSED TREES, SHRUBS, LAWNS AND BEDS ARE TO BE IRRIGATED. IRRIGATION DESIGN TO BE PROVIDED BY IRRIGATION CONTRACTOR USING THE PROVIDED PERFORMANCE SPECIFICATION.
13. ALL SOODED LAWN AREAS ARE TO BE IRRIGATED ON SEPARATE STATIONS AS LANDSCAPE BEDS.
14. ALL DISTURBED AREAS ARE TO BE SOODED AND IRRIGATED.

SOODING NOTE:

1. ALL AREAS TO BE SOODED SHALL BE TOLERATED TO A MINIMUM DEPTH OF 4" FERTILIZED AT A RATE OF 200 POUNDS PER ACRE AND SOODED WITH BERAMDA GRASS (SEE THE PLAN FOR LOCATIONS). EDGES OF SOOD SHALL BE FINISHED & LOCATED ON A SLOPE THAT IS ABOVE 10%.
2. IRRIGATION CONTRACTOR SHALL WATER AND MAINTAIN THE GRASS UNTIL A HEALTHY PERMANENT STAND IS ESTABLISHED.

NOTE: HYDRO-CANALS WILL NOT BE USED.



SCALE: 1" = 30 FEET

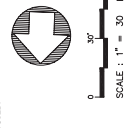

SCHEDULE OF PLANT SPECIFICATIONS

NO.	QUANTITY	SYMBOL	COMMON NAME	SCIENTIFIC NAME	REMARKS
38	200	38	1/2" BERMUDA SOO		
39	30	39	NATIVE STONE LARGE BOUNDER		2" TWAY TER
40	24	40	PURPLE CORNER LOWER		10x4 2" OC
41	38	41	HELLER HOLLY		5.0x4 4" OC
42	46	42	ATLANTIC SANDWICH PLANT		5.0x4 4" OC
43	80	43	ATLANTIC SANDWICH PLANT		5.0x4 4" OC
44	60	44	ATLANTIC SANDWICH PLANT		5.0x4 4" OC
45	33	45	ATLANTIC SANDWICH PLANT		5.0x4 4" OC
46	59	46	ATLANTIC SANDWICH PLANT		5.0x4 4" OC
47	40	47	ATLANTIC SANDWICH PLANT		5.0x4 4" OC
48	73	48	ATLANTIC SANDWICH PLANT		5.0x4 4" OC
49	38	49	ATLANTIC SANDWICH PLANT		5.0x4 4" OC
50	60	50	ATLANTIC SANDWICH PLANT		5.0x4 4" OC
51	62	51	ATLANTIC SANDWICH PLANT		5.0x4 4" OC
52	34	52	ATLANTIC SANDWICH PLANT		5.0x4 4" OC

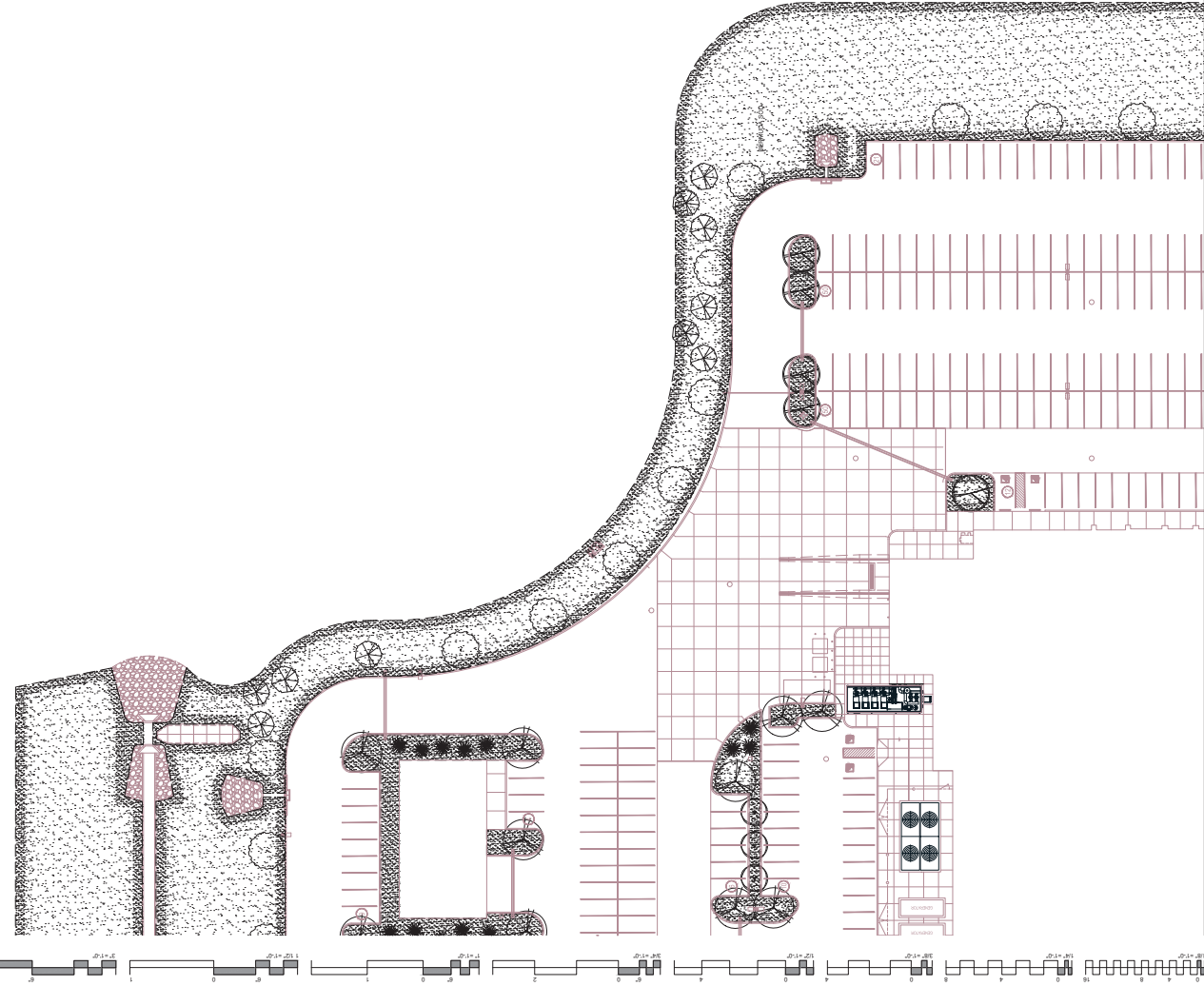
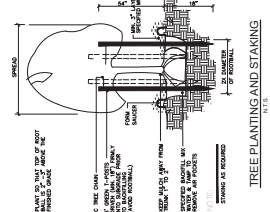
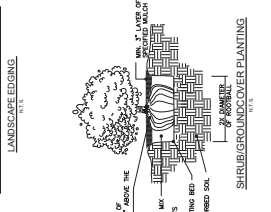
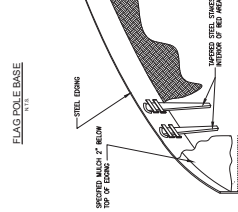
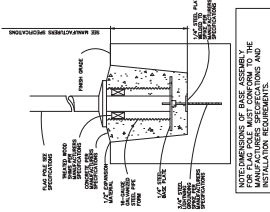

LANDSCAPE PLAN NOTE:

- THE CONTRACTOR SHALL FURNISH ALL LABOR, MATERIALS, TOOLS, EQUIPMENT, AND RELATED ITEMS REQUIRED FOR THE COMPLETE INSTALLATION OF LANDSCAPE.
- THE CONTRACTOR SHALL OBTAIN ALL NECESSARY PERMITS AND APPROVALS FROM THE CITY OF TALEQUAH, OKLAHOMA, AND THE STATE OF OKLAHOMA, PRIOR TO COMMENCING WORK.
- ALL PLANT MATERIAL SHALL BE HEALTHY AND FREE FROM ALL VISIBLE SIGNS OF DISEASE OR PEST INFESTATION. ALL PLANT MATERIAL SHALL BE OBTAINED FROM A REPUTABLE NURSERY OR PROPAGATOR. THE CONTRACTOR SHALL OBTAIN ALL NECESSARY PERMITS AND APPROVALS FROM THE CITY OF TALEQUAH, OKLAHOMA, AND THE STATE OF OKLAHOMA, PRIOR TO COMMENCING WORK.
- NO CHANGES TO APPROVED PLANT SCHEDULE WILL BE ALLOWED WITHOUT THE APPROVAL OF THE OWNER AND THE OWNER'S REPRESENTATIVE.
- ALL TREES SHALL BE INSTALLED, MAINTAINED, AND WATERED PER THE DETAILS. ALL SHRUBS SHALL BE INSTALLED, MAINTAINED, AND WATERED PER THE DETAILS.
- ALL PLANTING BEDS SHALL BE REMOVED IN FULLY AND SOIL SHALL BE REMOVED WITH THE CONTRACTOR. THE CONTRACTOR SHALL PROVIDE A MINIMUM OF 2" DEEP MULCH TO ALL PLANTING BEDS SHOWN ON THIS PLAN.
- ALL SOILED LANE AREAS ARE TO BE IRRIGATED ON SEPARATE STATIONS AS LANDSCAPE SPECIFICATION.
- ALL DISTURBED AREAS TO BE SOODED AND IRRIGATED.

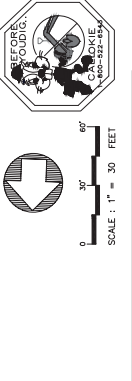

NOTE: HYDRO-MULCH WILL NOT BE USED.

SCHEDULE OF PLANT SPECIFICATIONS

NO.	QUANTITY	SYMBOL	COMMON NAME	SCIENTIFIC NAME	REMARKS
38	2000 S.Y.		1/2" BERMUDA SOO	<i>Cynodon dactylon</i>	
39	30		NATIVE STONE LARGE BOLLER	<i>Quercus macrocarpa</i>	2" DBH MIN
40	34		PIPERL CORNER LOWER	<i>Quercus prinus</i>	1" CAL. 2" O.C.
41	38		5 GAL 4" O.C.	<i>Quercus prinus</i>	5 GAL 4" O.C.
42	45		5 GAL 8" O.C.	<i>Quercus prinus</i>	5 GAL 8" O.C.
43	80		5 GAL 4" O.C.	<i>Quercus prinus</i>	5 GAL 4" O.C.
44	105		5 GAL 8" O.C.	<i>Quercus prinus</i>	5 GAL 8" O.C.
45	232		5 GAL 4" O.C.	<i>Quercus prinus</i>	5 GAL 4" O.C.
46	59		W/17 800	<i>Quercus prinus</i>	W/17 800
47	40		AS 30 20 00	<i>Quercus prinus</i>	AS 30 20 00
48	73		AS 30 20 00	<i>Quercus prinus</i>	AS 30 20 00
49	38		AS 30 20 00	<i>Quercus prinus</i>	AS 30 20 00
50	60		AS 30 20 00	<i>Quercus prinus</i>	AS 30 20 00
51	62		AS 30 20 00	<i>Quercus prinus</i>	AS 30 20 00
52	34		AS 30 20 00	<i>Quercus prinus</i>	AS 30 20 00

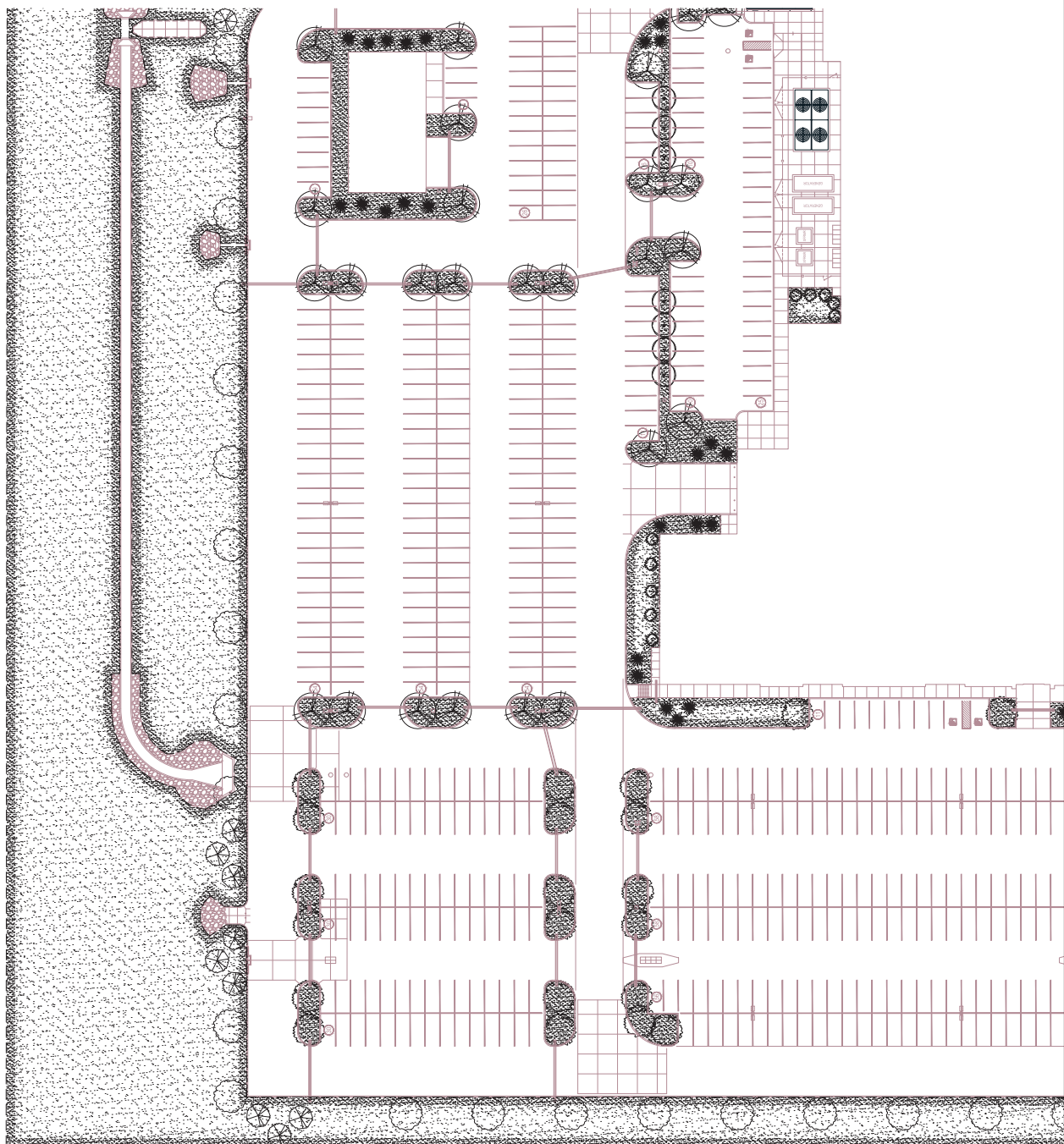

LANDSCAPE PLAN NOTES:

1. THE CONTRACTOR SHALL FURNISH ALL LABOR, MATERIALS, TOOLS, EQUIPMENT, AND REPAIRS REQUIRED FOR THE COMPLETE INSTALLATION OF LANDSCAPE.
2. ALL PLANT MATERIALS SHALL BE HEALTHY AND FREE FROM ALL VISIBLE SIGNS OF DISEASE OR WEEDS.
3. ALL PLANT MATERIAL SHALL BE HEALTHY AND FREE FROM ALL VISIBLE SIGNS OF DISEASE OR WEEDS.
4. CONTRACTOR SHALL ASSESS THE LOCATION OF ALL UTILITIES PRIOR TO INSTALLATION. PRIOR TO COMMENCING WITH ANY WORK, CONTACT 1-800-522-6243.
5. NO CHANGES TO APPROVED PLANT SCHEDULE WILL BE ALLOWED WITHOUT THE APPROVAL OF THE OWNER AND THE OWNER'S REPRESENTATIVE.
6. ALL TREES SHALL BE INSTALLED MATCHED, GATED AND SWIDED PER THE DETAILS. ALL PLANT MATERIAL SHALL BE INSTALLED WITH A MINIMUM OF 2" GROUND COVER.
7. 3" MINIMUM DIAMETER NATURAL RUBBER ROCK BOLLER, A MINIMUM OF 2" DEEP, SHALL BE APPLIED TO ALL PLANTING BEDS SHOWN ON THIS PLAN.
8. WEED BARRIER FABRIC SHALL BE INSTALLED TO ALL PROPOSED BED AREAS, BENEATH RIVER ROCK MULCH.
9. THE CONTRACTOR SHALL PROVIDE A ONE-YEAR WARRANTY FOR ALL PLANT MATERIALS.
10. THE CONTRACTOR SHALL SOAK ANY EXCESS TOPSOIL LOCATED ON THE SITE THAT IS NOT REQUIRED TO PERFORM LANDSCAPE OPERATIONS. IF SUFFICIENT TOPSOIL IS NOT PRESENT ON THE SITE, THE CONTRACTOR SHALL SOAK ANY EXCESS TOPSOIL ON THE EXISTING AND ADJACENT TOPSOIL AND APPLY LIME AND FERTILIZER AS RECOMMENDED BY THE TESTING LABORATORY.
11. IN ALL PLANTING BEDS, SOO SHALL BE REMOVED ENTIRELY AND SOO SHALL BE AMENDED WITH TWELVE INCHES OF TOPSOIL AND A MINIMUM OF SIX INCHES OF COMPOST FILLED INTO THE BEDS.
12. ALL PROPOSED TREES, SHRUBS, LAWN AND BEDS ARE TO BE IRRIGATED. IRRIGATION DESIGN SHALL BE PROVIDED BY IRRIGATION CONTRACTOR USING THE PROVIDED PERFORMANCE SPECIFICATION.
13. ALL SOOED LAWN AREAS ARE TO BE IRRIGATED ON SEPARATE STATIONS AS LANDSCAPE BEDS.
14. ALL DISTURBED AREAS TO BE SOOED AND IRRIGATED.

SOOING NOTE:

ALL AREAS TO BE SOOED SHALL BE TORPED TO A MINIMUM DEPTH OF 4" FERTILIZED AT A RATE OF 20 POUNDS PER ACRE AND SOOED WITH BERMUDA GRASS (SEE THE PLANT FOR LOCATIONS). EDGES OF SOO SHALL BE FINISHED ON A SLOPE THAT IS ABOVE 15%.

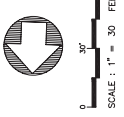

NOTE: HYDROCAL WALL NOT TO BE USED.

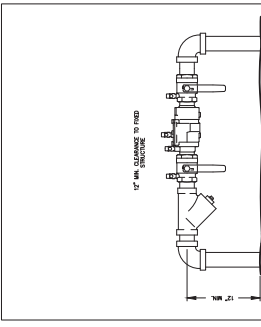

DOUBLE CHECK VALVE ASSEMBLY

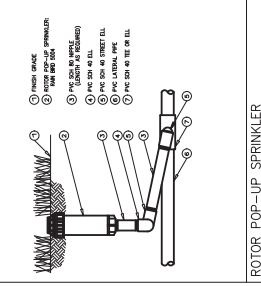
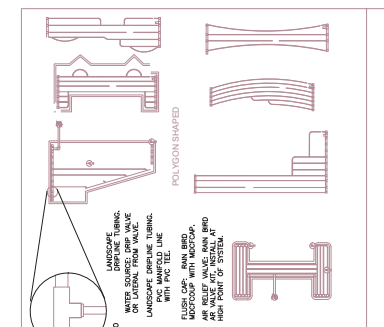
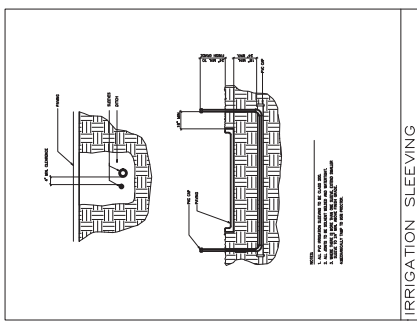

ROTOR POP-UP SPRINKLER

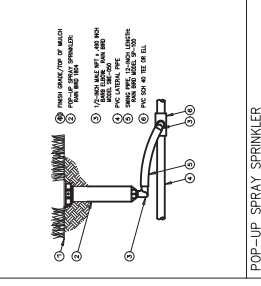
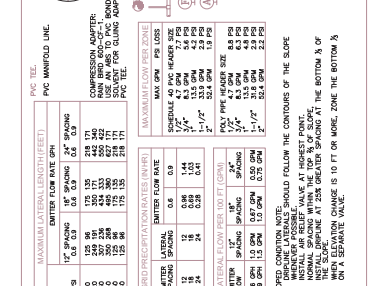
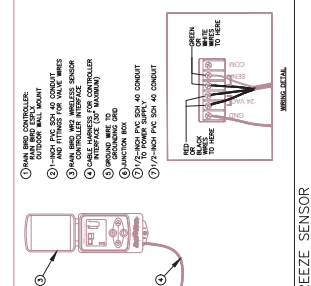

POP-UP SPRAY SPRINKLER

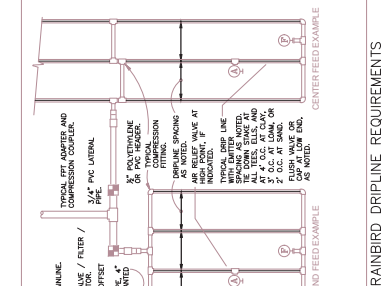
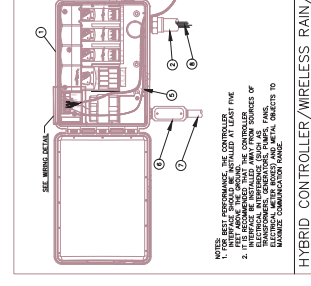

IRRIGATION NOTES

1. THE IRRIGATION CONTRACTOR MUST HAVE ON ITS STAFF AN OKLAHOMA LICENSED IRRIGATOR.
2. CONTRACTOR TO CONTACT PROPER AUTHORITIES AND LOCATE ALL UTILITIES PRIOR TO CONSTRUCTION.
3. COORDINATE IRRIGATION INSTALLATION WITH PLANTING PLAN AND SITE CONDITIONS TO PROVIDE COMPLETE COVERAGE WITH MINIMUM OVERLAP. ACTUAL LAYOUT OF PIPING, SPRINKLER HEADS, VALVES, CONTROLLER, AND RELATED EQUIPMENT SHALL BE DETERMINED ON-SITE.
4. IT IS THE RESPONSIBILITY OF THE IRRIGATION CONTRACTOR TO FAMILIAR WITH ALL GRADE DIFFERENCES, LOCATIONS OF WALLS, STRUCTURES AND UTILITIES AND MAKE THE NECESSARY ADJUSTMENTS TO ACCOMMODATE THE IRRIGATION SYSTEM.
5. THE IRRIGATION CONTRACTOR WILL SECURE ALL REQUIRED PERMITS AND PAY ALL ASSOCIATED FEES UNLESS OTHERWISE NOTED. ALL LOCAL CODES SHALL PREVAIL OVER ANY DISCREPANCIES HEREIN.
6. ALL WORK SHALL BE INSTALLED IN ACCORDANCE WITH APPLICABLE CODES AND ORDINANCES AS PER LOCAL AND GOVERNING AUTHORITIES AND THE NATIONAL ELECTRICAL CODE AND ITS GOVERNING AUTHORITIES.
7. AT LEAST SEVEN DAYS BEFORE BEGINNING WORK, CONFIRM THE STATIC WATER PRESSURE IS AT LEAST 60 PSI.
8. COORDINATE WITH THE GENERAL CONTRACTOR THE LOCATION OF THE AUTOMATIC CONTROLLER, AND THE INCH SCHEDULE 40 SLEEVE LEADING TO IT.
9. THE GENERAL CONTRACTOR WILL PROVIDE 120V-AC POWER SOURCE AT THE CONTROLLER LOCATION. THE IRRIGATION CONTRACTOR WILL MAKE THE FINAL CONNECTION FROM THE ELECTRICAL SOURCE TO THE CONTROLLER.
10. A RAIN SENSOR WILL BE INSTALLED IN THE VICINITY OF THE CONTROLLER - COORDINATE LOCATION WITH THE GENERAL CONTRACTOR. IT IS THE RESPONSIBILITY OF THE IRRIGATION CONTRACTOR TO INSURE THE RAIN SENSOR IS PLACED IN A LOCATION WHERE IT CAN RECEIVE SUFFICIENT RAINFALL TO OPERATE PROPERLY. THE IRRIGATION CONTRACTOR MAY BE REQUIRED TO RELOCATE IT AT NO ADDITIONAL COST TO THE OWNER.
11. 24 HOUR VALVE WIRES SHALL BE A MINIMUM OF 14 GAUGE (1/8" APPROX) FOR BRIDGE BURIAL. SINGLE CONDUCTOR IRRIGATION WIRE - EACH CONTROLLER TO HAVE A DIFFERENT COLOR STATION AND COMMON WIRE. TWO (2) SPARE GROUND WIRES SHALL BE INSTALLED FROM:
 - * COMMON WIRE - WHITE
 - * EXTRA COMMON WIRES - BLUE
12. WIRE SPLICES SHALL BE ENCASED IN A WATERPROOF COMPOUND OR GEL. ALL FIELD SPLICES SHALL BE LOCATED IN A 6 INCH ROUND VALVE BOX.
13. EACH VALVE TO RECEIVE A PRE-MANUFACTURED, NUMBERED WATERPROOF TAG. THIS NUMBER TO CORRESPOND TO ITS VALVE SEQUENCE OF OPERATION ON THE CONTROLLER.
14. VALVE BOXES SHALL BE INSTALLED FLUSH WITH THE GRADE, WITH 3 INCHES OF CLEAN RAIN GRAVEL LOCATED BELOW THE VALVE. USE 10 INCH RAIN DRAIN VALVE BOXES FOR ELECTRIC VALVES AND QUICK COUPLING VALVES.
15. USE SCHEDULE 40 RIGID PVC SWING JOINTS WITH MARLEX 90 DEGREE ELBS FOR ALL QUICK COUPLER CONNECTIONS.
16. ALL SPRINKLER HEADS SHALL BE SET PERPENDICULAR TO FINISH GRADE UNLESS OTHERWISE SPECIFIED.
17. THE IRRIGATION CONTRACTOR SHALL FLUSH AND ADJUST ALL SPRINKLER HEADS AND VALVES FOR OPTIMUM COVERAGE WITH MINIMAL OVERSPRAY ONTO WALKS, STREETS, WALLS, ETC.
18. ALL SPRAY HEADS SHALL BE CONNECTED WITH A 1/2 INCH MINIMUM LENGTH OF 1/2 INCH FLEX PVC. THE FLEX PVC SHALL BE SOLVENT WELDED TO SCHEDULE 40 PVC FITTINGS WITH WELDED #95 SOLVENT AND #9-70 PRIMER.
19. INSTALL THE BACKFLOW PREVENTER IN A LOCATION SO IT WILL BE CONCEALED FROM PUBLIC VIEW (IE. WITHIN A HEDGE ROW).
20. LATERAL PIPE SHALL BE INSTALLED AT A MINIMUM DEPTH OF 12 INCHES. MAINLINE PIPE AND WIRES SHALL BE INSTALLED AT A MINIMUM DEPTH OF 18 INCHES.
21. ALL SPRINKLER HEADS SHALL BE SET PERPENDICULAR AND FLUSH TO FINISH GRADE AND WITH A CLEARANCE OF TWO INCHES (MINIMUM) FROM THE EDGE OF ANY HARDSCAPE UNLESS OTHERWISE SPECIFIED.
22. ALL SPRINKLER HEADS AND VALVES SHALL BE FLUSHED AND ADJUSTED FOR OPTIMUM COVERAGE WITH MINIMUM OVERSPRAY ON WALKS, STREETS, WALLS, ETC.
23. ALL IRRIGATION EQUIPMENT NOT OTHERWISE DETAILED OR SPECIFIED SHALL BE INSTALLED AS PER MANUFACTURER'S RECOMMENDATIONS AND SPECIFICATIONS.
24. CONTRACTOR SHALL NOT DISTURB ROOTS OF EXISTING TREES. THERE SHALL BE NO MACHINE TRACING BELOW THE DRIPLINE OF EXISTING TREES.
25. CLEAN UP DURING IRRIGATION PREPARATION AND INSTALLATION. KEEP ALL PAVEMENT CLEAN AND ALL WORK AREAS IN A NEAT, ORDERLY CONDITION. ALL EXCAVATED MATERIALS NOT USED IN BACKFILL WILL BE DISPOSED OF LEGALLY OFF THE PROJECT SITE.
26. THE IRRIGATION CONTRACTOR SHALL MAINTAIN A COPIED COPY OF THE IRRIGATION LAYOUT AND BE ABLE TO IDENTIFY THE CONTROLLERS COVER TO DISPLAY WHICH VALVES COVER WHICH AREAS AND WHAT ZONE NUMBER THAT THE RESPECTIVE VALVES.
27. TURN THE FOLLOWING ITEMS IN TO THE OWNER UPON COMPLETION OF THE INSTALLATION:
 - a) 1/2" QUICK COUPLER KEYS
 - b) 1) CONTROLLER MANUAL
 - c) 1) IRRIGATION SYSTEM AS-BUILTS (AS MANY COPIES AS REQUESTED) DETAILING ACTUAL FIELD LOCATIONS OF MAJOR IRRIGATION COMPONENTS AS WELL AS WIRE SPICE BOXES.
28. WARRANTY: THE IRRIGATION SYSTEM SUPPLIED AND INSTALLED SHALL BE WARRANTED (LABOR AND MATERIALS) TO REMAIN OPERATIONAL FOR A PERIOD OF 12 MONTHS AFTER THE DATE OF FINAL ACCEPTANCE. BY THE END OF THE WARRANTY PERIOD, ANY IRRIGATION PART THAT IS DEFECTIVE OR DAMAGED BY THE IRRIGATION CONTRACTOR SHALL BE REPAIRED OR REPLACED AT THE IRRIGATION CONTRACTOR'S EXPENSE AND SHALL BE REPLACED. REPLACEMENTS SHALL BE OF THE SAME KIND AS SPECIFIED IN THE IRRIGATION LEGEND, AND SHALL BE INSTALLED AS ORIGINALLY SPECIFIED. IRRIGATION PARTS DAMAGED OR IMPAIRED DUE TO ACTS OF GOD, VANDALISM, AND/OR THE OWNER'S IMPROPER MAINTENANCE SHALL NOT BE COVERED BY THIS WARRANTY.





James R. Childers Architect, Inc.
 107 South Ave. 27th Fl.
 Tallahassee, FL 32301
 www.jrchilders.com

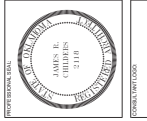

CHEROKEE NATION ENTERTAINMENT
 TAHEQUAH CASINO
 TAHEQUAH, OKLAHOMA

NO.	DATE	DESCRIPTION
1	07/13/18	ISSUED FOR PERMITS
2	07/13/18	ISSUED FOR PERMITS
3	07/13/18	ISSUED FOR PERMITS
4	07/13/18	ISSUED FOR PERMITS
5	07/13/18	ISSUED FOR PERMITS
6	07/13/18	ISSUED FOR PERMITS
7	07/13/18	ISSUED FOR PERMITS
8	07/13/18	ISSUED FOR PERMITS
9	07/13/18	ISSUED FOR PERMITS
10	07/13/18	ISSUED FOR PERMITS
11	07/13/18	ISSUED FOR PERMITS
12	07/13/18	ISSUED FOR PERMITS
13	07/13/18	ISSUED FOR PERMITS
14	07/13/18	ISSUED FOR PERMITS
15	07/13/18	ISSUED FOR PERMITS
16	07/13/18	ISSUED FOR PERMITS
17	07/13/18	ISSUED FOR PERMITS
18	07/13/18	ISSUED FOR PERMITS
19	07/13/18	ISSUED FOR PERMITS
20	07/13/18	ISSUED FOR PERMITS

DATE: 07/13/18
 DRAWN BY: JTC
 PROJECT: CHEROKEE NATION ENTERTAINMENT TAHEQUAH CASINO
 SHEET: LOW VOLTAGE CONDUIT PLAN
 AREA 1

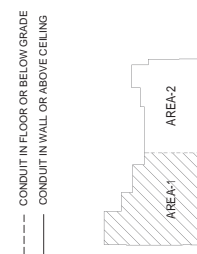
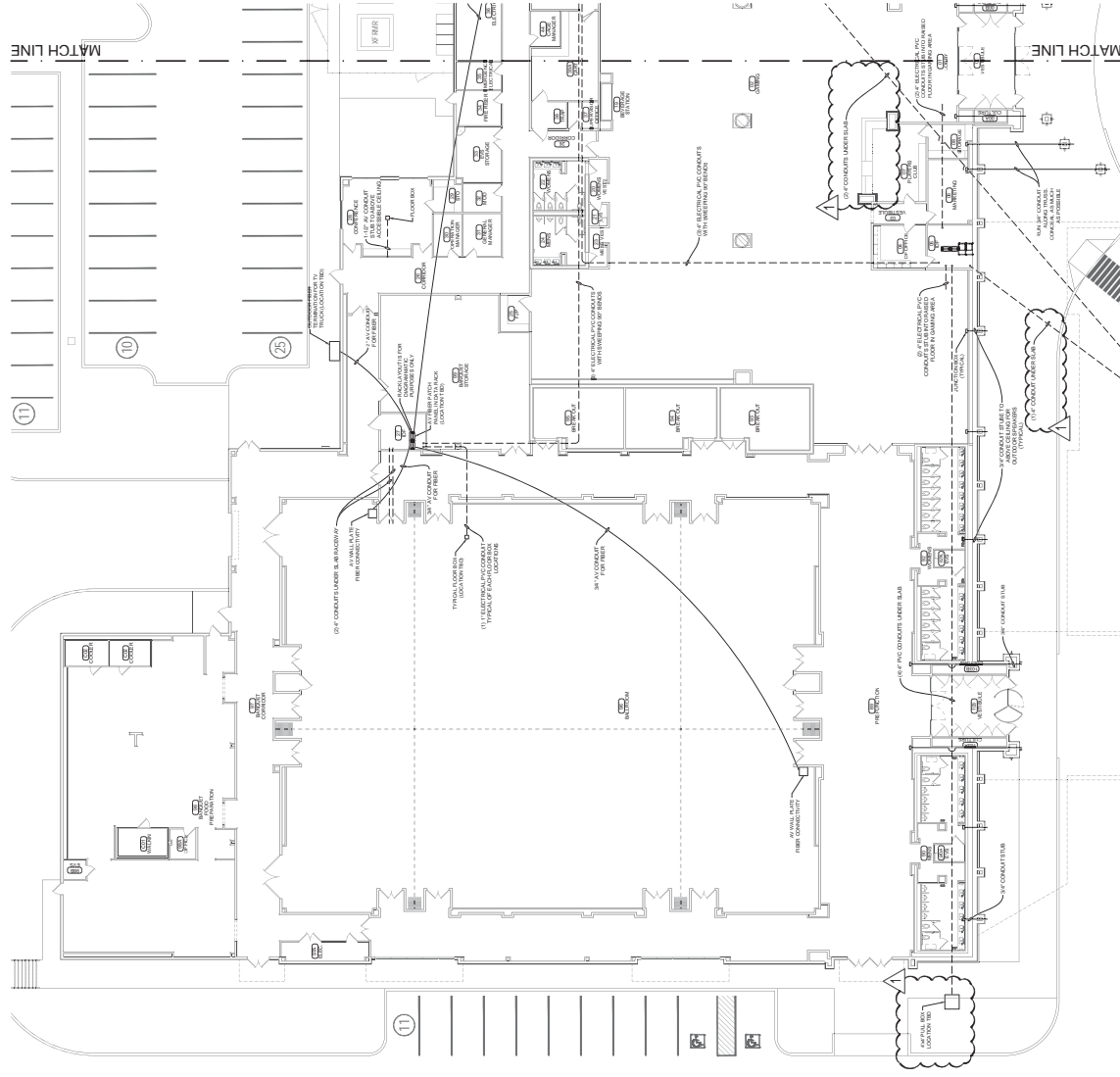

LOW VOLTAGE CONDUIT PLAN
 1/18 = 1'-0"

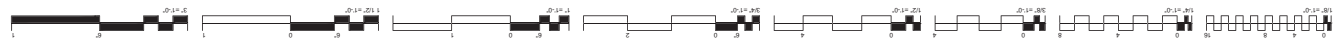

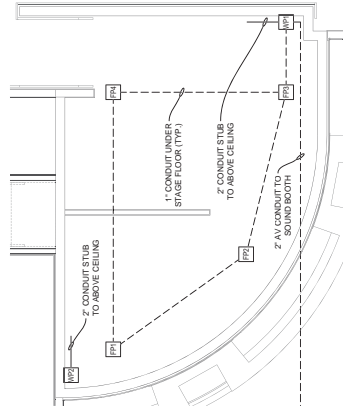

ENLARGED STAGE CONDUIT PLAN
1/4" = 1'-0"

--- CONDUIT IN FLOOR OR BELOW GRADE
- - - CONDUIT IN WALL OR ABOVE CEILING

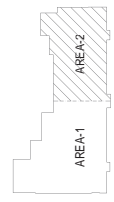

LOW VOLTAGE CONDUIT PLAN
1/8" = 1'-0"

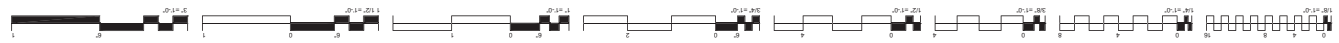
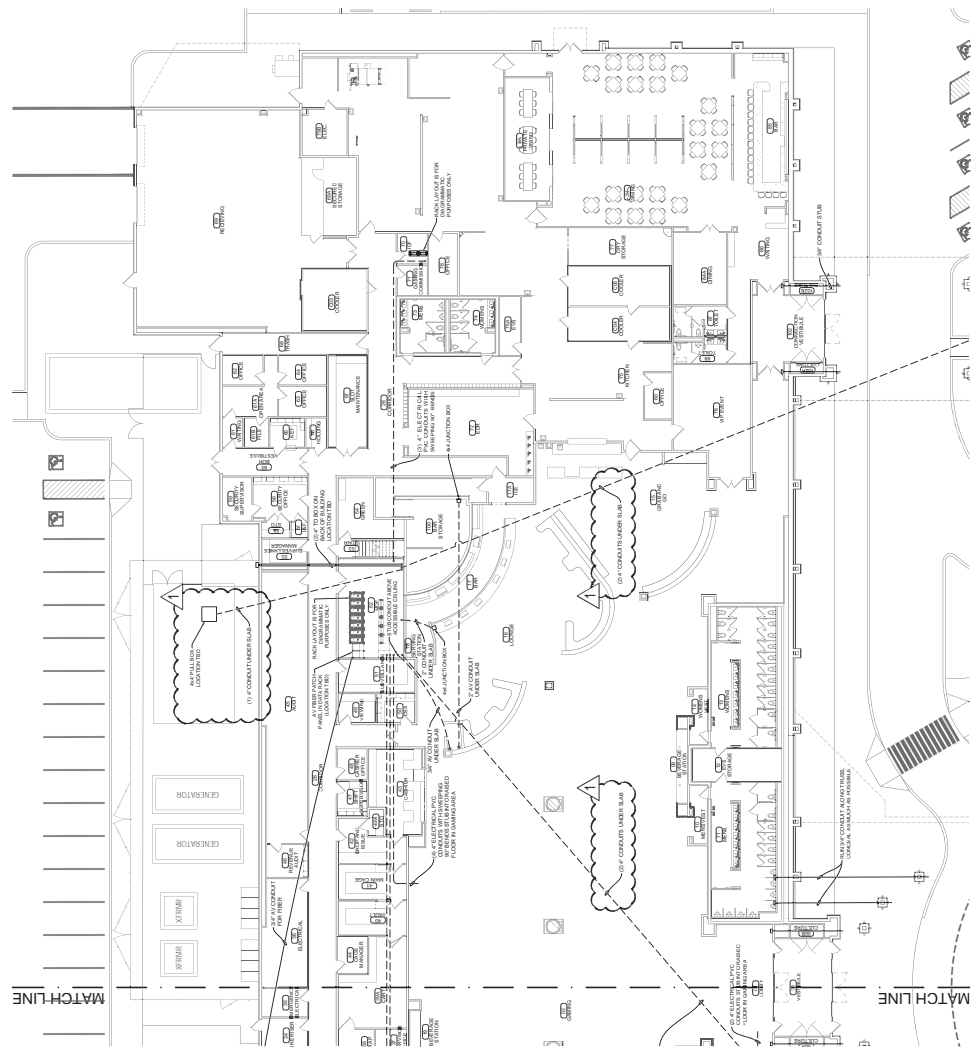

NO.	DATE	REVISION
1	07/13/18	ISSUED FOR PERMIT
2	07/13/18	ISSUED FOR PERMIT
3	07/13/18	ISSUED FOR PERMIT
4	07/13/18	ISSUED FOR PERMIT
5	07/13/18	ISSUED FOR PERMIT

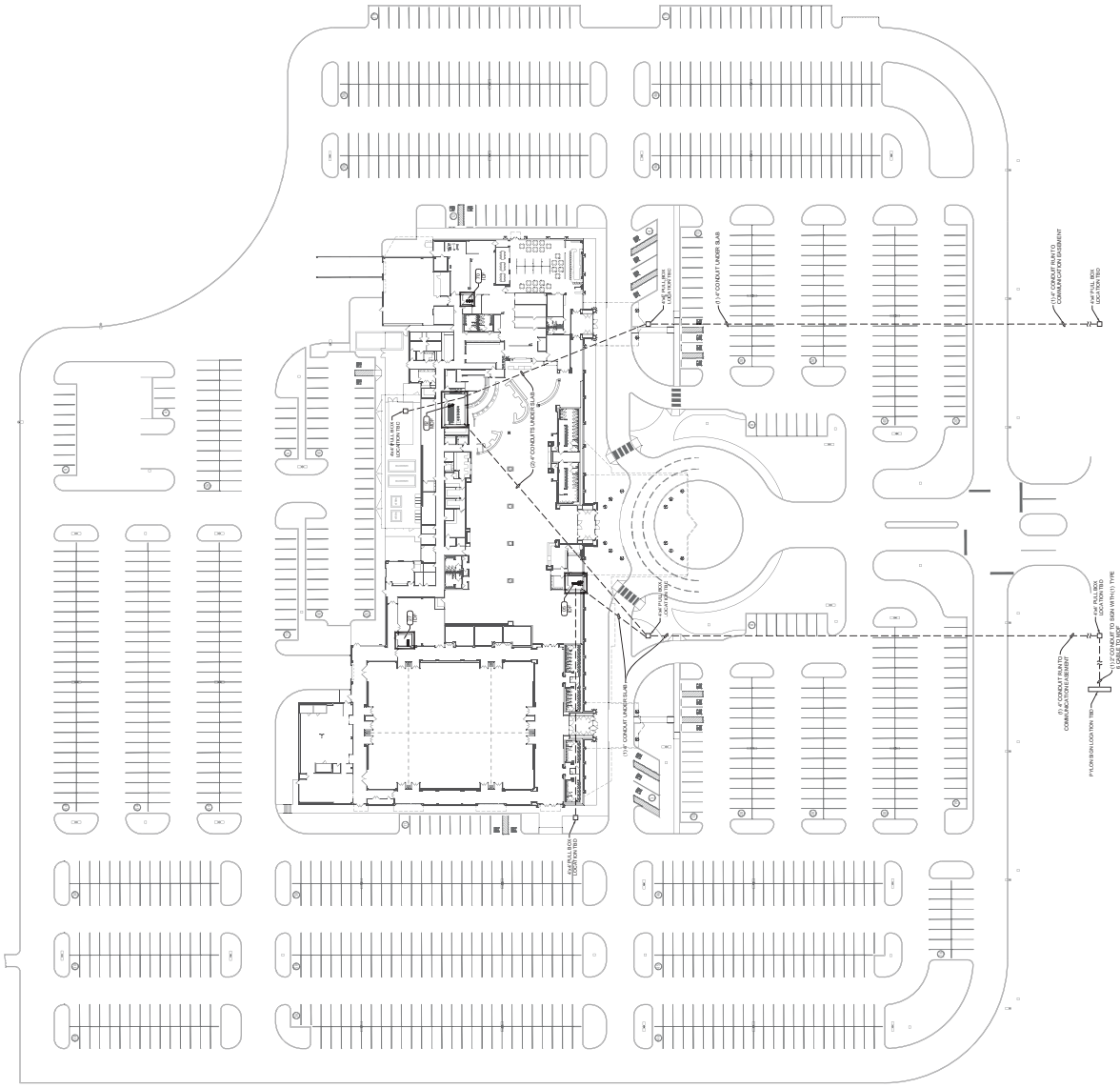

① SECURITY SITE PLAN
SCALE: 1" = 50'-0"





James R. Childers
Architect, Inc.
100 South A Street
Tahlequah, Oklahoma 74464
www.jrchilders.com



PROJECT NO: 1000



CHEROKEE NATION ENTERTAINMENT
TAHLEQUAH CASINO
TAHLEQUAH, OKLAHOMA

PROJECT NAME:
APPENDUM #15

DATE	DESCRIPTION
07/13/2018	17-06
07/13/2018	17-06
07/13/2018	17-06
07/13/2018	17-06
07/13/2018	17-06
07/13/2018	17-06
07/13/2018	17-06
07/13/2018	17-06
07/13/2018	17-06

DATE: 07/13/2018
TIME: 17:06
PROJECT NO: 1000

ITAV007
WIRING DIAGRAM
AUDIO DISTRIBUTION

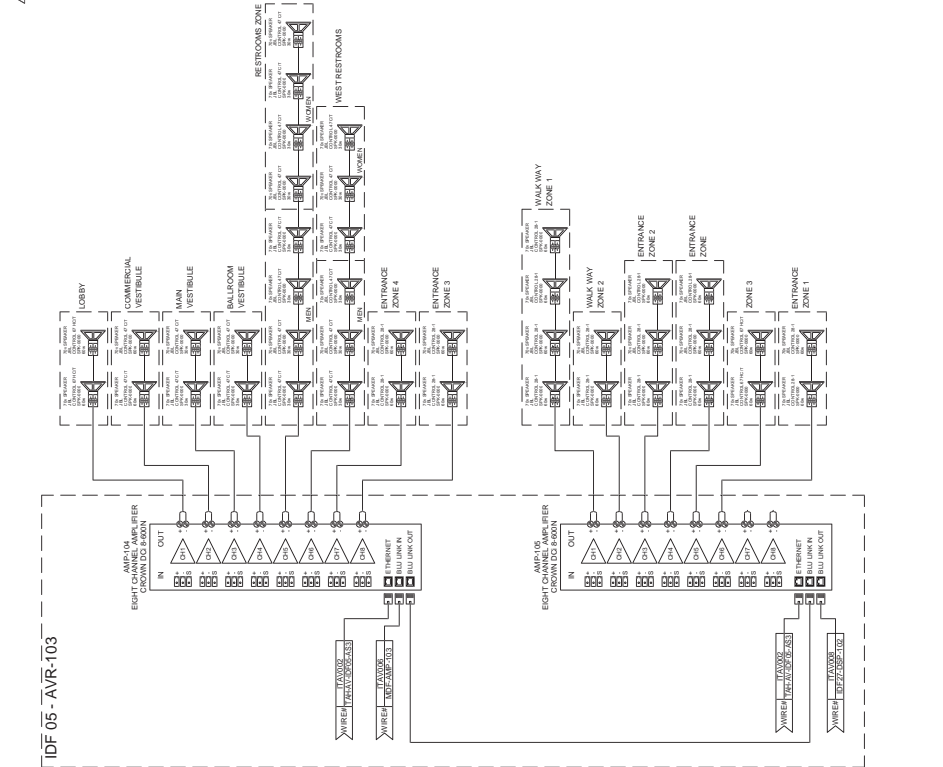
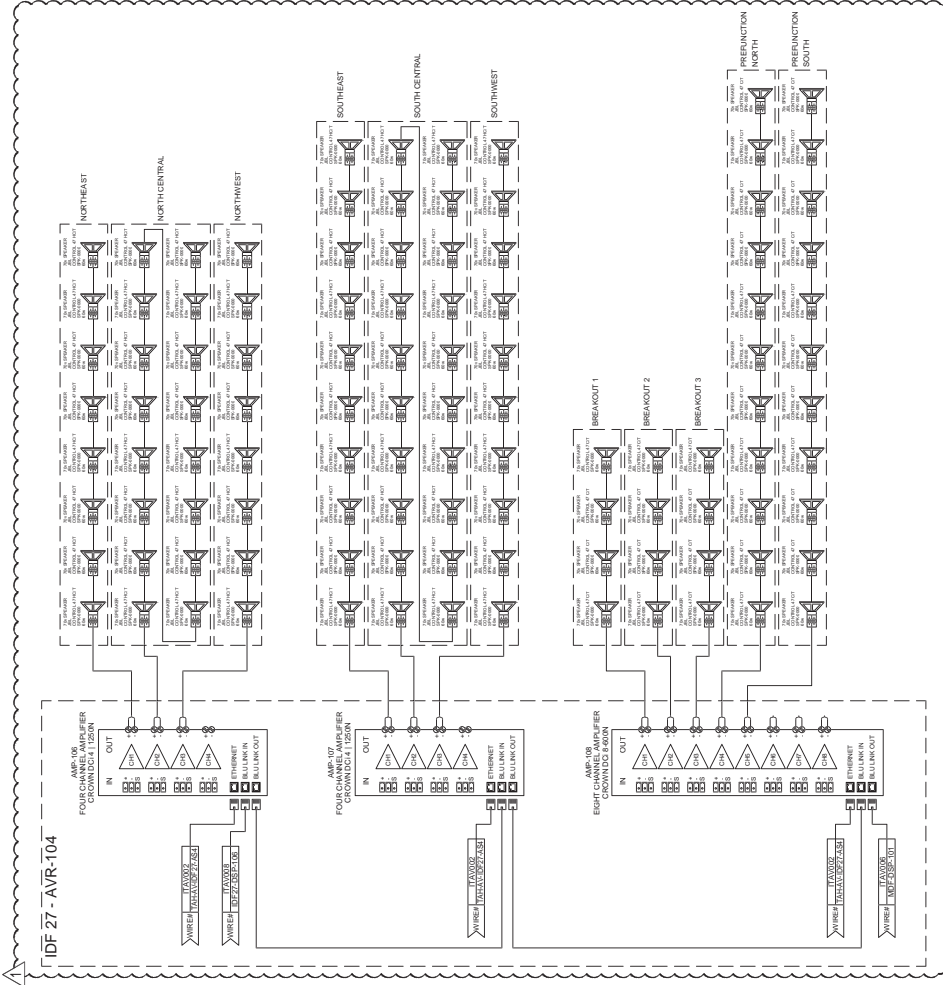



James R. Childers
Architect, Inc.
1801 South Loop West, Suite 2000
Houston, Texas 77058
www.jrchilders.com



POWER TO THE PEOPLE



CHEROKEE NATION ENTERTAINMENT
TALEQUAH CASINO
TALEQUAH, OKLAHOMA

PROJECT NAME:
APPENDUM #15

DATE	DESCRIPTION
07/13/2016	17-06
07/13/2016	17-06
07/13/2016	17-06
07/13/2016	17-06
07/13/2016	17-06
07/13/2016	17-06
07/13/2016	17-06
07/13/2016	17-06
07/13/2016	17-06

DATE: 07/13/2016
PROJECT: 17-06

ITAV008
WIRING DIAGRAM
AUDIO DISTRIBUTION

