

James R. Childers
Architect, Inc.

45 South 4th Street
Fort Smith, AR 72901
479-783-2480
www.childersarchitect.com

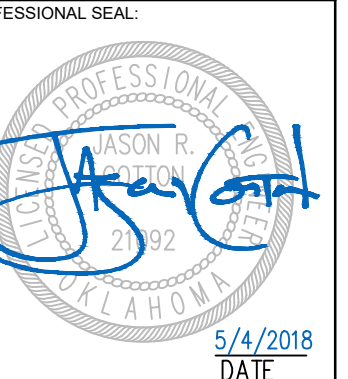

CONSULTANT LOGO:



920 West Main
Oklahoma City, OK 73106
P 405.232.5700
W www.adgokc.com
CA 6447, exp. 06.30.2018



CHEROKEE NATION ENTERTAINMENT
TAHLEQUAH CASINO
TAHLEQUAH, OKLAHOMA

PROJECT PHASE:
BID PACKAGE 04

REVISIONS		
#	DATE	DESCRIPTION
01	5/1/2018	ADDED

DATE: 04.20.2018 JOB NUMBER: 17-06

SHEET NUMBER: C9.05c

CIVIL CONSTRUCTION DETAILS

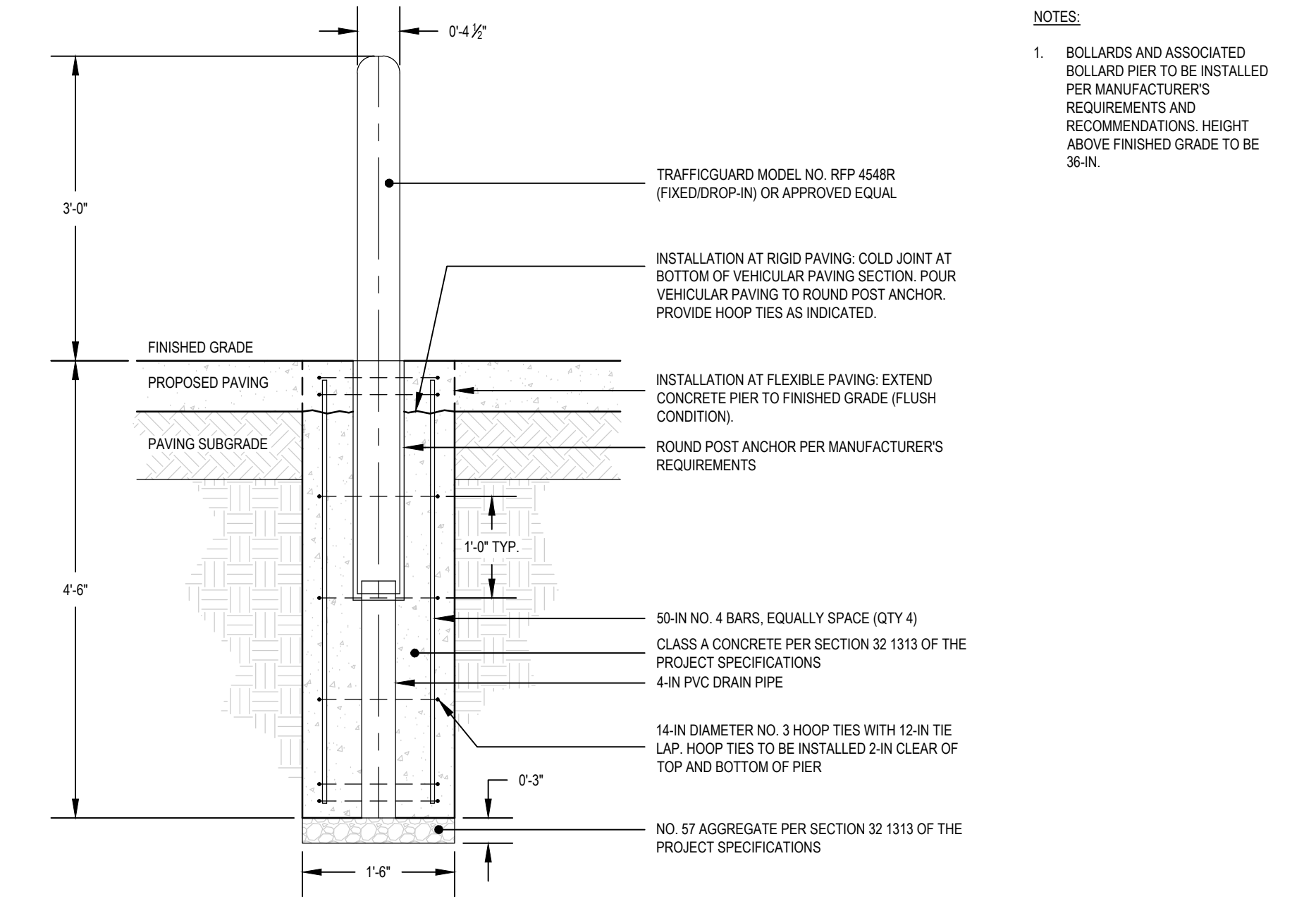

07 BOLLARD
SCALE: AS SHOWN

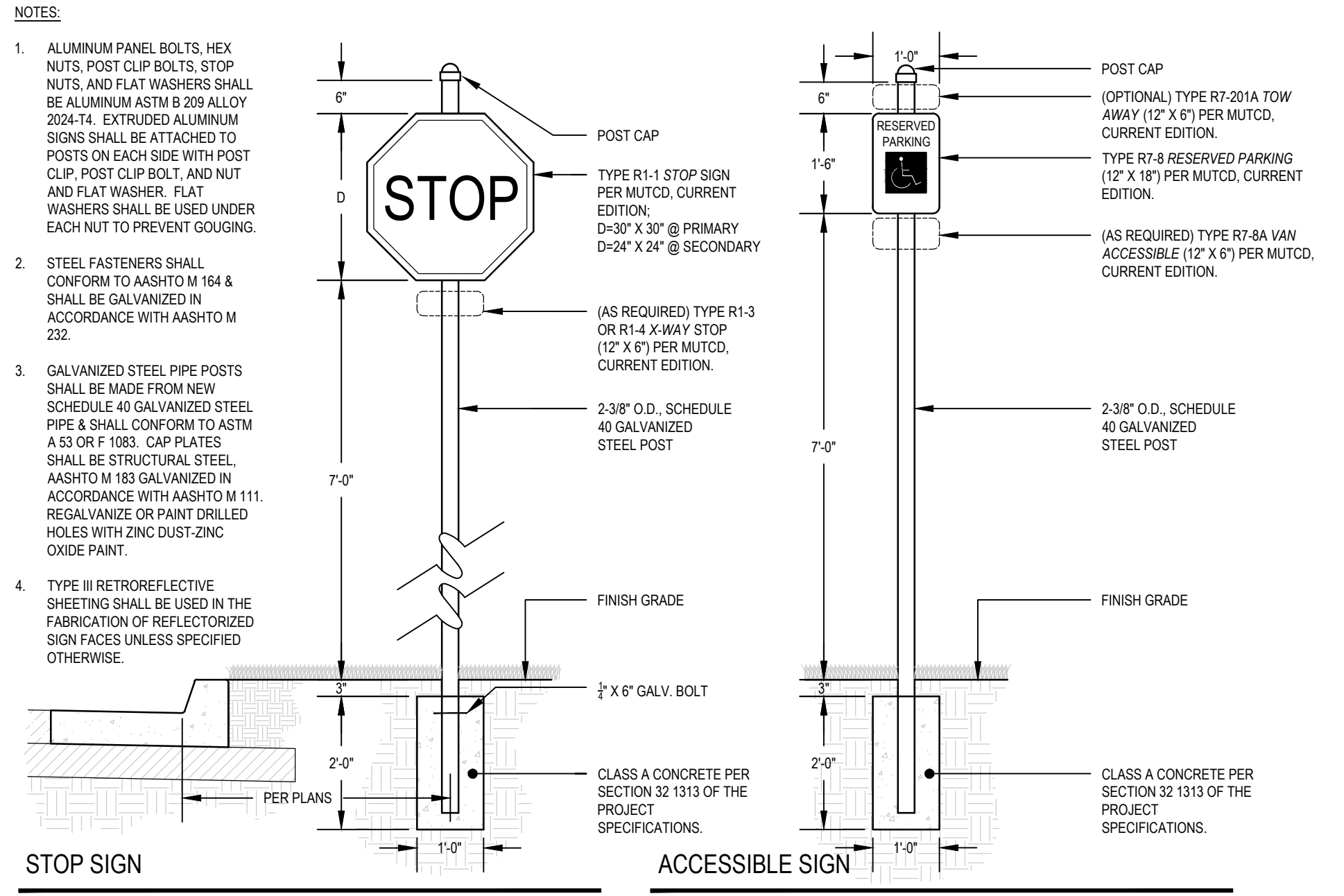

08 SITE TRAFFIC SIGNAGE
SCALE: AS SHOWN

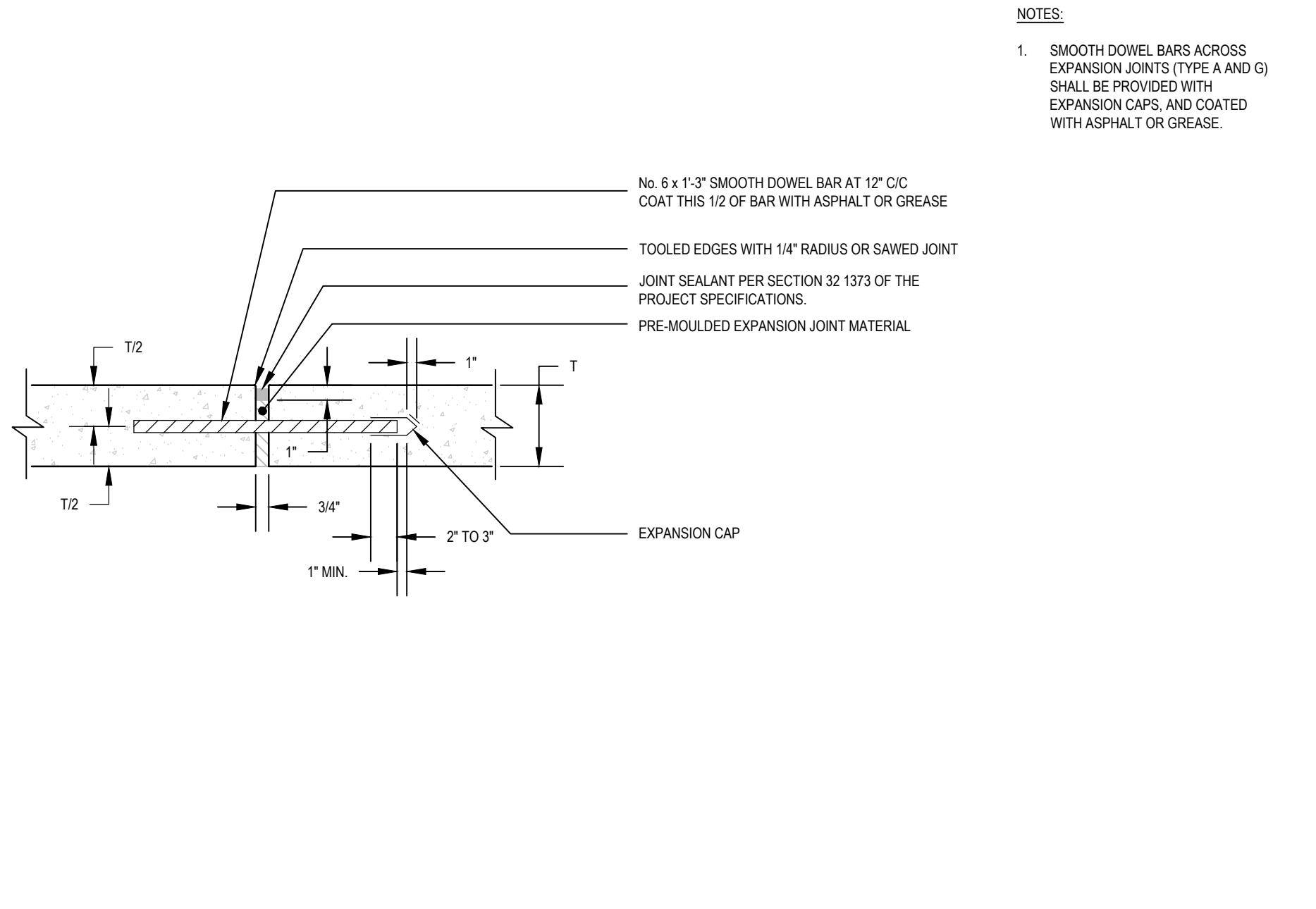

06 CONCRETE BARRIER CURB
SCALE: AS SHOWN

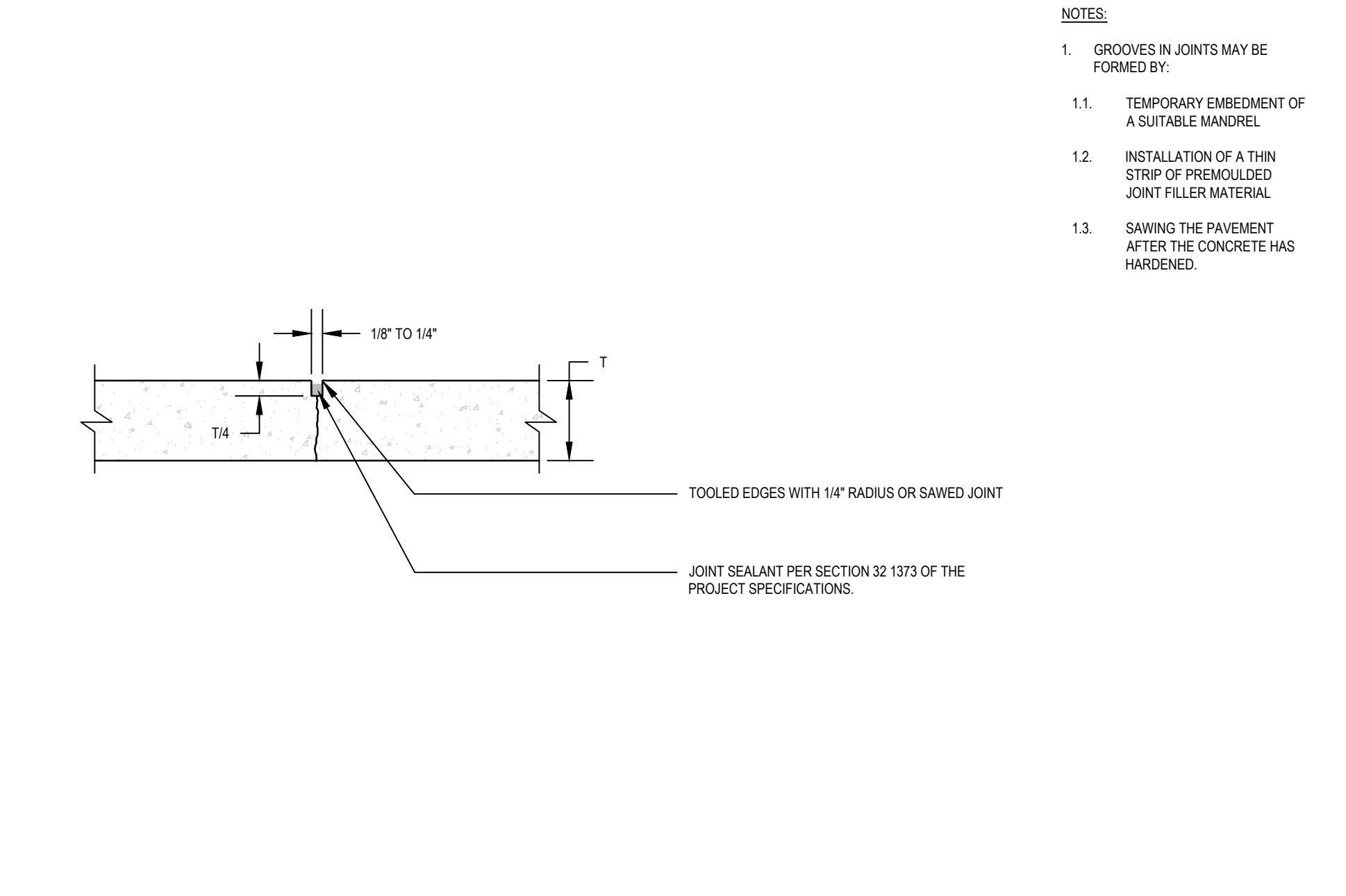

05 JOINT TYPE D - CONTRACTION JOINT
SCALE: AS SHOWN

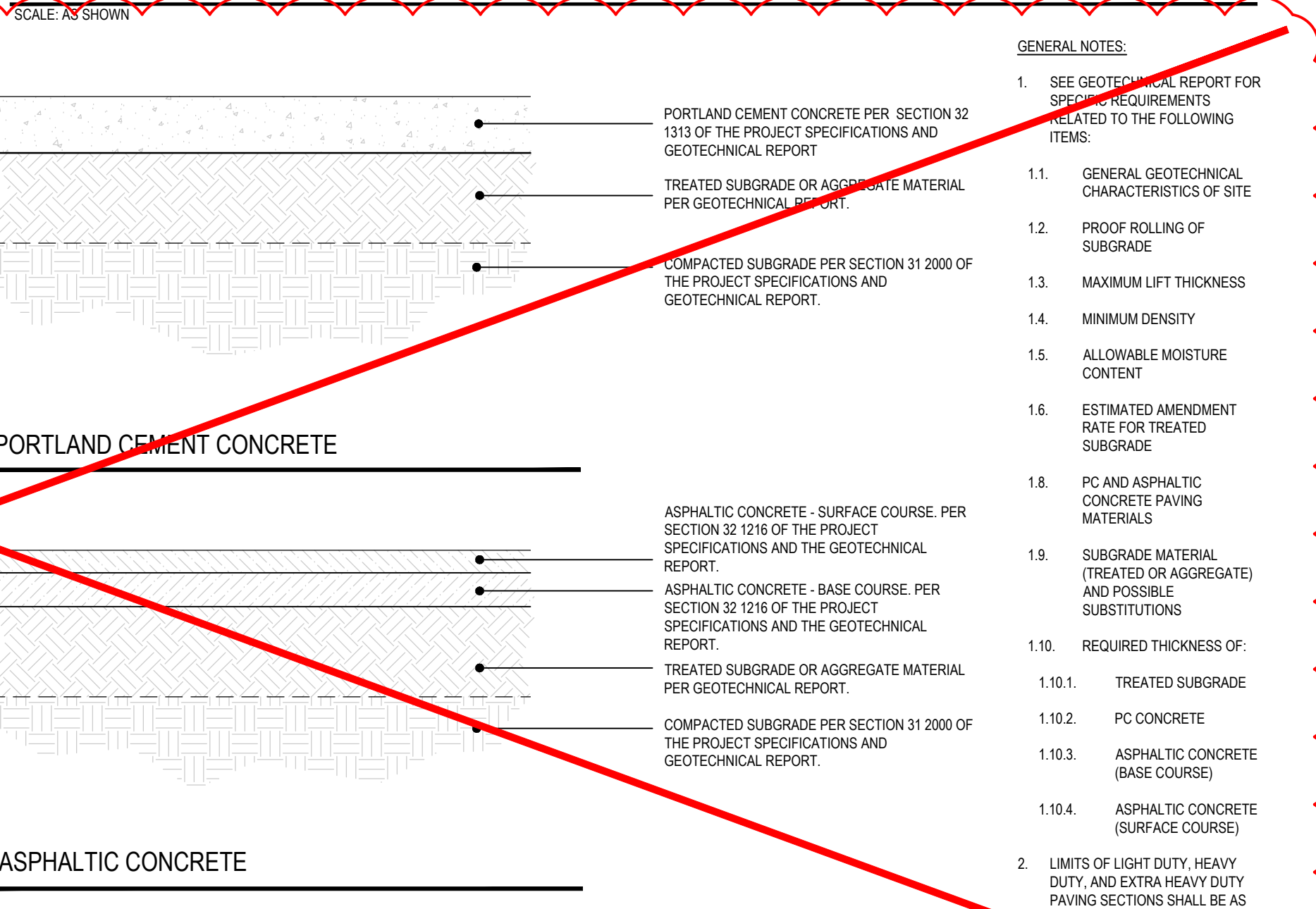

04 JOINT TYPE A - EXPANSION JOINT
SCALE: AS SHOWN

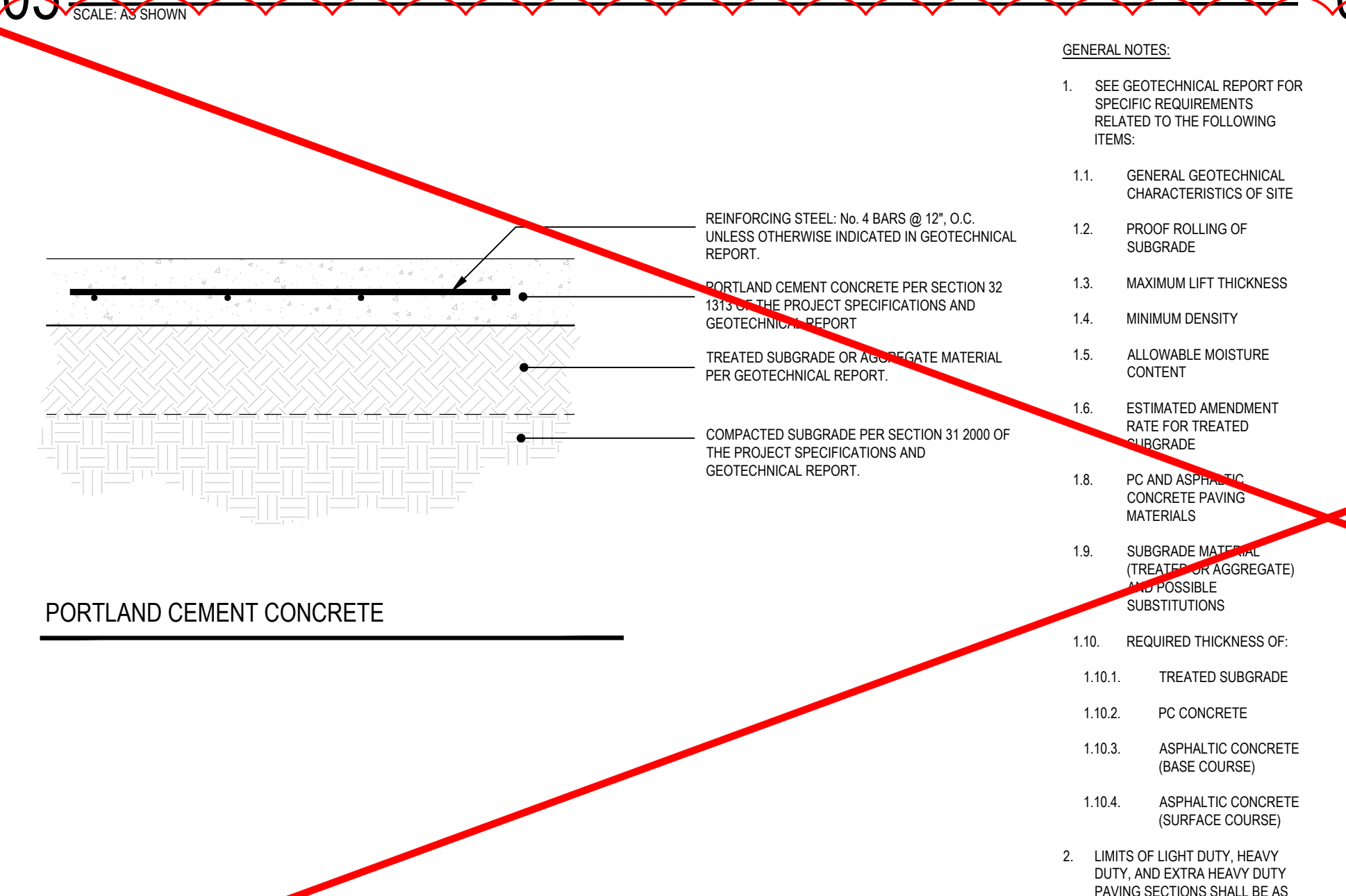

02 PAVING SECTION - REINFORCED CONCRETE
SCALE: AS SHOWN

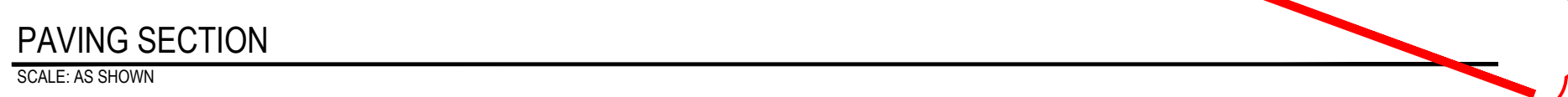

01 PAVING SECTION
SCALE: AS SHOWN

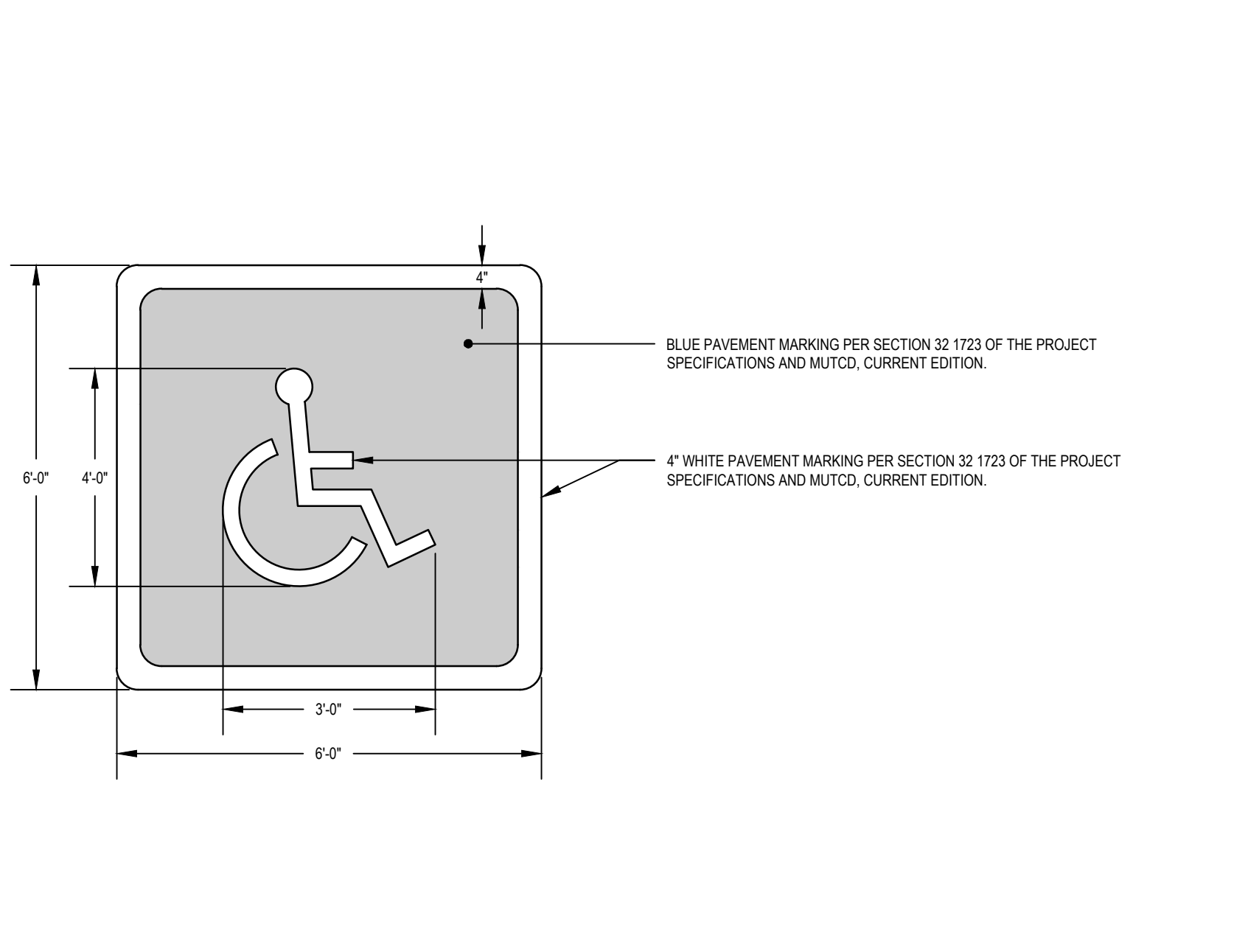

09 ACCESSIBLE SPACE PAVEMENT MARKING
SCALE: AS SHOWN

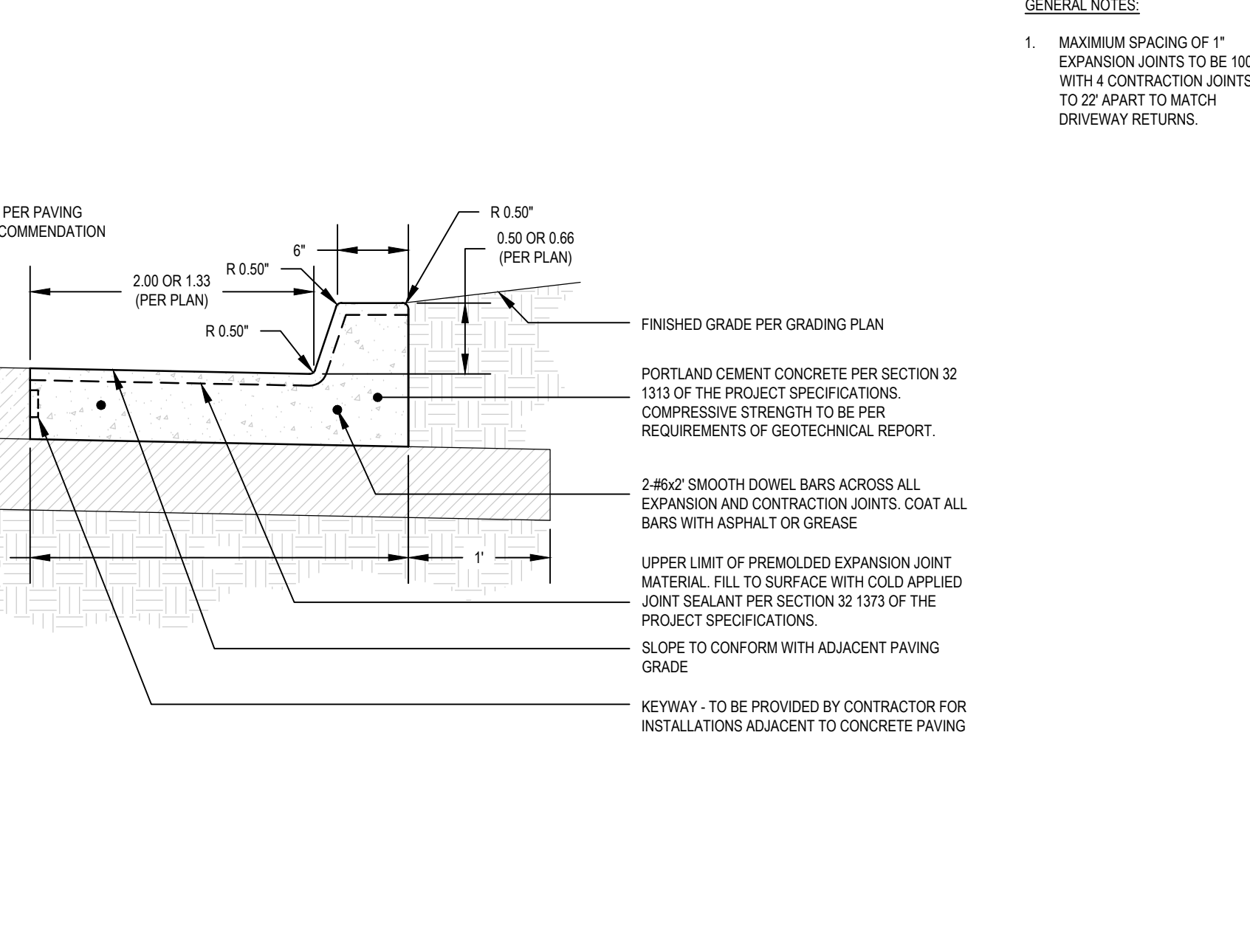

03 CONCRETE SIDEWALK
SCALE: AS SHOWN

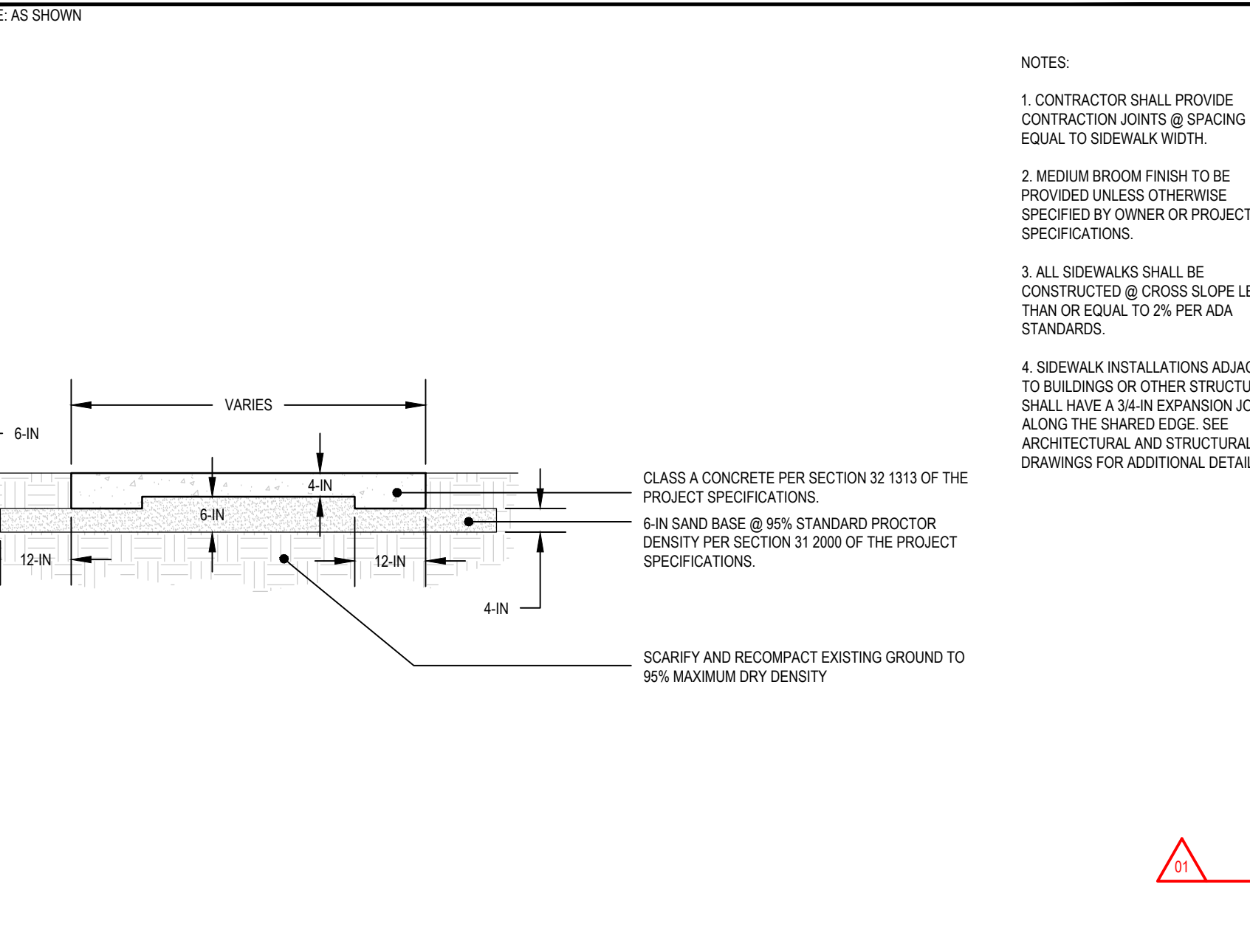

06 CONCRETE BARRIER CURB
SCALE: AS SHOWN

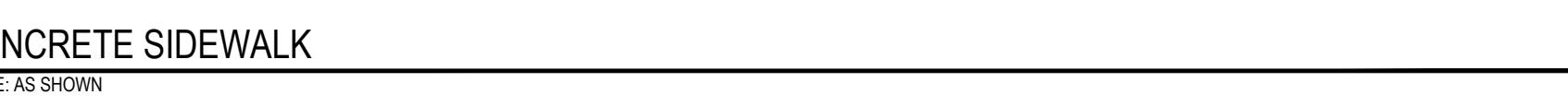

09 ACCESSIBLE SPACE PAVEMENT MARKING
SCALE: AS SHOWN

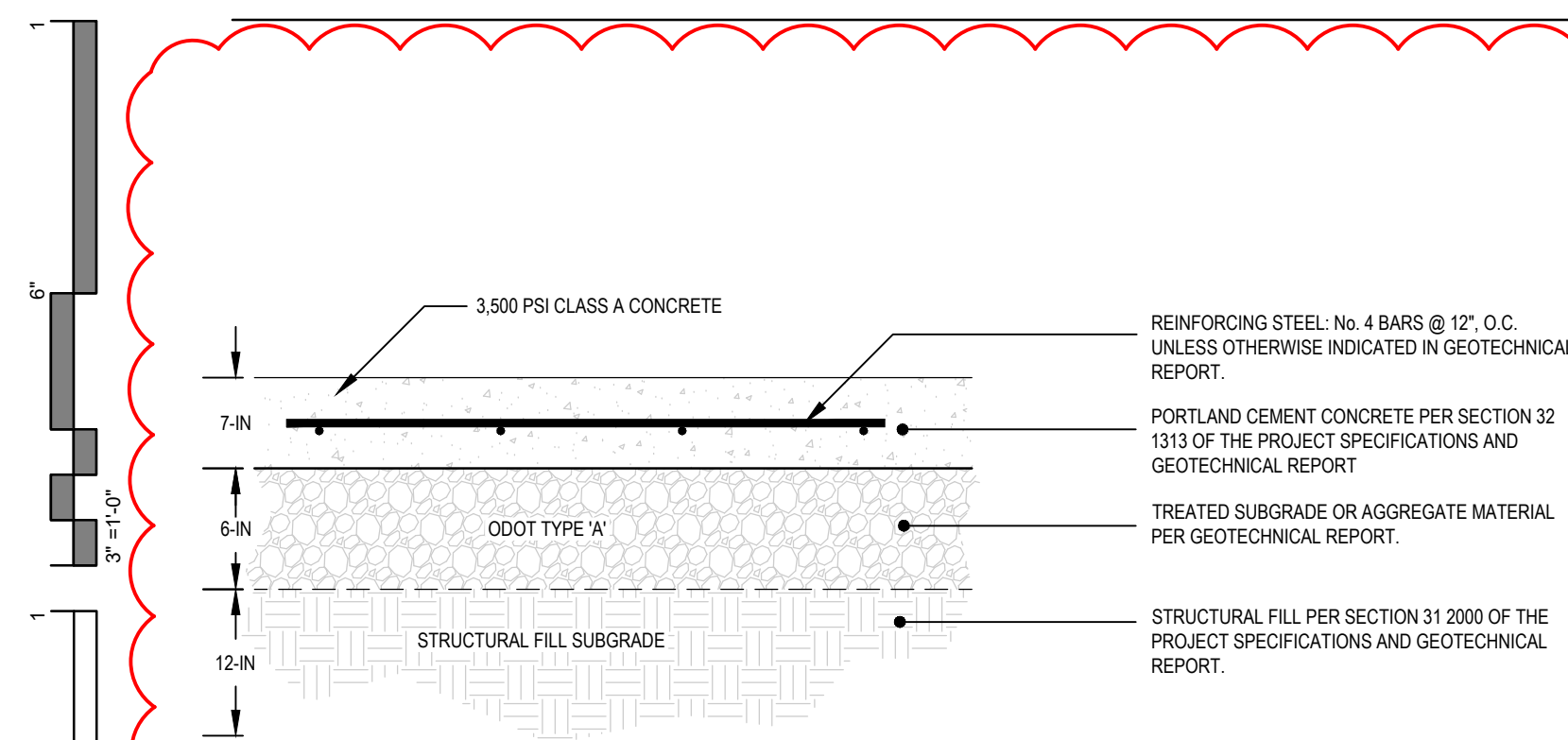

SECTION A9: REINFORCED RIGID PAVING WITH STRUCTURAL FILL SUBGRADE PORTLAND CEMENT CONCRETE

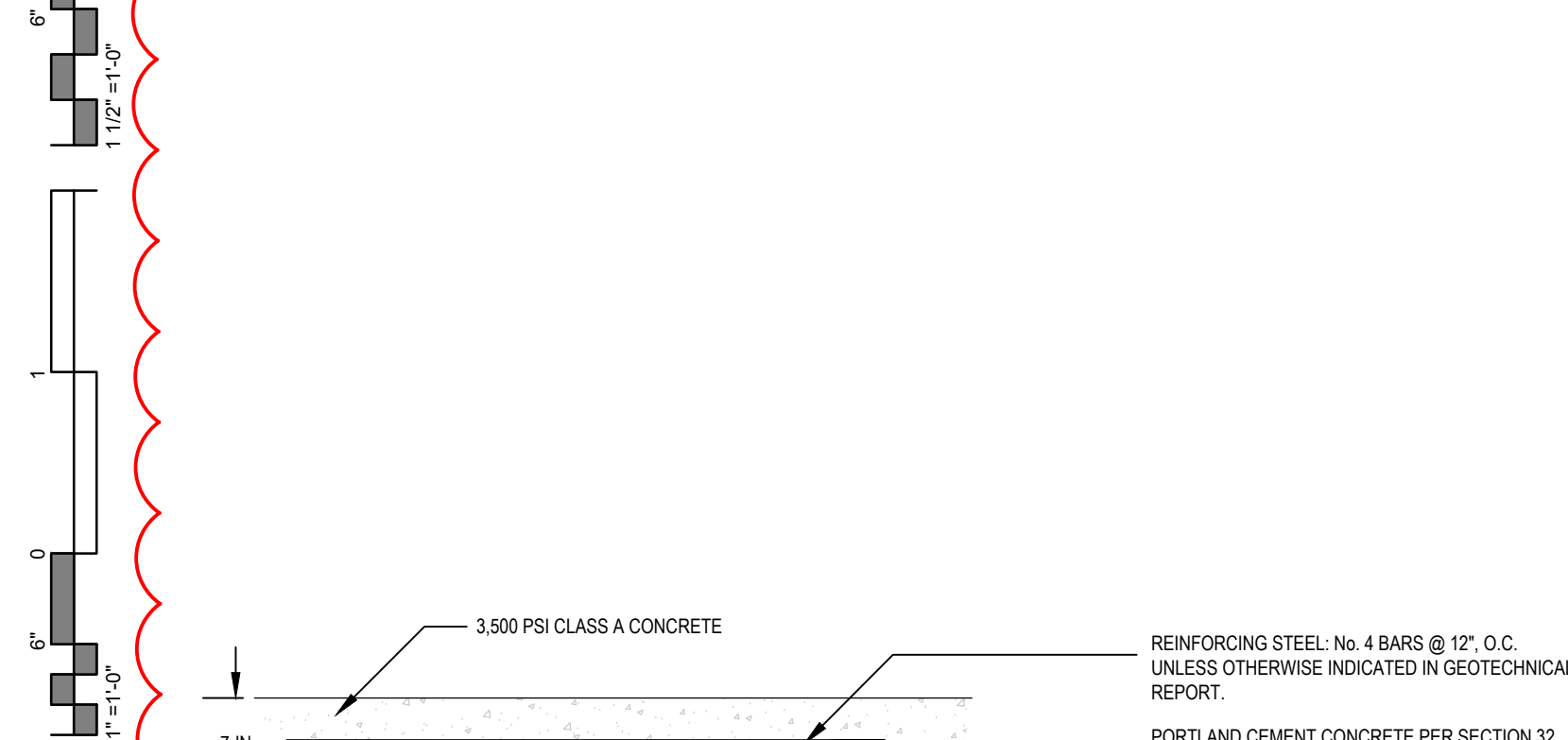

SECTION A8: LIGHT DUTY FLEXIBLE PAVING WITH STRUCTURAL FILL SUBGRADE

TABLE 14 ATTACHED

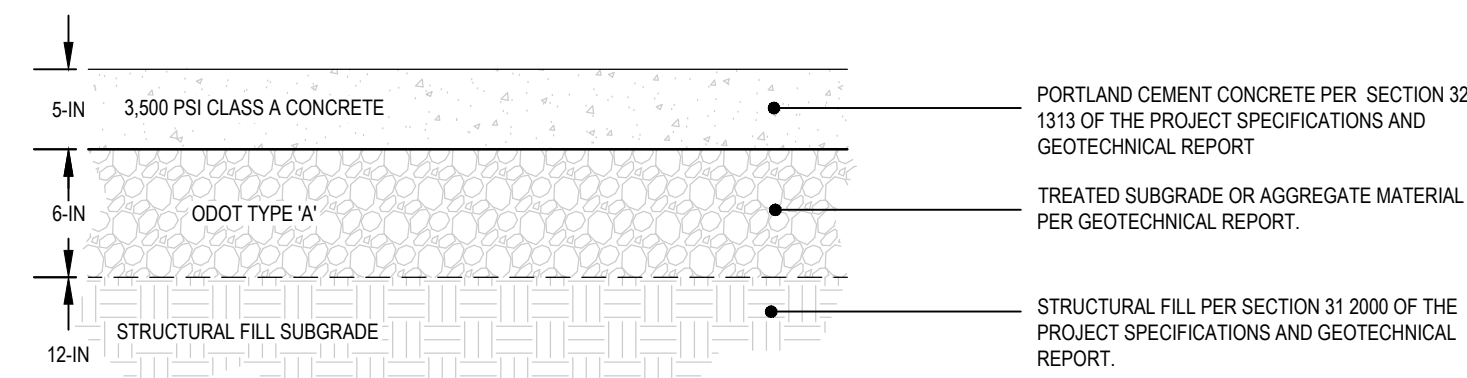

SECTION A7: LIGHT DUTY RIGID PAVING WITH STRUCTURAL FILL SUBGRADE

TABLE 15 ATTACHED

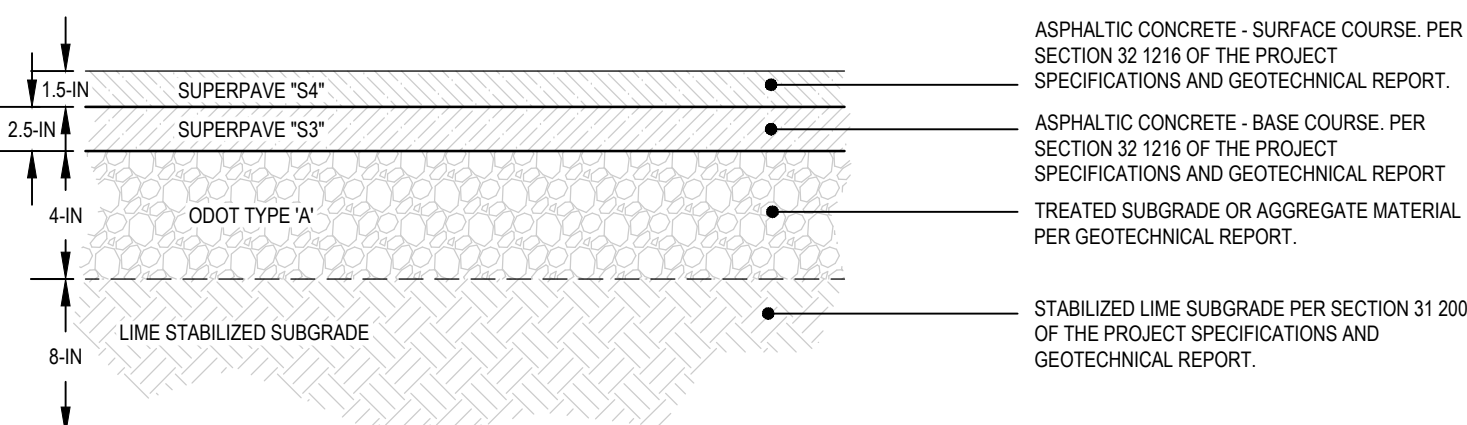

SECTION A6: LIGHT DUTY FLEXIBLE PAVING WITH STABILIZED LIME SUBGRADE

TABLE 14 ATTACHED

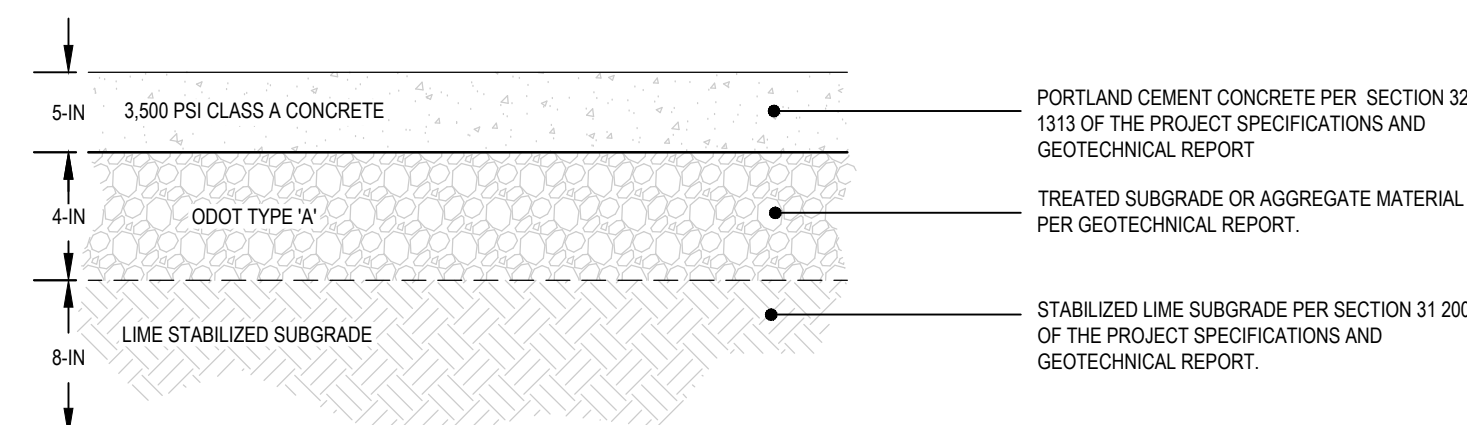

SECTION A5: LIGHT DUTY RIGID PAVING WITH STABILIZED LIME SUBGRADE

TABLE 15 ATTACHED

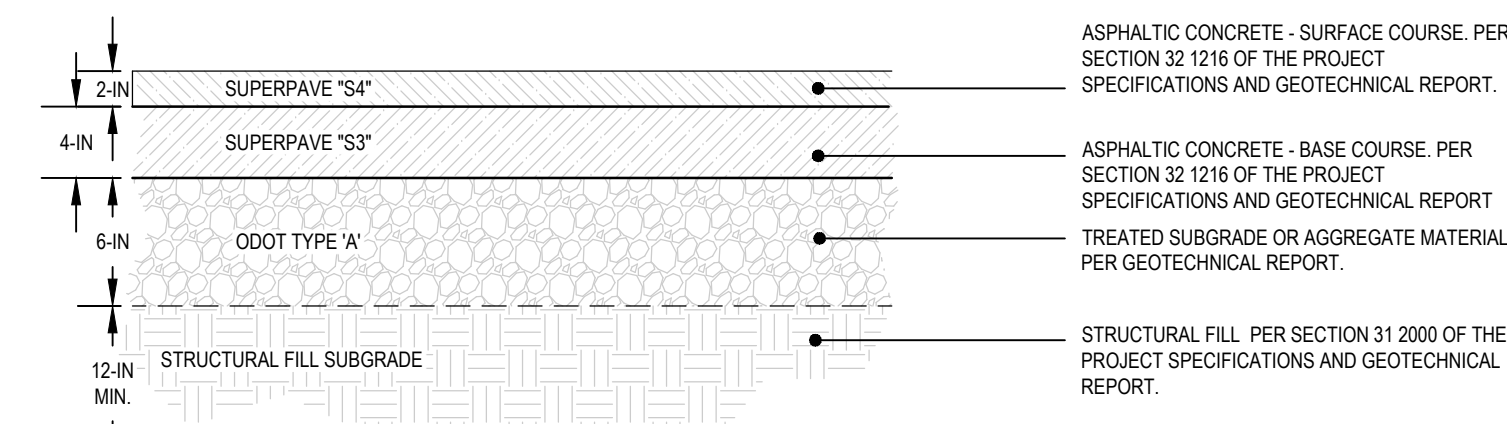

SECTION A4: HEAVY DUTY FLEXIBLE PAVING WITH STRUCTURAL FILL SUBGRADE

TABLE 14 ATTACHED

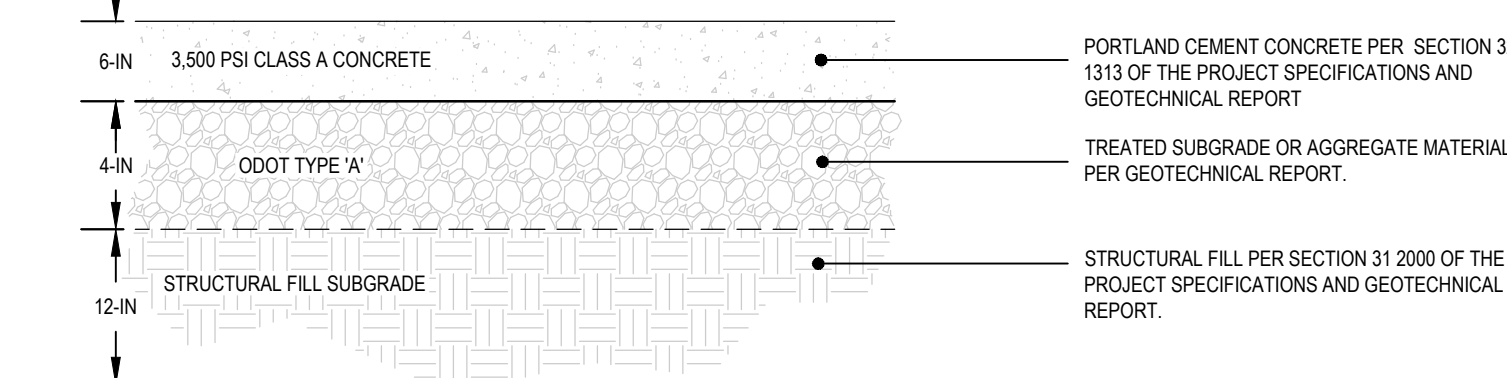

SECTION A3: HEAVY DUTY RIGID PAVING WITH STRUCTURAL FILL SUBGRADE

TABLE 15 ATTACHED

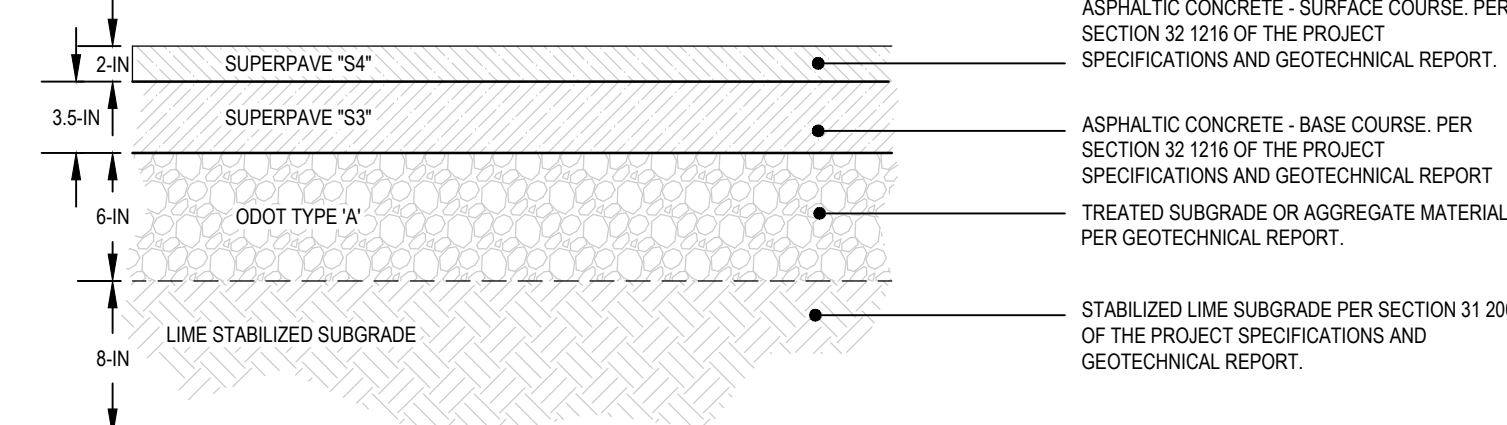

SECTION A2: HEAVY DUTY FLEXIBLE PAVING WITH STABILIZED LIME SUBGRADE

TABLE 14 ATTACHED

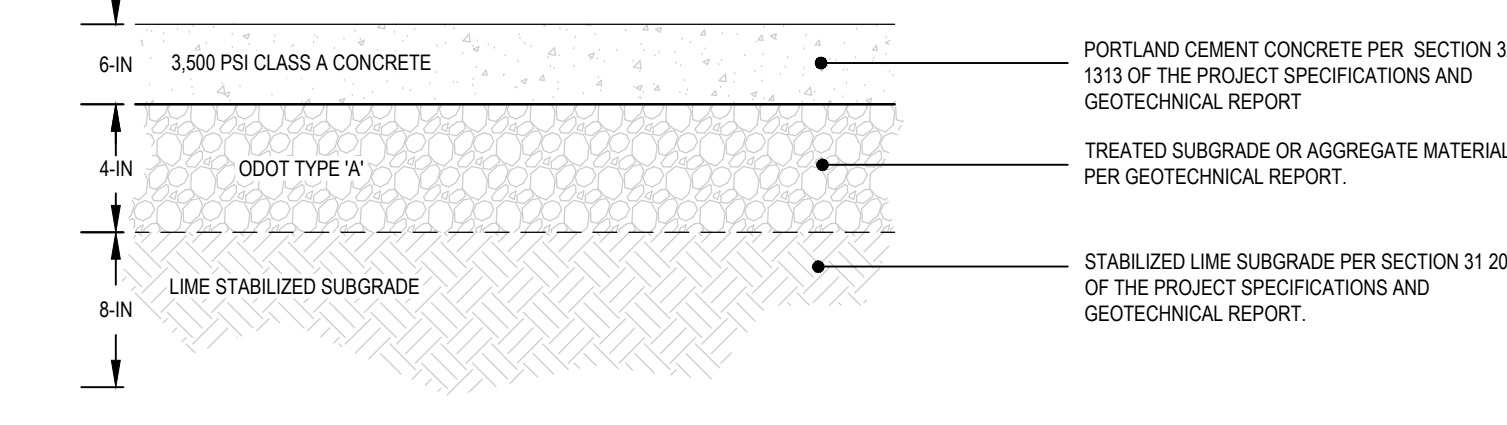

SECTION A1: HEAVY DUTY RIGID PAVING WITH STABILIZED LIME SUBGRADE

TABLE 15 ATTACHED

GENERAL NOTES:

- SEE GEOTECHNICAL REPORT FOR SPECIFIC REQUIREMENTS RELATED TO THE FOLLOWING ITEMS:
 - GENERAL GEOTECHNICAL CHARACTERISTICS OF SITE
 - PROOF ROLLING OF SUBGRADE
 - MAXIMUM LIFT THICKNESS
 - MINIMUM DENSITY
 - ALLOWABLE MOISTURE CONTENT
 - ESTIMATED AMENDMENT RATE FOR TREATED SUBGRADE
 - PC AND ASPHALTIC CONCRETE PAVING MATERIALS
 - LIMITS OF LIGHT DUTY HEAVY DUTY AND REINFORCED CONCRETE PAVING SECTIONS SHALL BE AS SPECIFIED ON THE PLANS.

02 PROPOSED PAVING SECTIONS
SCALE: AS SHOWN

GENERAL NOTES:

- MAXIMUM SPACING OF 1' EXPANSION JOINTS TO BE 100' C/C WITH 4 CONTRACTION JOINTS 18' TO 22' APART TO MATCH DRIVEWAY RETURNS.

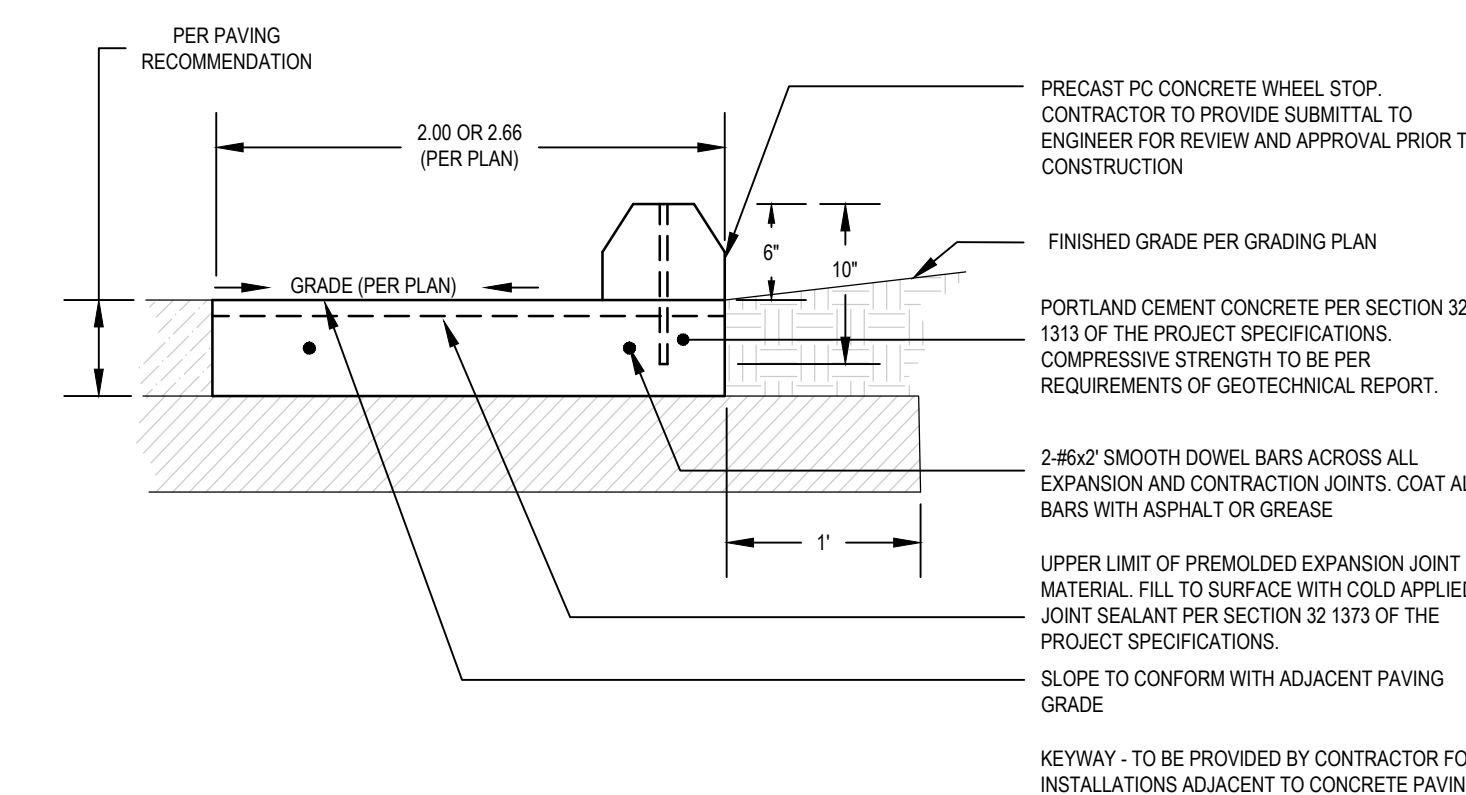
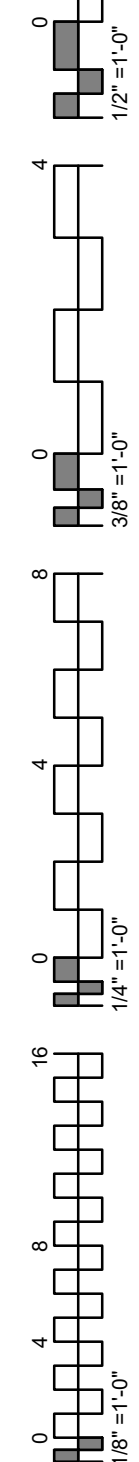

01 6-IN CONCRETE RIBBON CURB
SCALE: AS SHOWN

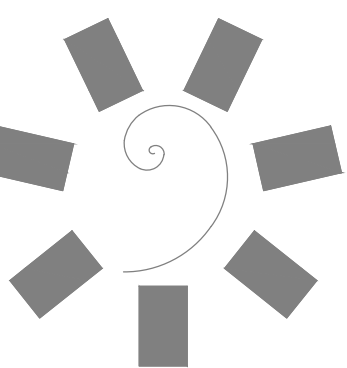

James R. Childers Architect, Inc.

45 South 4th Street
Fort Smith, AR 72901
479-783-2480
www.childersarchitect.com

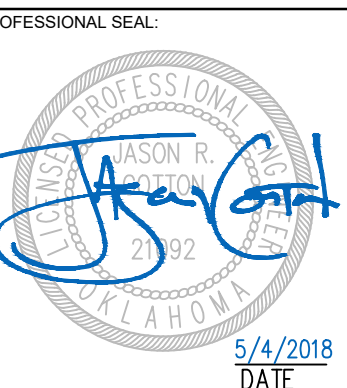

CONSULTANT LOGO:



920 West Main
Oklahoma City, OK 73106
P 405.232.5700
W www.adgokc.com
CA 6447, exp. 06.30.2018



CHEROKEE NATION ENTERTAINMENT
TAHLEQUAH CASINO
 TAHLEQUAH, OKLAHOMA

PROJECT PHASE:

BID PACKAGE 04

REVISIONS		
#	DATE	DESCRIPTION
01	04/20/18	ADD CURB

DATE: 04.20.2018 JOB NUMBER: 17-06

SHEET NUMBER:

C9.15c

CIVIL CONSTRUCTION DETAILS