

Map data ©2023 Google 2 mi

Tahlequah
Oklahoma 74464

- ↑ 1. Head south on S Muskogee Ave toward W Shawnee St
 ⓘ Pass by BancFirst (on the right in 0.2 mi)
 _____ 4.1 mi
- ↻ 2. At the traffic circle, take the 2nd exit onto State Hwy 82
 _____ 13.7 mi
- ↘ 3. Turn right onto W Cookson Bend Rd
 _____ 1.7 mi
- ↵ 4. Turn left onto S 528 Rd/Singapore Rd
 ⓘ Destination will be on the left
 _____ 384 ft

32381 S 528 Rd
Cookson, OK 74427



Housing Authority of the Cherokee Nation
 PO Box 1007,
 Tahlequah, Oklahoma 74465-1007
 918-456-5482 | 1-800-837-2869

Description	Quantity	Per
ESTIMATE: Rehab (Housing Authority of the Cherokee Nation)		Claim #10646, Roy Miller
Approved		
FLOORPLAN: Floorplan		

Cooktop & Oven

1 Cooktop, Countertop, Electric Very Good - Remove	1	EA
2 Cooktop, Countertop, Electric Very Good - Replace	1	EA
3 Oven, Built-In, Electric Very Good - Replace	1	EA
4 Oven, Built-In, Electric Very Good - Remove	1	EA
5 Dumpster 20 Yard	1	EA

Windows

6 Window, Double Hung, Vinyl Clad Medium - Remove	16	EA
7 Window, Double Hung, Vinyl Clad Medium - Replace	16	EA

Ramp

8 Wheelchair Ramp, Medium - Replace	1	EA
9 Sidewalk, per SF - Replace	80.00	SF

Deck

DECK FRAMING ITEMS

10 Deck Girder Treated Pine 2"x6" - Tear Out	12.00	LF
11 Deck Girder Treated Pine 2"x6" - Replace	12.00 (12.60)	LF
Includes 5% waste on material quantity.		
12 Deck Joists (SF), Treated Pine 2"x6", 16" o.c. - Tear Out	96.00	SF
13 Deck Joists (SF), Treated Pine 2"x6", 16" o.c. - Replace	96.00 (100.80)	SF
Includes 5% waste on material quantity.		
14 Ledger Board, Treated Pine 2"x8" - Tear Out	12.00	LF
15 Ledger Board, Treated Pine 2"x8" - Replace	12.00 (12.60)	LF
Includes 5% waste on material quantity.		
16 Decking, Treated Pine, 5/4" thick - Tear Out	96.00	SF
17 Decking, Treated Pine, 5/4" thick - Replace	96.00 (100.80)	SF
Includes 5% waste on material quantity.		
18 Deck Railing Complete, Pressure Treated - Tear Out	24.00	LF
19 Deck Railing Complete, Pressure Treated - Replace	24.00 (25.20)	LF
Includes 5% waste on material quantity.		

DEBRIS REMOVAL

Master Bathroom

Length: 11'9" Width: 13'4" Height: 8' Flat
 Walls: 401.34 SF Walls-subs: 381.34 SF Walls-subs-cas-bsbd: 289.91 SF
 Doors: 20.00 SF Windows: 0.00 SF Openings: 0.00 SF Missing Walls: 0.00 SF
 Floor: 156.67 SF Ceiling: 156.67 SF Perim (F): 46.58 LF Perim (C): 50.16 LF

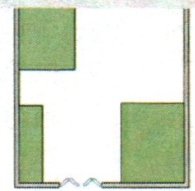

20 Shower Stall, Fiberglass Very Good - Remove	1	EA
--	---	----



Housing Authority of the Cherokee Nation
 PO Box 1007,
 Tahlequah, Oklahoma 74465-1007
 918-456-5482 | 1-800-837-2869

Description	Quantity	Per
ESTIMATE: Rehab (Housing Authority of the Cherokee Nation)	Claim #10646, Roy Miller	
Approved		

Master Bathroom(con't)

21 Shower Stall, Fiberglass Very Good - Replace Install low curb handicap shower.	1	EA
22 Faucet & Showerhead Single Valve, Good - Remove	1	EA
23 Grab Bar, Handicap, per LF - Replace Install four 2' grab bars.	8.00	LF
24 Faucet & Showerhead Single Valve, Good - Replace	1	EA
25 Toilet, 1 Piece, Very Good - Remove	1	EA
26 Toilet, Handicap Very Good - Replace	1	EA
27 Drywall, Ceiling 1/2", Taped - Remove	156.67	SF
28 Drywall, Ceiling 1/2", Taped - Replace Includes 5% waste on material quantity.	156.67 (164.50)	SF
29 Texture, Ceiling, Popcorn, Light - Replace	156.67	SF
30 Drywall/Plaster Ceiling - Prime & Paint	156.67	SF
31 Carpet & Pad, Good - Remove	100.28	SF
32 Linoleum, Sheet Very Good - Replace Includes 10% waste on material quantity.	11.14 (12.25)	SY
33 Insulation, Ceiling, Batt, Faced 6", R-19 - Remove	156.67	SF
34 Insulation, Ceiling, Batt, Faced 6", R-19 - Replace	156.67	SF

Laundry Room

Length: 5' **Width:** 10'2" **Height:** 8' Flat
Walls: 242.66 SF **Walls-subs:** 242.66 SF **Walls-subs-cas-bsbd:** 200.64 SF
Doors: 0.00 SF **Windows:** 0.00 SF **Openings:** 0.00 SF **Missing Walls:** 0.00 SF
Floor: 50.83 SF **Ceiling:** 50.83 SF **Perim (F):** 30.34 LF **Perim (C):** 30.34 LF

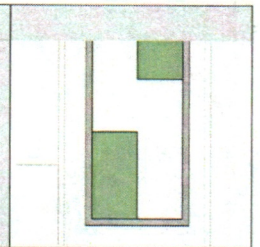

35 Drywall, Wall 1/2" - Remove	242.66	SF
36 Drywall, Wall 1/2" - Replace Includes 6% waste on material quantity.	242.66 (257.22)	SF
37 Underlayment 3/4" CDX Plywood, Tongue & Groove - Remove	32.00	SF
38 Underlayment 3/4" CDX Plywood, Tongue & Groove - Replace Includes 10% waste on material quantity. Match Existing	32.00 (35.20)	SF
39 Paneling, Prefinished Good - Remove	242.66	SF
40 Paneling, Prefinished Good - Replace Includes 5% waste on material quantity.	242.66 (254.79)	SF



Housing Authority of the Cherokee Nation
 PO Box 1007,
 Tahlequah, Oklahoma 74465-1007
 918-456-5482 | 1-800-837-2869

Description	Quantity	Per
ESTIMATE: Rehab (Housing Authority of the Cherokee Nation)		Claim #10646, Roy Miller
Approved		

Dining Room

Length: 11' **Width:** 13'1" **Height:** 8' Flat
Walls: 385.34 SF **Walls-sub:** 345.34 SF **Walls-sub-cas-bsbd:** 327.39 SF
Doors: 40.00 SF **Windows:** 0.00 SF **Openings:** 0.00 SF **Missing Walls:** 0.00 SF
Floor: 143.92 SF **Ceiling:** 143.92 SF **Perim (F):** 41.58 LF **Perim (C):** 48.16 LF



41 Door, Patio, Sliding, Aluminum, 6'-8" 2 Panel, 6' - Remove	1	EA
42 Door, Patio, French, Steel 6'-0" x 6'-8" - Replace	1	EA
43 Lockset, Exterior Very Good - Replace	1	EA
44 Door, Patio, French, Single - Prime & Paint	1	EA
☐ Prime and paint both sides of both doors being installed.		
45 Carpet & Pad, Very Good - Remove	143.92	SF
46 Carpet & Pad, Very Good - Replace	143.92 (176.00)	SF
☐ Includes 22.29% waste on material quantity calculated by Rollout Calculator.		
47 Subfloor Plywood, 3/4" - Remove	32.00	SF
48 Subfloor Plywood, 3/4" - Replace	32.00 (35.20)	SF
☐ Includes 10% waste on material quantity.		

Living Room

Length: 15'10" **Width:** 26'8" **Height:** 8' Flat
Walls: 680.01 SF **Walls-sub:** 680.01 SF **Walls-sub-cas-bsbd:** 655.21 SF
Doors: 0.00 SF **Windows:** 0.00 SF **Openings:** 0.00 SF **Missing Walls:** 0.00 SF
Floor: 401.99 SF **Ceiling:** 401.99 SF **Perim (F):** 84.99 LF **Perim (C):** 84.99 LF



49 Carpet & Pad, Very Good - Remove	401.99	SF
50 Carpet & Pad, Very Good - Replace	401.99 (443.35)	SF
☐ Includes 10.29% waste on material quantity calculated by Rollout Calculator.		
51 Drywall, Ceiling 1/2", Taped - Remove	401.99	SF
52 Drywall, Ceiling 1/2", Taped - Replace	401.99 (422.09)	SF
☐ Includes 5% waste on material quantity.		
53 Texture, Ceiling, Popcorn, Light - Replace	401.99	SF
54 Drywall/Plaster Ceiling - Prime & Paint	401.99	SF
55 Insulation, Ceiling, Batt, Faced 6", R-19 - Remove	401.99	SF
56 Insulation, Ceiling, Batt, Faced 6", R-19 - Replace	401.99	SF

Total: _____