

6/30/26

Cherokee Nation Justice Center
Tahlequah, Oklahoma

Re: Bid Package #2

CROSSLAND
CONSTRUCTION COMPANY, INC.

420 S. 145th East Avenue, Suite K

Tulsa, Oklahoma 74108

tel 918.712.1441

fax 918.712.2044

CM Addendum #2

This addendum forms a part of the Contract Documents and modifies the original Bidding Documents as noted below and attached. Acknowledge receipt of this Addendum in the space provided on attachment "A" located in Bid Package #1 documents. Failure to do so may subject the Bidder to disqualification.

Revisions to Bid Package #2:

- 1) It is the responsibility of all Trade Contractors to review all attached plans, specifications, notes, narratives and clarification information associated with CM Addendum #2 and include all applicable changes as it relates to your scope of work.
- 2) Please ensure to fill out the Trade Contract Attachment "B" to note receipt of CM Addenda in addition to any Addenda issued by the architect.
- 3) For **ALL TRADE CONTRACTORS** – Include TERO fees in proposals.
- 4) For **Trade Contract 03A – Building Concrete** – Clarification for call out F5 on sheet S4.02 – F5 – 4" total depth: 2.5" NW Concrete over 1.5" VLI composite Metal Deck. Reinforce w/ #4 rebar @ 12" O.C. and fasten to structure per general notes & 03/S0.50.
- 5) For **Trade Contract 5A – Structural Steel** - Clarification for call out F5 on sheet S4.02 – F5 – 4" total depth: 2.5" NW Concrete over 1.5" VLI composite Metal Deck. Reinforce w/ #4 rebar @ 12" O.C. and fasten to structure per general notes & 03/S0.50. Beams will be composite allow for 3/4" camber 12" O.C. spacing along the hardened area floor beams.
- 6) For **Trade Contract 05A – Structural Steel** – Exclude handrails.
- 7) For **Trade Contract 05A – Structural Steel** – Clarification for call outs 2.09 and 2.10 on S4.05. 2.09 – Welded Moment connections, see typical moment connection on S0.2-Series Drawings. 2.10 – HSS4x2x1/4 Canopy cantilever post, see canopy cantilever post detail on S5.12.
- 8) For **Trade Contract 26A – Electrical** – Reference document "22-08.33 ADDENDUM 01 BP02.1" Drawings EUP1.02 and EUP1.04 have been revised which includes the removal of specific floor boxes.
- 9) For **Trade Contract 26A – Electrical** – All conduits shown entering the exclusion zone shall be installed by this trade contract, turned up and capped.
- 10) For **Trade Contract 26A – Electrical** – site temporary power and maintenance are by others.
- 11) For **Trade Contract 26A – Electrical** – Exclude the fabric sub-duct, installed conduits to remain empty.
- 12) For **Trade Contract 26A – Electrical** – Include pull strings in all conduits installed by this contract.
- 13) For **Trade Contract 26A – Electrical** – Concrete encased grounding electrode is by this contract, to be installed in the footing, coordinate with the CM on exact location within the exclusion zone.
- 14) For **Trade Contract 32A – Site Paving** – Dumpster screen footing by this trade contract.
- 15) For **Trade Contract 32A – Site Paving** – Exclude monument sign footing, this footing will be in the signage trade contract in Bid Package #3 to be released in July.

16) For Trade Contract 32A – Site Paving – Assume all concrete paving except for the dumpster pad is 6” unreinforced, reference details.

02-22-08-BP2.1 DRAWINGS – Revised Drawing List

SHEET NUMBER	SHEET TITLE	DATE
EUP1.02	Partial First Floor-Power and Communications Plan	6/24/2026
EUP1.04	Partial First Floor-Power and Communications Plan	6/24/2026

Full Bid Package #2 Link (if link does not work, copy and paste into browser)

<https://crosslandconstruction.box.com/s/sbz2w4w23njuawd9litrhcoedw5bnbp6>

Full link to BP#2 CM Addendum #1 (if link does not work, copy and paste into browser)

<https://crosslandconstruction.box.com/s/fansotozskas6k7gesl4wsycplqzboea>

Enclosures:

22-08.33 ADDENDUM 01 BP02.1

End of CM Addendum #2

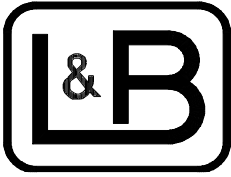

Lee & Browne

Consulting Engineers, Inc.
1207 South Sheridan Road
Tulsa, OK 74112-5405
(918) 836-0271

Addendum #1
Cherokee Nation of Oklahoma
Tahlequah Justice Center

June 24, 2026

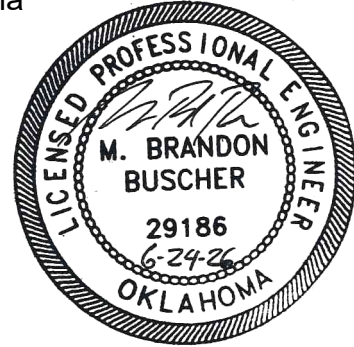

Note: The narrative descriptions below provide a brief summary of the changes along with some clarifying notes. The contractor is responsible for all changes clouded on the drawings whether specifically mentioned below or not.

Electrical:

1. Reference Drawing EUP1.02 – Update power plan per architect's requests.
2. Reference Drawing EUP1.04 – Update power plan per architect's requests.

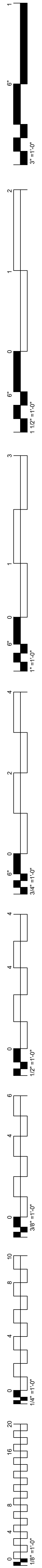

L&B PROJ #2299 CAD/35062 - EPI.02 MAY-18-26

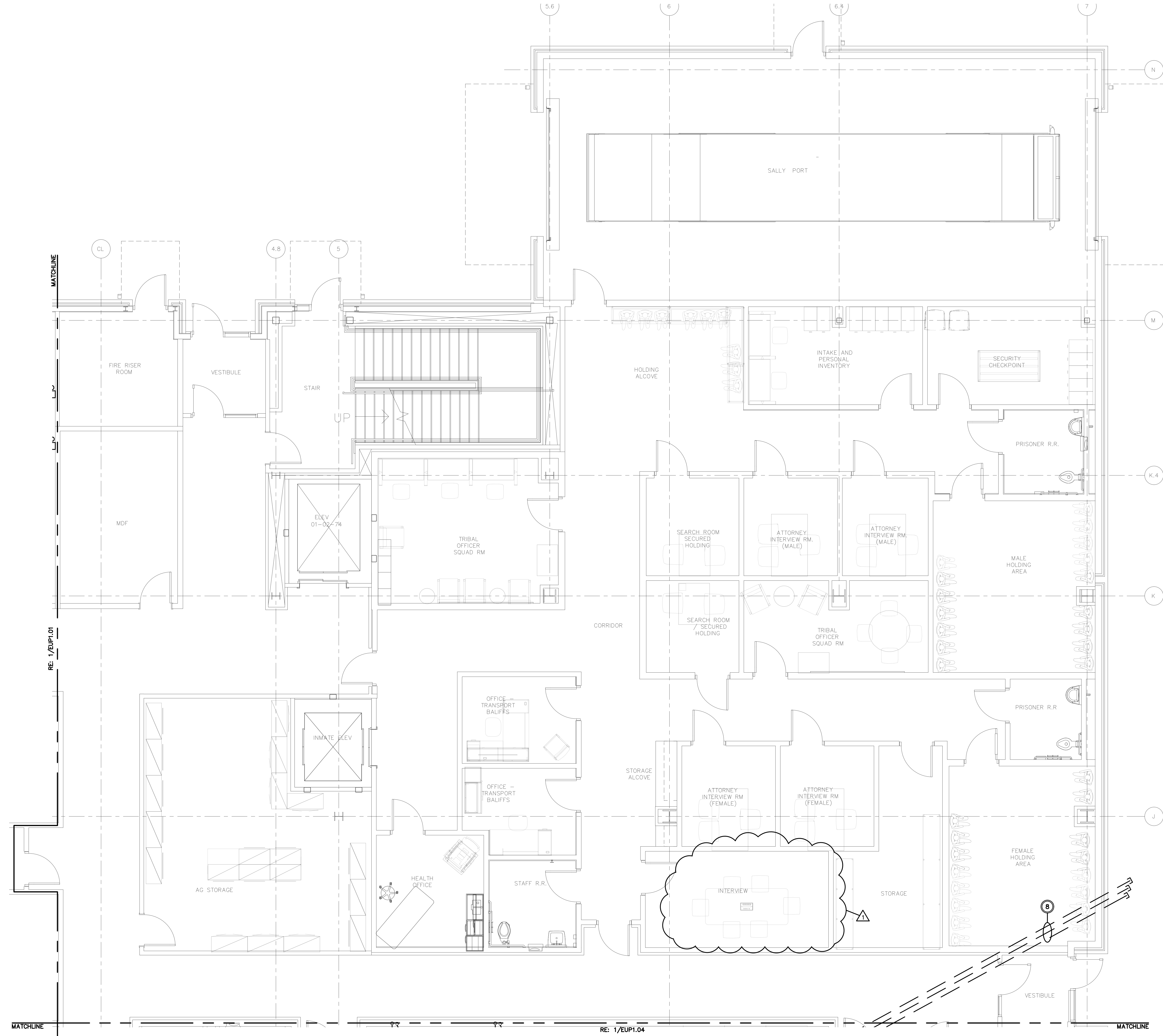

1 PARTIAL FIRST FLOOR - POWER AND COMMUNICATIONS PLAN

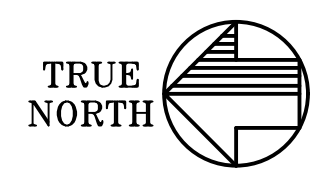
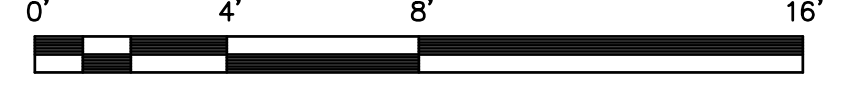

REFER TO SHEET EU0.01 FOR KEYNOTES (K).
 REFER TO SHEET EU0.01 FOR FEEDER NOTES (F).
 REFER TO SHEET EU0.01 FOR FLOOR NOTES (C).



CHILDERS ARCHITECT
 A NATIVE AMERICAN OWNED FIRM

45 South 4th Street
 Fort Smith, AR 72801
 479-783-2480
 www.childersarchitect.com

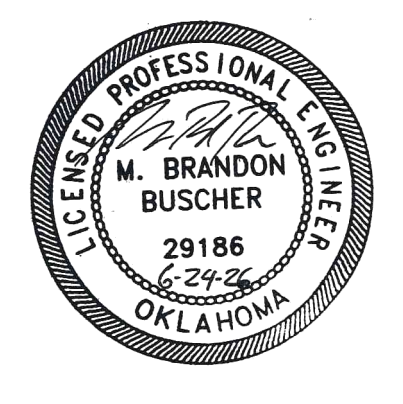

CONSULTANT LOGO

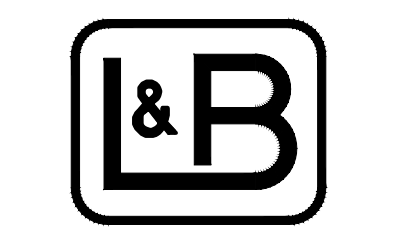

Lee & Browne
 Consulting Engineers, Inc.
 1207 South Sheridan Road
 Tulsa, Oklahoma 74112-5405
 (918) 836-0271
 OKLA CA 252 EXP: 6/27



CHEROKEE NATION JUSTICE CENTER
CHEROKEE NATION
 TAHEQUAH, OKLAHOMA

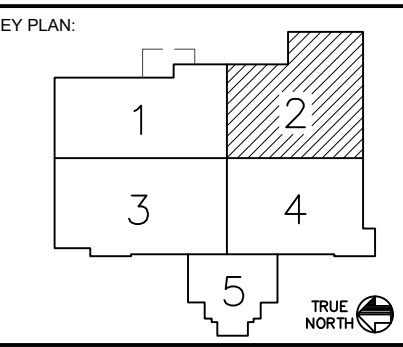

PROJECT PHASE
BP2.1: UNDER SLAB MEP

REVISION	DATE	DESCRIPTION
1	06/24/26	ADDITION #1

JOB NUMBER: 22-08.33
 DATE: 06-10-2026

EUP1.02

SHEET TITLE:
 PARTIAL FIRST FLOOR - POWER AND COMMUNICATIONS PLAN

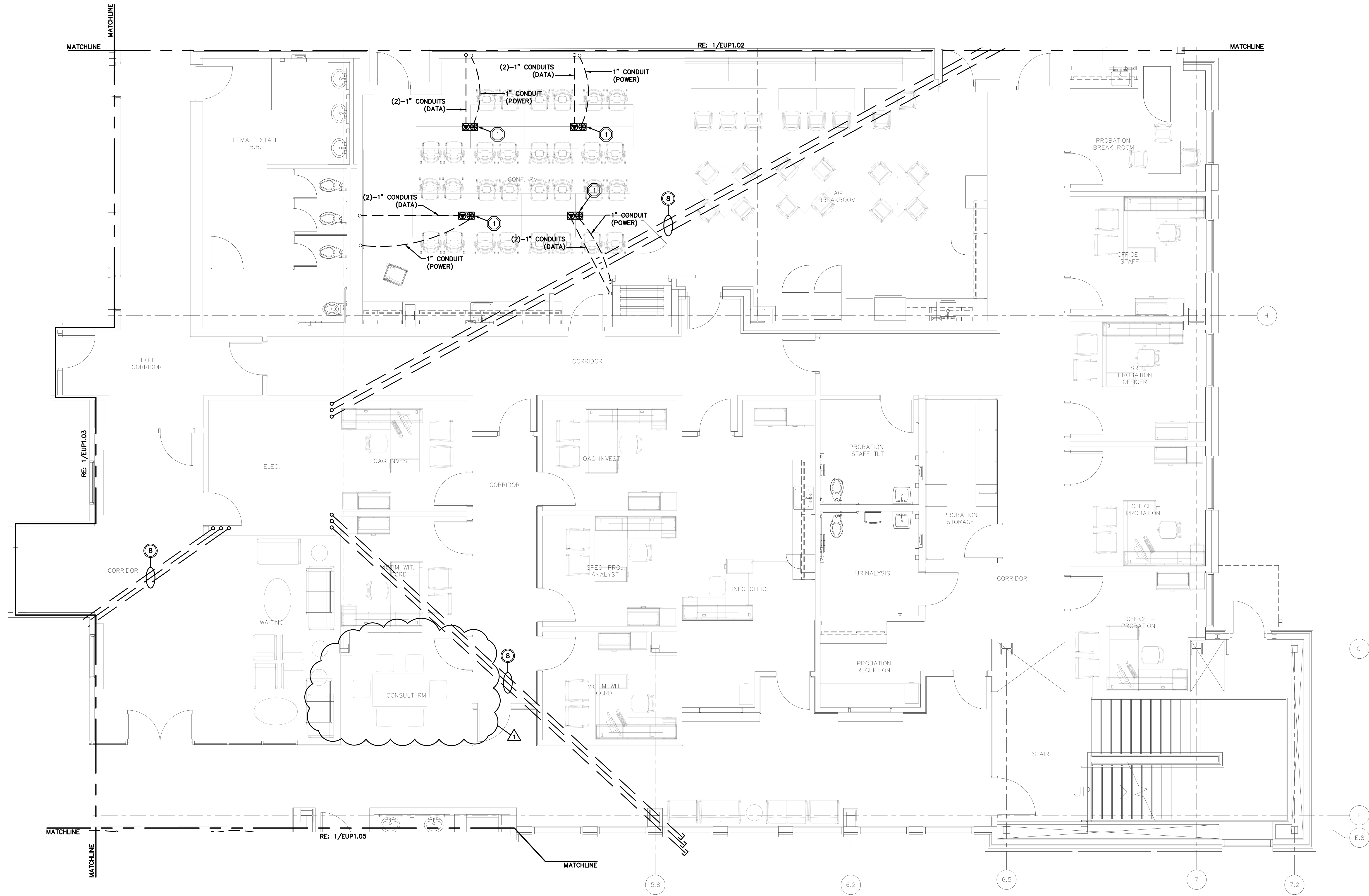
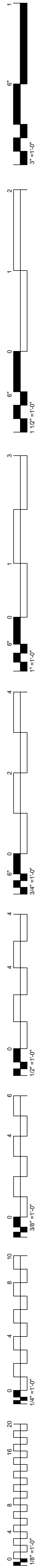

1 PARTIAL FIRST FLOOR - POWER AND COMMUNICATIONS PLAN

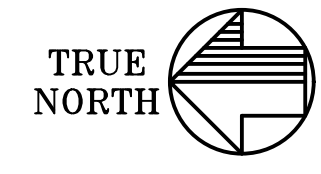
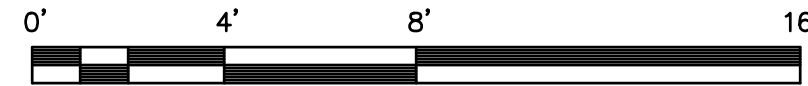

REFER TO SHEET E0.01 FOR KEYNOTES (K).
 REFER TO SHEET E0.01 FOR FEEDER NOTES (F).
 REFER TO SHEET E0.01 FOR FLOOR NOTES (FL).

L&B PROJ #0299 CAD#5062 - EPI.04 MAY-18-26



CHILDERS ARCHITECT
A NATIVE AMERICAN OWNED FIRM

45 South 4th Street
Fort Smith, AR 72801
479-783-2480
www.childersarchitect.com



PROFESSIONAL SEAL



Lee & Browne
Consulting Engineers, Inc.
1207 South Sheridan Road
Tulsa, Oklahoma 74112-5405
(918) 836-0271
OKLA CA 252 EXP: 6/27



CONSULTANT LOGO

CHEROKEE NATION JUSTICE CENTER
CHEROKEE NATION
TAHEQUAH, OKLAHOMA

KEY PLAN



PROJECT PHASE
BP2.1: UNDER SLAB MEP

REVISIONS	DATE	DESCRIPTION

JOB NUMBER: 22-08.33
 DATE: 06-10-2026
 SHEET NUMBER:
EUP1.04

SHEET TITLE:
 PARTIAL FIRST FLOOR - POWER AND COMMUNICATIONS PLAN