



Construction Manager's Clarification

Date: October 18, 2018
RE: CM Clarification #2
Project: Cherokee Hard Rock Casino 4
Signage and Exterior Video Board

This clarification forms a part of the contract documents and modifies the original Construction Manager's Bid Book. Acknowledge receipt of this clarification in the space provided on the Form of Proposal. Failure to do so may subject bidder to disqualification.

The following clarifications are to be included in the scope of work affected:

- Item #1** **Reference Bid Package 10C & 11F** – Please find the attached documents below for updated schedule with updated milestone and durations for Signage and Exterior Video Board.
- Item #2** **Reference Bid Package 10C** – Please reference attached RFI 204 for following updated/clarification information for the signage bid package:
- a. Updated Summary Page
 - b. Revised quantities on summary sheet

CM Clarification #2
Cherokee Hard Rock Casino 4
Signage and LED Video Boards

Flintco, LLC
1624 W. 21st Street
Tulsa, OK 74107
(918) 587-8451

Cherokee Hard Rock Casino 4 092718		Classic Schedule Layout			18-Oct-18 13:03	
Activity ID	Activity Name	Original Duration	Actual Duration	Schedule % Complete	Start	Finish
Cherokee Hard Rock Casino 4 092718		315	207	0%	02-Mar-18 A	04-Mar-19
Milestones		172	88	0%	07-Jul-18 A	01-Feb-19
MS-1000	Structural Steel Arrives (First Delivery)	0	0	100%	07-Jul-18 A	
MS-1030	Structural Steel Erected - Top Out	0	0	100%		05-Sep-18 A
MS-1050	CNE Start Central Plant Upgrade	0	0	0%	18-Oct-18*	
MS-1040	Roof Membrane Complete (weathered in)	0	0	100%		23-Oct-18
MS-1070	Permanent Power Provided	0	0	100%		29-Oct-18
MS-1090	Conditioned Air (90 days = 11-1) TEMP	0	0	0%		31-Oct-18
MS-1010	CNE Complete Central Plant Upgrade	0	0	0%		09-Nov-18*
MS-1100	IT Install Ready(60 Days = 12-1)	0	0	0%	01-Dec-18	
MS-1110	Casino Games Ready to start(45 days = 12-15-18)	0	0	0%	14-Dec-18	
MS-1170	PERMENENT CONDITINED AIR(ANNEXE AIR)	0	0	0%		14-Dec-18
MS-1120	Food and Beverage Start (45 days = 12-17)	0	0	0%	17-Dec-18	
MS-1080	Hardware Installation (90 days prior to completion)	0	0	0%	17-Dec-18	
MS-1160	Cage Rooms Complete (1-2-18)	0	0	0%		02-Jan-19*
MS-1140	Fire Marshall Approval	0	0	0%		25-Jan-19
MS-1060	Building Envelope approved/tested	0	0	0%		30-Jan-19
MS-1150	Casino Opening	0	0	0%		01-Feb-19*
MS-1130	Substantial Completion	0	0	0%		01-Feb-19*
Potential Schedule Impacts		79	80	0%	17-Jul-18 A	23-Oct-18
Preconstruction		284	197	0%	02-Mar-18 A	26-Jan-19
CM Selection		34	34	0%	02-Mar-18 A	18-Apr-18 A
Bid Packages		73	78	0%	19-Mar-18 A	18-Jun-18 A
Submittals, Shop Drawings, & Material Procurement		232	145	0%	02-May-18 A	26-Jan-19
Bid Package 01		0	0	0%		
Bid Package 02		56	42	0%	30-May-18 A	18-Jul-18 A
Bid Package 03		75	63	0%	02-May-18 A	14-Jul-18 A
Bid Package 04		193	129	0%	21-May-18 A	31-Dec-18
Low Voltage Package		135	85	0%	11-Jul-18 A	14-Dec-18
SIGNAGE AND EXT VIDEO BOARDS		87	15	0%	01-Oct-18 A	26-Jan-19
PRE-CON		87	15	0%	01-Oct-18 A	26-Jan-19
A1260	SIGNAGE AND EXT LED BOARD BID PERIOD	15	15	0%	01-Oct-18 A	22-Oct-18
A1270	DESCOPE AND AWARD SIGNAGE AND EXT LED BOARDS	10	0	0%	23-Oct-18	02-Nov-18
A1280	Procure signage submittals	12	0	0%	03-Nov-18	16-Nov-18

Cherokee Hard Rock Casino 4 092718		Classic Schedule Layout				18-Oct-18 13:03		
Activity ID	Activity Name	Original Duration	Actual Duration	Schedule % Complete	Start	Finish		
A1290	Procure Exterior LED board submittals	12	0	0%	03-Nov-18	16-Nov-18		
A1300	Submit and approve signage	10	0	0%	17-Nov-18	28-Nov-18		
A1310	submit and approve ext LED boards	10	0	0%	17-Nov-18	28-Nov-18		
A1320	Ext LED board material procurement	35	0	0%	29-Nov-18	08-Jan-19		
A1330	Signage Material Procurement	25	0	0%	29-Nov-18	27-Dec-18		
CONSTRUCTION		26	0	0%	28-Dec-18	26-Jan-19		
A1340	Interior signage install	6	0	0%	28-Dec-18	03-Jan-19		
A1370	Interior Lighted Signs Install	6	0	0%	04-Jan-19	10-Jan-19		
A1350	Exterior LED sign install	6	0	0%	09-Jan-19	15-Jan-19		
A1360	Exterior LED sign programming and testing	10	0	0%	16-Jan-19	26-Jan-19		
Construction		272	186	0%	27-Mar-18 A	06-Feb-19		
Sitework, Demolition, & Site Utilities		60	176	0%	27-Mar-18 A	18-Oct-18		
Mobilization & Rough Grading		60	176	0%	27-Mar-18 A	18-Oct-18		
C1240	Set Construction Office Trailer	6	3	100%	27-Mar-18 A	30-Mar-18 A		
C1020	Site Mobilization	5	9	100%	27-Mar-18 A	06-Apr-18 A		
C1040	MEP Disconnect and Temp Gas re-feed	5	7	0%	09-Apr-18 A	18-Apr-18 A		
C1000	Demo Existing Structure	15	7	100%	20-Apr-18 A	28-Apr-18 A		
C1030	Utility Relocate & Demo	25	19	100%	27-Apr-18 A	24-May-18 A		
C1010	Set Building Layout & Site Control	2	5	100%	30-Apr-18 A	04-May-18 A		
C1070	Cut / Fill Building Pad	15	20	100%	02-May-18 A	25-May-18 A		
C1080	Storm Drainage	7	8	0%	23-May-18 A	18-Oct-18*		
C1330	Certify Building Pad Grade	1	0	100%	04-Jun-18 A	04-Jun-18 A		
Casino		213	127	0%	04-Jun-18 A	06-Feb-19		
Structural / Foundations		166	117	0%	04-Jun-18 A	13-Dec-18		
Level 1 - Area 2		82	99	0%	04-Jun-18 A	26-Sep-18 A		
A2-1000	Drilled Piers	12	12	100%	04-Jun-18 A	18-Jun-18 A		
A2-1010	Footings & Foundations	10	15	100%	11-Jun-18 A	28-Jun-18 A		
A2-1560	Underground Rough In	10	22	100%	18-Jun-18 A	13-Jul-18 A		
A2-1050	Erect Structural Steel	15	16	100%	16-Jul-18 A	03-Aug-18 A		
A2-1060	Detail Structural Steel	15	23	100%	23-Jul-18 A	17-Aug-18 A		
A2-1070	Prep sub base, rebar, and pour recessed slabs	6	5	0%	06-Aug-18 A	11-Aug-18 A		
A2-1080	CMU Walls Area 2	6	7	0%	06-Aug-18 A	14-Aug-18 A		
A2-1130	Sub Base & Prep Slab	5	6	100%	07-Aug-18 A	13-Aug-18 A		
A2-1550	Slab on Grade 100'	5	7	100%	13-Aug-18 A	20-Aug-18 A		

Cherokee Hard Rock Casino 4 092718		Classic Schedule Layout				18-Oct-18 13:03	
Activity ID	Activity Name	Original Duration	Actual Duration	Schedule % Complete	Start	Finish	
A2-1660	Kitchen rough in stainless	8	14	0%	27-Aug-18 A	11-Sep-18 A	
A2-1100	Build CMU walls to deck and steel bracing	8	13	0%	08-Sep-18 A	26-Sep-18 A	
A2-1710	Kitchen pour backs	5	9	0%	08-Sep-18 A	18-Sep-18 A	
Level 2 - Area 2		44	41	0%	08-Jul-18 A	24-Aug-18 A	
2A2-1040	Erect Structural Steel	10	25	100%	08-Jul-18 A	06-Aug-18 A	
2A2-1530	Core Deck additional time	8	14	0%	31-Jul-18 A	18-Aug-18 A	
2A2-1050	Detail Structural Steel	10	7	100%	06-Aug-18 A	13-Aug-18 A	
2A2-1270	MEP Rough-In SOMD	3	12	100%	11-Aug-18 A	24-Aug-18 A	
2A2-1510	SOMD - Prep & Pour	3	4	100%	20-Aug-18 A	24-Aug-18 A	
Level 1 - Area 1		102	102	0%	11-Jun-18 A	06-Oct-18 A	
A1-1000	Drilled Piers	8	6	100%	11-Jun-18 A	18-Jun-18 A	
A1-1010	Footings & Foundations	10	42	100%	27-Jun-18 A	14-Aug-18 A	
A1-1020	Underground Rough In	10	29	100%	16-Jul-18 A	17-Aug-18 A	
A1-1050	Erect Structural Steel	10	11	100%	06-Aug-18 A	17-Aug-18 A	
A1-1060	Detail Structural Steel	15	11	100%	11-Aug-18 A	24-Aug-18 A	
A1-1670	CMU walls in Area 1	6	5	0%	15-Aug-18 A	22-Aug-18 A	
A1-1580	Prep sub base, rebar, and pour recessed slabs	6	9	0%	21-Aug-18 A	01-Sep-18 A	
A1-1030	Sub Base & Prep Slab	3	27	100%	03-Sep-18 A	03-Oct-18 A	
A1-1680	Safer room slabs in area 1	8	7	0%	12-Sep-18 A	21-Sep-18 A	
A1-1040	Slab on Grade 100'	3	3	100%	04-Oct-18 A	06-Oct-18 A	
Tower		92	43	0%	29-Aug-18 A	13-Dec-18	
T1000	Erect Steel	6	6	0%	29-Aug-18 A	05-Sep-18 A	
T1050	Complete porte cochere foundations	5	9	0%	08-Oct-18 A	23-Oct-18	
T1040	Erect porte cochere steel	8	0	0%	24-Oct-18*	01-Nov-18	
T1010	Light gauge Framing, Sheathing, Waterproofing	8	0	0%	02-Nov-18	13-Nov-18	
T1060	Added steel canopy	5	0	0%	02-Nov-18	07-Nov-18	
T1020	Roofing	5	0	0%	14-Nov-18	20-Nov-18	
T1030	Exterior Clad	15	0	0%	21-Nov-18	13-Dec-18	
Exterior Envelope		147	62	0%	07-Aug-18 A	24-Jan-19	
Level 1 - Area 2		94	61	0%	08-Aug-18 A	26-Dec-18	
A2-1090	Frame Exterior Walls	10	14	100%	08-Aug-18 A	24-Aug-18 A	
A2-1110	Exterior Sheathing & Waterproofing	10	25	100%	11-Aug-18 A	10-Sep-18 A	
A2-1230	Exterior EIFS	20	27	100%	17-Sep-18 A	14-Dec-18	
A2-1570	Exterior Accent Columns Finish	10	21	0%	24-Sep-18 A	26-Dec-18	

Cherokee Hard Rock Casino 4 092718		Classic Schedule Layout			18-Oct-18 13:03	
Activity ID	Activity Name	Original Duration	Actual Duration	Schedule % Complete	Start	Finish
Level 2 - Area 2		143	62	0%	07-Aug-18 A	01-Jan-19
2A2-1070	Fireproofing	5	28	100%	07-Aug-18 A	08-Sep-18 A
2A2-1060	Roof Level Framing & Sheathing	10	13	100%	17-Aug-18 A	31-Aug-18 A
2A2-1110	Install Roof Curbs	3	11	100%	29-Aug-18 A	11-Sep-18 A
2A2-1080	Roofing & Flashings	15	16	100%	31-Aug-18 A	18-Sep-18 A
2A2-1220	Hlgh EIFS	15	15	0%	01-Oct-18 A	01-Jan-19
Level 1 - Area 1		129	49	0%	22-Aug-18 A	24-Jan-19
A1-1100	Frame Exterior Walls	10	9	100%	22-Aug-18 A	01-Sep-18 A
A1-1080	Fireproofing	5	13	100%	23-Aug-18 A	07-Sep-18 A
A1-1110	Exterior Sheathing & Waterproofing	10	47	100%	24-Aug-18 A	18-Oct-18
A1-1070	Roof Level Framing & Sheathing	10	6	100%	04-Sep-18 A	11-Sep-18 A
A1-1120	Install Curbs	3	3	100%	04-Sep-18 A	07-Sep-18 A
A1-1090	Roofing & Flashings	10	23	100%	21-Sep-18 A	23-Oct-18
A1-1230	Exterior EIFS	20	17	100%	28-Sep-18 A	26-Dec-18
A1-1640	Set ALL Annexe Air Units	5	0	0%	14-Nov-18	19-Nov-18
A1-1650	Elect and Mech terminations to annexe aire units	15	0	0%	20-Nov-18	06-Dec-18
A1-1620	Exterior Tile Columns	10	0	0%	15-Dec-18	26-Dec-18
A1-1610	East and south EIFS	20	0	70%	02-Jan-19	24-Jan-19
A1-1630	Exterior Curtainwall & Storefront	10	0	16%	02-Jan-19	12-Jan-19
Interior Rough-In		99	60	0%	21-Aug-18 A	13-Dec-18
Level 1 - Area 2		99	50	0%	21-Aug-18 A	13-Dec-18
A2-1540	Layout Walls	2	4	100%	21-Aug-18 A	25-Aug-18 A
A2-1140	Set Door Frames	5	5	100%	31-Aug-18 A	05-Sep-18 A
A2-1150	Frame Walls	10	17	100%	04-Sep-18 A	24-Sep-18 A
A2-1260	Electrical Wall Rough-In	10	33	100%	10-Sep-18 A	24-Oct-18
A2-1190	Overhead Electrical	15	32	100%	11-Sep-18 A	23-Oct-18
A2-1200	Overhead Plumbing	15	32	100%	11-Sep-18 A	25-Oct-18
A2-1160	Overhead Duct Work	15	27	100%	17-Sep-18 A	23-Oct-18
A2-1170	Overhead Mech Piping	15	27	100%	17-Sep-18 A	23-Oct-18
A2-1210	Overhead Fire Protection	15	18	100%	24-Sep-18 A	15-Oct-18 A
A2-1280	Blocking & Backing	5	11	100%	25-Sep-18 A	08-Oct-18 A
A1-1260	Elevator Rough-In	20	19	100%	26-Sep-18 A	09-Nov-18
A2-1250	Plumbing Wall Rough-In	10	18	100%	27-Sep-18 A	19-Oct-18
A2-1180	Overhead Mech Units	15	9	100%	08-Oct-18 A	09-Nov-18

Cherokee Hard Rock Casino 4 092718		Classic Schedule Layout				18-Oct-18 13:03		
Activity ID	Activity Name	Original Duration	Actual Duration	Schedule % Complete	Start	Finish		
A2-1330	Set Switch Gear	10	9	100%	08-Oct-18 A	29-Oct-18		
A2-1720	Cable Trays all areas	10	3	0%	15-Oct-18 A	18-Oct-18 A		
A2-1240	Mechanical (controls) Wall Rough-In	5	0	100%	18-Oct-18	23-Oct-18		
A2-1220	Overhead Telecomm / Security	10	0	100%	18-Oct-18	29-Oct-18		
A2-1620	Set Generator and Fly Wheel	10	0	0%	18-Oct-18	31-Oct-18		
A2-1320	In-Wall Inspections	1	0	100%	25-Oct-18	25-Oct-18		
A2-1310	Insulation	3	0	100%	26-Oct-18	29-Oct-18		
A2-1370	Terminate Elec & Mech Systems	10	0	100%	10-Nov-18	21-Nov-18		
A2-1610	Paint OTS areas in Area 2	10	0	0%	12-Nov-18	23-Nov-18		
A2-1270	Ceiling Framing AND GRID	10	0	100%	20-Nov-18	30-Nov-18		
A2-1390	Flush Hydronic System	5	0	100%	22-Nov-18	27-Nov-18		
A2-1420	Mechanical Systems Start-up	14	0	28.57%	28-Nov-18	13-Dec-18		
A2-1300	Install Light Fixtures	10	0	100%	01-Dec-18	12-Dec-18		
A2-1290	Install Mech Diffusers	4	0	100%	01-Dec-18	05-Dec-18		
A2-1350	Overhead Inspections	1	0	100%	06-Dec-18	06-Dec-18		
Level 2 - Area 2		79	45	0%	27-Aug-18 A	26-Nov-18		
2A2-1120	Lay Out Walls	2	5	100%	27-Aug-18 A	31-Aug-18 A		
2A2-1140	Frame Walls	5	5	100%	05-Sep-18 A	10-Sep-18 A		
2A2-1130	Set Door Frames	5	3	100%	06-Sep-18 A	10-Sep-18 A		
2A2-1150	Overhead Duct Work	10	33	100%	10-Sep-18 A	20-Oct-18		
2A2-1180	Overhead Electrical	10	33	100%	10-Sep-18 A	29-Oct-18		
2A2-1250	Electrical Wall Rough-In	5	25	100%	10-Sep-18 A	08-Oct-18 A		
2A2-1190	Overhead Plumbing	10	27	100%	17-Sep-18 A	20-Oct-18		
2A2-1200	Overhead Fire Protection	10	5	100%	17-Sep-18 A	22-Sep-18 A		
2A2-1160	Overhead Mech Piping	10	27	100%	17-Sep-18 A	23-Oct-18		
2A2-1310	Insulation	3	11	100%	18-Sep-18 A	01-Oct-18 A		
2A2-1280	Blocking & Backing	3	1	100%	20-Sep-18 A	21-Sep-18 A		
2A2-1330	In-Wall Inspections	1	1	100%	28-Sep-18 A	29-Sep-18 A		
2A2-1170	Overhead Mech Units	10	15	100%	01-Oct-18 A	18-Oct-18 A		
2A2-1230	Mechanical (controls) Wall Rough-In	5	1	100%	01-Oct-18 A	02-Oct-18 A		
2A2-1240	Plumbing Wall Rough-In	8	15	100%	01-Oct-18 A	20-Oct-18		
2A2-1210	Overhead Telecomm / Security	10	3	100%	15-Oct-18 A	29-Oct-18		
2A2-1320	Terminate Elec & Mech Systems	8	0	100%	10-Nov-18	19-Nov-18		
2A2-1260	Ceiling Framing AND GRID	5	0	100%	10-Nov-18	15-Nov-18		

Cherokee Hard Rock Casino 4 092718		Classic Schedule Layout				18-Oct-18 13:03		
Activity ID	Activity Name	Original Duration	Actual Duration	Schedule % Complete	Start	Finish		
2A2-1300	Install Light Fixtures	8	0	87.5%	16-Nov-18	24-Nov-18		
2A2-1290	Install Mech Diffusers	4	0	100%	16-Nov-18	20-Nov-18		
2A2-1350	Overhead Inspections	1	0	0%	26-Nov-18	26-Nov-18		
Level 1 - Area 1		59	43	0%	10-Sep-18 A	04-Dec-18		
A1-1250	Plumbing Wall Rough-In	10	33	100%	10-Sep-18 A	25-Oct-18		
A1-1130	Lay Out Walls	3	2	100%	17-Sep-18 A	19-Sep-18 A		
A1-1150	Frame Walls	10	27	100%	17-Sep-18 A	23-Oct-18		
A1-1140	Set Door Frames	3	27	100%	17-Sep-18 A	20-Oct-18		
A1-1160	Overhead Duct Work	15	24	100%	20-Sep-18 A	09-Nov-18		
A1-1270	Electrical Wall Rough-In	10	21	100%	24-Sep-18 A	09-Nov-18		
A1-1320	Insulation	3	21	100%	24-Sep-18 A	16-Nov-18		
A1-1170	Overhead Mech Piping	15	21	100%	24-Sep-18 A	09-Nov-18		
A1-1290	Blocking & Backing	3	21	100%	24-Sep-18 A	13-Nov-18		
A1-1210	Overhead Fire Protection	15	21	100%	24-Sep-18 A	19-Oct-18		
A1-1180	Overhead Mech Units	15	15	100%	01-Oct-18 A	15-Nov-18		
A1-1200	Overhead Plumbing	15	12	100%	04-Oct-18 A	31-Oct-18		
A1-1240	Mechanical (controls) Wall Rough-In	5	4	100%	13-Oct-18 A	29-Oct-18		
A1-1220	Overhead Telecomm / Security	15	10	100%	18-Oct-18 A	15-Nov-18		
A1-1190	Overhead Electrical	15	0	100%	24-Oct-18	09-Nov-18		
A1-1330	In-Wall Inspections	1	0	100%	10-Nov-18	10-Nov-18		
A1-1310	Install Light Fixtures	15	0	100%	16-Nov-18	03-Dec-18		
A1-1300	Install Mech Diffusers	5	0	100%	16-Nov-18	21-Nov-18		
A1-1280	Ceiling Framing AND GRID	10	0	100%	16-Nov-18	27-Nov-18		
A1-1360	Overhead Inspections	1	0	100%	04-Dec-18	04-Dec-18		
Finishes		114	30	0%	13-Sep-18 A	06-Feb-19		
Level 1 - Area 2		100	21	0%	24-Sep-18 A	25-Jan-19		
A2-1340	Sheetrock Walls	12	21	100%	24-Sep-18 A	31-Oct-18		
A2-1360	Tape & Bed Walls	12	15	100%	01-Oct-18 A	08-Nov-18		
A2-1630	Layout Access Floor Complete	0	0	0%	18-Oct-18*			
A2-1640	Game Floor Rough in and Electrical	10	0	0%	25-Oct-18	07-Nov-18		
A2-1590	Access Floor Installation	10	0	60%	08-Nov-18	19-Nov-18		
A2-1650	Gaming Cabling	10	0	0%	08-Nov-18	21-Nov-18		
A2-1380	Sheetrock Ceilings	8	0	100%	20-Nov-18	28-Nov-18		
A2-1580	Painting - 1st coat	10	0	100%	21-Nov-18	01-Dec-18		

Cherokee Hard Rock Casino 4 092718		Classic Schedule Layout				18-Oct-18 13:03	
Activity ID	Activity Name	Original Duration	Actual Duration	Schedule % Complete	Start	Finish	
A2-1410	Tape & Bed Ceilings	8	0	100%	23-Nov-18	01-Dec-18	
A2-1700	Elevator Install	15	0	0%	27-Nov-18	19-Dec-18	
A2-1400	Tile Walls	12	0	100%	29-Nov-18	12-Dec-18	
A2-1430	Install Ceiling Devices	8	0	12.5%	03-Dec-18	11-Dec-18	
A2-1600	Ceiling tile	6	0	0%	12-Dec-18	19-Dec-18	
A2-1440	Casework	10	0	0%	13-Dec-18	24-Dec-18	
A2-1450	Finish Flooring	8	0	0%	20-Dec-18	28-Dec-18	
A2-1460	Doors, Frames & Hardware	8	0	0%	20-Dec-18	28-Dec-18	
A2-1470	Set Plumbing Fixtures	10	0	0%	25-Dec-18	04-Jan-19	
A2-1480	Test Security System	5	0	0%	29-Dec-18	03-Jan-19	
A2-1670	Casino Games (by Owner)	15	0	0%	29-Dec-18	15-Jan-19	
A2-1490	Toilet Partitions	5	0	0%	05-Jan-19	10-Jan-19	
A2-1500	Test MEP Systems	5	0	0%	05-Jan-19	10-Jan-19	
A2-1680	Terminate Casino Games (by others)	5	0	0%	10-Jan-19	15-Jan-19	
A2-1510	Toilet Accessories	3	0	0%	11-Jan-19	14-Jan-19	
A2-1690	Test Casino Games (by others)	5	0	0%	11-Jan-19	16-Jan-19	
A2-1520	Final Clean	5	0	0%	15-Jan-19	19-Jan-19	
A2-1530	Punch List	5	0	0%	21-Jan-19	25-Jan-19	
Standing Bar & entertainment Area		42	0	0%	08-Nov-18	26-Dec-18	
A1090	Install Steel for Millwork Support in area	5	0	0%	08-Nov-18	13-Nov-18	
A1110	Stain concrete	5	0	0%	14-Nov-18	19-Nov-18	
A1120	Millwork Bases/walls for standing bar and lounge	5	0	0%	20-Nov-18	24-Nov-18	
A1130	Set Countertops	5	0	0%	26-Nov-18	30-Nov-18	
A1160	MEP Rough at millwork	5	0	0%	26-Nov-18	30-Nov-18	
A1140	Finishes/Trim at standing bar and lounge area	12	0	0%	01-Dec-18	14-Dec-18	
A1150	Finishes/Trim at Stage	5	0	0%	15-Dec-18	20-Dec-18	
A1180	Set AV stage Trusses and Equipment	5	0	0%	21-Dec-18	26-Dec-18	
Casino Bar		35	0	0%	14-Nov-18	24-Dec-18	
A1100	Install Steel for millwork	3	0	0%	14-Nov-18	16-Nov-18	
A1170	High trim and bar canopy finishes	6	0	0%	17-Nov-18	23-Nov-18	
A1190	Set Bases/Build Walls	6	0	0%	24-Nov-18	30-Nov-18	
A1200	MEP Rough	5	0	0%	01-Dec-18	06-Dec-18	
A1210	Complete Bar Finishes at Casino bar/Entry to lounge	15	0	0%	07-Dec-18	24-Dec-18	
A1220	Set Countertops	5	0	0%	07-Dec-18	12-Dec-18	

Cherokee Hard Rock Casino 4 092718		Classic Schedule Layout				18-Oct-18 13:03	
Activity ID	Activity Name	Original Duration	Actual Duration	Schedule % Complete	Start	Finish	
Kitchenette		70	0	0%	24-Oct-18	12-Jan-19	
A1-1830	Install Hood	6	0	0%	24-Oct-18	30-Oct-18	
A1-1850	Install Cooler and freezer panels	6	0	0%	31-Oct-18	06-Nov-18	
A1-1890	Install overhead door	5	0	0%	31-Oct-18	05-Nov-18	
A1-1840	MEP Terminations to Hood and coolers	10	0	0%	07-Nov-18	17-Nov-18	
A1-1860	FRP at walls	8	0	0%	19-Nov-18	27-Nov-18	
A1-1870	Ceiling Grid and tile	6	0	0%	28-Nov-18	04-Dec-18	
A1-1880	Resinous flooring	1	0	0%	05-Dec-18	05-Dec-18	
A1-1700	Food and Bev MEP Ready/ Trim out	8	0	0%	06-Dec-18	14-Dec-18	
A1-1600	Owner Food and Beverage Install(45days out)	25	0	0%	15-Dec-18	12-Jan-19	
Level 2 - Area 2		105	30	0%	13-Sep-18 A	26-Jan-19	
2A2-1340	Sheetrock Walls	7	30	100%	13-Sep-18 A	29-Oct-18	
2A2-1360	Tape, Bed Paint Walls	7	0	85.71%	22-Oct-18	29-Oct-18	
2A2-1370	Sheetrock Ceilings	5	0	0%	27-Nov-18	01-Dec-18	
2A2-1380	Tape, Bed, Paint Ceilings	5	0	0%	03-Dec-18	07-Dec-18	
2A2-1400	Install Ceiling Devices	8	0	0%	08-Dec-18	17-Dec-18	
2A2-1390	Tile Walls / Wall Coverings	5	0	0%	08-Dec-18	13-Dec-18	
2A2-1520	Ceiling tile	6	0	0%	17-Dec-18	24-Dec-18	
2A2-1410	Finish Flooring	6	0	0%	25-Dec-18	31-Dec-18	
2A2-1430	Doors, Frames & Hardware	3	0	0%	25-Dec-18	27-Dec-18	
2A2-1470	Test Security System	5	0	0%	28-Dec-18	02-Jan-19	
2A2-1640	Casino Games (by Owner)	15	0	0%	28-Dec-18	14-Jan-19	
2A2-1420	Casework	5	0	0%	01-Jan-19	05-Jan-19	
2A2-1440	Set Plumbing Fixtures	3	0	0%	07-Jan-19	09-Jan-19	
2A2-1650	Terminate Casino Games (by others)	5	0	0%	09-Jan-19	14-Jan-19	
2A2-1450	Toilet Partitions	3	0	0%	10-Jan-19	12-Jan-19	
2A2-1480	Test MEP Systems	5	0	0%	10-Jan-19	15-Jan-19	
2A2-1660	Test Casino Games (by others)	5	0	0%	10-Jan-19	15-Jan-19	
2A2-1490	Toilet Accessories	2	0	0%	14-Jan-19	15-Jan-19	
2A2-1460	Final Clean	5	0	0%	16-Jan-19	21-Jan-19	
2A2-1500	Punch List	5	0	0%	22-Jan-19	26-Jan-19	
Level 1 - Area 1		95	21	0%	24-Sep-18 A	06-Feb-19	
A1-1340	Sheetrock Walls	10	21	100%	24-Sep-18 A	22-Nov-18	
A1-1350	Tape, Bed Walls	10	13	100%	03-Oct-18 A	28-Nov-18	

Cherokee Hard Rock Casino 4 092718		Classic Schedule Layout				18-Oct-18 13:03		
Activity ID	Activity Name	Original Duration	Actual Duration	Schedule % Complete	Start	Finish		
A1-1430	Gaming Cabling	6	0	0%	15-Nov-18	21-Nov-18		
A1-1400	Install Access Floor	10	0	0%	22-Nov-18	03-Dec-18		
A1-1710	Install Overhead Doors	5	0	0%	23-Nov-18	03-Dec-18		
A1-1380	Tile Walls	10	0	100%	29-Nov-18	10-Dec-18		
A1-1370	Sheetrock Ceilings	10	0	30%	01-Dec-18	12-Dec-18		
A1-1390	Tape, Bed, Paint Ceilings	10	0	0%	07-Dec-18	18-Dec-18		
A1-1690	Ceiling Tile	10	0	0%	11-Dec-18	24-Dec-18		
A1-1410	Install Ceiling Devices	15	0	0%	13-Dec-18	29-Dec-18		
A1-1520	Casino Games (by Owner)	10	0	0%	14-Dec-18	25-Dec-18		
A1-1540	Terminate Casino Games (by others)	10	0	0%	14-Dec-18	25-Dec-18		
A1-1550	Test Casino Games (by others)	10	0	0%	15-Dec-18	26-Dec-18		
A1-1440	Finish Flooring	10	0	0%	17-Dec-18	27-Dec-18		
A1-1470	Doors, Frames & Hardware	5	0	0%	17-Dec-18	21-Dec-18		
A1-1420	Electrical Branch Circuits	10	0	0%	19-Dec-18	29-Dec-18		
A1-1660	1st Coat Walls	5	0	0%	19-Dec-18	26-Dec-18		
A1-1460	Hang Theming Elements	20	0	0%	27-Dec-18	18-Jan-19		
A1-1450	Casework	10	0	0%	27-Dec-18	07-Jan-19		
A1-1750	Install AV equipment complete @ all areas	15	0	0%	27-Dec-18	17-Jan-19		
A1-1500	Test Security System	5	0	0%	31-Dec-18	04-Jan-19		
A1-1740	Stone Veneer	10	0	0%	02-Jan-19	15-Jan-19		
A1-1480	Set Plumbing Fixtures	5	0	0%	08-Jan-19	12-Jan-19		
A1-1760	Finish Paint	10	0	0%	09-Jan-19	22-Jan-19		
A1-1490	Toilet Partitions	5	0	0%	14-Jan-19	18-Jan-19		
A1-1510	Test MEP Systems	5	0	0%	14-Jan-19	18-Jan-19		
A1-1720	Install lockers	5	0	0%	14-Jan-19	18-Jan-19		
A1-1730	Wall Coverings	8	0	0%	16-Jan-19	25-Jan-19		
A1-1530	Toilet Accessories	2	0	0%	19-Jan-19	21-Jan-19		
A1-1560	Final Clean	5	0	0%	26-Jan-19	31-Jan-19		
A1-1570	Punch List	5	0	0%	01-Feb-19	06-Feb-19		
IDF ROOM		37	6	0%	05-Oct-18 A	30-Nov-18		
A1-1780	IDF tape and bed complete	5	6	0%	05-Oct-18 A	12-Oct-18 A		
A1-1770	IDF Duct and set Liebert	6	0	0%	19-Oct-18	25-Oct-18		
A1-1790	Complete IDF Ceiling	5	0	0%	26-Oct-18	31-Oct-18		
A1-1800	Complete IDF Access Floor	5	0	0%	02-Nov-18	07-Nov-18		

Cherokee Hard Rock Casino 4 092718		Classic Schedule Layout				18-Oct-18 13:03	
Activity ID	Activity Name	Original Duration	Actual Duration	Schedule % Complete	Start	Finish	
A1-1590	IDF Eq Set and Low V cable terminations Complete	15	0	0%	08-Nov-18	24-Nov-18	
A1-1820	Install AV EQ in Racks	5	0	0%	14-Nov-18	19-Nov-18	
A1-1810	IDF Paint and Finish Make ready for CNE	5	0	0%	26-Nov-18	30-Nov-18	
Area 3 - Tie in work to casino 3/Pedestrian bridge		34	0	0%	18-Oct-18 A	01-Dec-18	
Building Tie-In & Finishes		34	0	0%	18-Oct-18 A	01-Dec-18	
A3-1370	Temporary Partition	5	0	100%	18-Oct-18 A	23-Oct-18	
A3-1380	Demo	3	0	0%	24-Oct-18	26-Oct-18	
A3-1390	Framing	5	0	0%	29-Oct-18	02-Nov-18	
A3-1350	Sheetrock Walls	4	0	0%	03-Nov-18	07-Nov-18	
A3-1360	Tape, Bed Paint Walls	7	0	0%	08-Nov-18	15-Nov-18	
A3-1410	Sheetrock Ceilings	3	0	0%	08-Nov-18	10-Nov-18	
A3-1420	Tape, Bed, Paint Ceilings	5	0	0%	16-Nov-18	21-Nov-18	
A3-1440	Finish Flooring	4	0	0%	22-Nov-18	26-Nov-18	
A3-1480	Doors, Frames & Hardware	2	0	0%	27-Nov-18	28-Nov-18	
A3-1570	Final Clean	2	0	0%	29-Nov-18	30-Nov-18	
A3-1580	Punch List	1	0	0%	01-Dec-18	01-Dec-18	
Paving & Hardscapes		87	0	0%	18-Oct-18	26-Jan-19	
PLT-1010	Sub Base For Parking & Drives	10	0	0%	18-Oct-18	29-Oct-18	
PLT-1020	Curb & Gutter	7	0	0%	30-Oct-18	06-Nov-18	
PLT-1030	Base	2	0	0%	07-Nov-18	08-Nov-18	
PLT-1040	Sidewalks	15	0	0%	07-Nov-18	23-Nov-18	
PLT-1050	Concrete Paving	10	0	0%	09-Nov-18	20-Nov-18	
PLT-1060	Install Light Pole Bases	5	0	0%	24-Nov-18	29-Nov-18	
PLT-1090	Set Light Poles & Terminate	5	0	0%	30-Nov-18	05-Dec-18	
PLT-1080	Front Entry Steps/Ramps	15	0	0%	14-Dec-18	31-Dec-18	
PLT-1070	Irrigation	5	0	0%	27-Dec-18	01-Jan-19	
PLT-1100	Landscaping	15	0	0%	02-Jan-19	18-Jan-19	
PLT-1110	Striping & Signage	2	0	0%	19-Jan-19	21-Jan-19	
PLT-1120	Final Clean Site & Punch	5	0	0%	22-Jan-19	26-Jan-19	
Project Closeout		69	0	0%	14-Dec-18	04-Mar-19	



Request For Information 204

Importance: **High**

Status: **Open**

Cherokee Nation Entertainment Hard Rock Casino 4

Project # 18032

Cooper Flintco, LLC

777 West Cherokee Street
Catoosa, OK 74015

Tel:

RFI #: 204 **Date Created: 10/11/2018**

Answer Company	Answered By	Author Company	Authored By
		Flintco, LLC 1624 West 21st Street Tulsa, OK 74107	Nicole Broceus

Subject	Discipline	Category
Bulletin 20 Signage Clarification		

Question **Date Required: 10/18/2018**

Reference Bulletin 20 and attached sheets:

Please verify on the following in Bulletin 20:

- 1) In Bulletin 20, L-1.0 on the sign type quantity summary says there are 8 of these signs (7 new & 1 existing to relocated) but the message schedule shows 8 new and 1 existing. Please verify how many L-1.0 is correct.
- 2) The sign type quantity summary calls out to provide unit pricing for type B-4.0 but there are no drawings for type B-4.0. There is however drawings for a type B-3.5 but no reference to B-3.5 in the message schedule. Please provide clarification on if B-4.0 and B-3.5 are the same or different type of signage.
- 3) On the drawings in Bulletin 20 there is a 48.2 sign called out on level one but it is not listed on the interior message schedule found in Bulletin 20. Please verify if there is suppose to be a sign at this location and if so what type of signage is required. Please update Interior message schedule if required.
- 4) Please reference attached sheet. There appears to be a discrepancy between the sign type quantity summary and the message schedule itself. Please verify the quantity of each signage type.

Answer **Date Answered:**

- 1) 8 new and 1 existing is correct. The summary page has been updated and is attached.
 - 2) The sign type is B-3.5, it was mislabeled in the summary.
 - 3) Location 48.2 should be a B-1 sign to read "STAFF ONLY". Message schedule has been updated and is attached.
 - 4) Revised quantities on summary sheet. Note that D-1.0 signs are double faced, only 2 signs.
- Bryan Broaddrick - ERA 10/12/2018

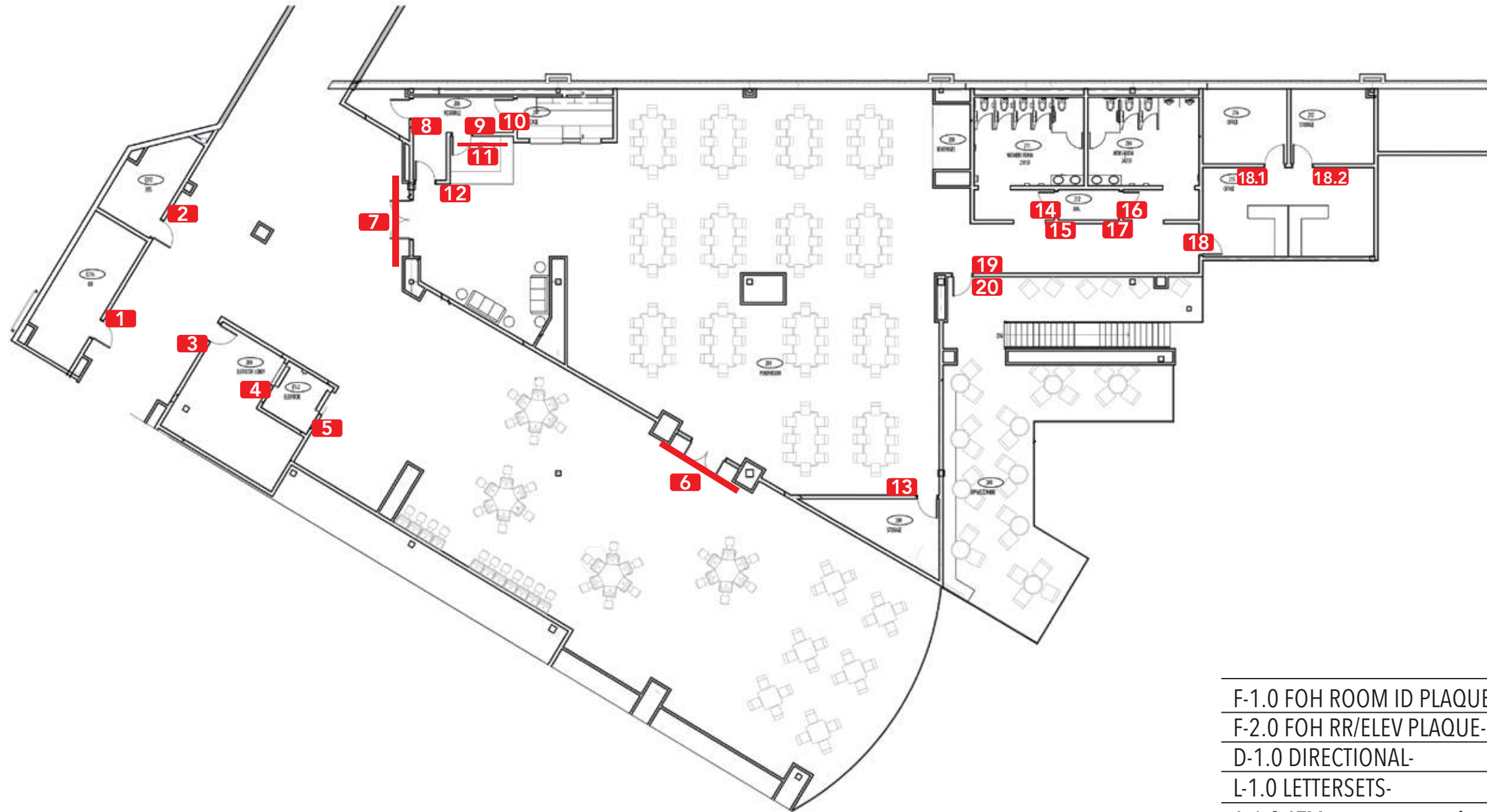

	LVL 1	LVL 2	TOTAL
F-1.0 FOH ROOM ID PLAQUE-	19	12	31
F-2.0 FOH RR/ELEV PLAQUE-	5	3	8
D-1.0 DIRECTIONAL-	2	0	2
L-1.0 LETTERSETS-	6	3	8 new, 1 moves
A-1.0 ATM topper-	give unit price, qty unkown		
B-1.0 BOH ROOM ID PLAQUE-	21	3	24
B-2.0 BOH RR/ELEV PLAQUE-	4	1	5
B-3.0 Info/small-	give unit price, qty unkown		
B-3.5 Info/small-	give unit price, qty unkown		
V-1.0 Entry vinyls-	4	0	4
V-2.0 Misc vinyls-	8	0	8
TOTAL	69	22	91



11810 S. OSWEGO AVE
TULSA, OK 74137
PH: (918) 645 - 5132

DETAILS SHOWN ARE SUGGESTED FABRICATION METHODS TO ACHIEVE AN OVERALL VISUAL AESTHETIC. FABRICATORS MAY OFFER ALTERNATIVE FABRICATION TECHNIQUES FOR REVIEW WHICH ACHIEVE THE SAME VISUAL INTENT. NO VISUAL CHANGES WILL BE ACCEPTABLE. FABRICATORS MUST SUBMIT DETAILED SHOP DRAWINGS FOR REVIEW/APPROVAL PRIOR TO FABRICATION.

PROJECT/CLIENT NAME:
**HARD ROCK CASINO-
EXPANSION**

ACCOUNT EXECUTIVE:
MELISSA MIRSAEDI
DESIGNER:
JOE KESTERSON

LOCATION:
CATOOSA, OK
DATE OF ORIGINAL DWG:
JUNE 27, 2018

REVISION HISTORY:
06.27.18 V 1.0

2

SHEET:

**INTERIOR
SLP- LEVEL TWO**

INTERIOR MESSAGE SCHEDULE-CASINO 4

LOC	FLOOR	FOH/BOH	SIGN TYPE	MESSAGE	ADDITIONAL INFO/NOTES
01	LEVEL 1	FOH	V-1.0	(hard rock logo door vinyls)	
02	LEVEL 1	FOH	V-1.0	(hard rock logo door vinyls)	
03a	LEVEL 1	FOH	D-1.0	→ MULTI-PURPOSE ROOM (NEED FINAL NAME FROM CLIENT) ↗ RESTROOM ↑ COUNTRY BAR (NEED FINAL NAME FROM CLIENT) ↑ CASHIER ↑ SMOKE SHOP ↑ RESTAURANTS	
03b	LEVEL 1	FOH	D-1.0	← MULTI-PURPOSE ROOM (NEED FINAL NAME FROM CLIENT) ↖ COAT CHECK	
04	LEVEL 1	FOH	L-1.0	BEVERAGES	
05	LEVEL 1	FOH	F-1.0	ELECTRICAL	
06	LEVEL 1	FOH	L-1.0	CASHIER	
07	LEVEL 1	FOH	F-1.0	STAFF ONLY	
07.1	LEVEL 1	FOH	F-1.0	CAGE	
07.2	LEVEL 1	FOH	F-1.0	TECH ROOM	
08	LEVEL 1	FOH	V-1.0	(hard rock logo door vinyls)	
09	LEVEL 1	FOH	V-1.0	(hard rock logo door vinyls)	
10	LEVEL 1	FOH	L-1.0	SMOKE SHOP	
11	LEVEL 1	FOH	F-1.0	STAFF ONLY	
12a	LEVEL 1	FOH	D-1.0	← ELEVATOR ↖ RESTROOM ↗ COUNTRY BAR (NEED FINAL NAME FROM CLIENT) → CASHIER → SMOKE SHOP → MULTI-PURPOSE ROOM (NEED FINAL NAME FROM CLIENT)	
12b	LEVEL 1	FOH	D-1.0	↑ RESTAURANTS ↑ THE JOINT → ELEVATOR ← SMOKE SHOP ← CASHIER	

INTERIOR MESSAGE SCHEDULE-CASINO 4

LOC	FLOOR	FOH/BOH	SIGN TYPE	MESSAGE	ADDITIONAL INFO/NOTES
13	LEVEL 1	FOH	F-1.0	STAFF ONLY	
14	LEVEL 1	FOH	F-2.0	(ELEVATOR PLAQUE) IN CASE OF FIRE DO NOT USE ELEVATOR USE STAIRS	
15	LEVEL 1	FOH	F-1.0	ELECTRICAL	
16	LEVEL 1	FOH	F-2.0	MEN (RESTROOM PLAQUE)	
17	LEVEL 1	FOH	F-1.0	HOUSEKEEPING	
18	LEVEL 1	FOH	L-1.0	RESTROOM	
19	LEVEL 1	FOH	F-1.0	HOUSEKEEPING	
20	LEVEL 1	FOH	F-2.0	WOMEN (RESTROOM PLAQUE)	
21	LEVEL 1	FOH	L-1.0	(BAR SIGN- UNKOWN AT THIS TIME- DO NOT BID)	
22	LEVEL 1	FOH	L-1.0	(BAR SIGN- UNKOWN AT THIS TIME- DO NOT BID)	
23	LEVEL 1	FOH	L-1.0	(BAR SIGN- UNKOWN AT THIS TIME- DO NOT BID)	
24	LEVEL 1	FOH	F-1.0	STAFF ONLY	
25	LEVEL 1	FOH	F-2.0	WOMEN (RESTROOM PLAQUE)	
26	LEVEL 1	FOH	F-1.0	HOUSEKEEPING	
27	LEVEL 1	FOH	L-1.0	RESTROOM	
28	LEVEL 1	FOH	F-1.0	HOUSEKEEPING	
29	LEVEL 1	FOH	F-2.0	MEN (RESTROOM PLAQUE)	
30	LEVEL 1	FOH	F-1.0	STAFF ONLY	
31	LEVEL 1	FOH	L-1.0	CONCESSION	
32	LEVEL 1	FOH	F-1.0	STAFF ONLY	
33	LEVEL 1	BOH	B-1.0	STAFF ONLY	
34	LEVEL 1	BOH	B-1.0	STAFF ONLY	
35	LEVEL 1	BOH	B-1.0	STAFF ONLY	
36.1	LEVEL 1	BOH	V-2.0	STAFF ONLY BEYOND THIS POINT	
36.2	LEVEL 1	BOH	V-2.0	OUT (LEFT DOOR) IN (RIGHT DOOR)	
37	LEVEL 1	BOH	B-1.0	MULTI-PURPOSE ROOM (NEED FINAL NAME FROM CLIENT)	
38	LEVEL 1	BOH	B-1.0	STAFF ONLY	

INTERIOR MESSAGE SCHEDULE-CASINO 4

LOC	FLOOR	FOH/BOH	SIGN TYPE	MESSAGE	ADDITIONAL INFO/NOTES
39.1	LEVEL 1	BOH	V-2.0	OUT (LEFT DOOR) IN (RIGHT DOOR)	
39.2	LEVEL 1	BOH	V-2.0	STAFF ONLY BEYOND THIS POINT	
40	LEVEL 1	BOH	B-1.0	MULTI-PURPOSE ROOM (NEED FINAL NAME FROM CLIENT)	
41.1	LEVEL 1	BOH	V-2.0	OUT (LEFT DOOR) IN (RIGHT DOOR)	
41.2	LEVEL 1	BOH	V-2.0	STAFF ONLY BEYOND THIS POINT	
42	LEVEL 1	BOH	B-1.0	MULTI-PURPOSE ROOM (NEED FINAL NAME FROM CLIENT)	
43.1	LEVEL 1	BOH	V-2.0	OUT (LEFT DOOR) IN (RIGHT DOOR)	
43.2	LEVEL 1	BOH	V-2.0	STAFF ONLY BEYOND THIS POINT	
44	LEVEL 1	BOH	B-1.0	MULTI-PURPOSE ROOM (NEED FINAL NAME FROM CLIENT)	
45	LEVEL 1	BOH	B-1.0	STORAGE	
46	LEVEL 1	BOH	B-1.0	STORAGE	
46.1	LEVEL 1	BOH	B-1.0	BIB ROOM	
47	LEVEL 1	BOH	B-1.0	IDF	
48	LEVEL 1	BOH	B-1.0	GREEN ROOM	
48.1	LEVEL 1	BOH	B-2.0	UNI-SEX (RESTROOM PLAQUE)	
48.2	LEVEL 1	BOH	B-1.0	STAFF ONLY	
49	LEVEL 1	FOH	F-1.0	STAFF ONLY	
50	LEVEL 1	FOH	F-1.0	SOUND BOOTH	
51	LEVEL 1	FOH	F-1.0	HOUSEKEEPING	
52	LEVEL 1	FOH	F-1.0	FOOD STAGING	
53	LEVEL 1	FOH	F-1.0	STAFF ONLY	
54	LEVEL 1	BOH	B-1.0	STAFF ONLY	
55	LEVEL 1	BOH	B-1.0	KITCHENET	
56	LEVEL 1	BOH	B-1.0	HOUSEKEEPING	
57	LEVEL 1	FOH	B-2.0	WOMEN (RESTROOM PLAQUE)	
58	LEVEL 1	FOH	B-2.0	MEN (RESTROOM PLAQUE)	
59	LEVEL 1	BOH	B-1.0	STAFF ONLY	
60	LEVEL 1	BOH	B-1.0	HOUSEKEEPING	

INTERIOR MESSAGE SCHEDULE-CASINO 4

LOC	FLOOR	FOH/BOH	SIGN TYPE	MESSAGE	ADDITIONAL INFO/NOTES
61	LEVEL 1	BOH	B-1.0	EVS	
62	LEVEL 1	BOH	B-1.0	ELEVATOR MECHANICAL	
63	LEVEL 1	BOH	B-2.0	(ELEVATOR PLAQUE) IN CASE OF FIRE DO NOT USE ELEVATOR USE STAIRS	
LEVEL TWO					
1	LEVEL 2	FOH	F-1.0	IDF	
2	LEVEL 2	FOH	F-1.0	EVS	
3	LEVEL 2	FOH	F-1.0	STAFF ONLY	
4	LEVEL 1	BOH	B-2.0	(ELEVATOR PLAQUE) IN CASE OF FIRE DO NOT USE ELEVATOR USE STAIRS	
5	LEVEL 1	FOH	F-2.0	(ELEVATOR PLAQUE) IN CASE OF FIRE DO NOT USE ELEVATOR USE STAIRS	
6	LEVEL 2	FOH	L-1.0	POKER (NEW SIGN)	
7	LEVEL 2	FOH	L-1.0	POKER (RE-LOCATE SIGN FROM CURRENT POKER ROOM)	
8	LEVEL 2	BOH	B-1.0	(NEED NAME OF ROOM)	
9	LEVEL 2	BOH	B-1.0	DESK	
10	LEVEL 2	BOH	B-1.0	CAGE	
11	LEVEL 2	FOH	L-1.0	CHECK IN (NEED CONFIRMATION OF NAME)	
12	LEVEL 2	FOH	F-1.0	STAFF ONLY	
13	LEVEL 2	FOH	F-1.0	STORAGE	
14	LEVEL 1	FOH	F-1.0	HOUSEKEEPING	
15	LEVEL 1	FOH	F-2.0	WOMEN (RESTROOM PLAQUE)	
16	LEVEL 1	FOH	F-1.0	HOUSEKEEPING	
17	LEVEL 1	FOH	F-2.0	MEN (RESTROOM PLAQUE)	
18	LEVEL 2	FOH	F-1.0	OFFICE (NEED CONFIRMATION)	
18.1	LEVEL 2	FOH	F-1.0	OFFICE	
18.2	LEVEL 2	FOH	F-1.0	STORAGE	
19	LEVEL 2	FOH	F-1.0	VIP	
20	LEVEL 2	FOH	F-1.0	POKER	