



**Request For Information 204**

Importance: **High**

Status: **Open**

**Cherokee Nation Entertainment Hard Rock  
Casino 4**

**Project # 18032**

**Cooper Flintco, LLC**

777 West Cherokee Street  
Catoosa, OK 74015

Tel:

**RFI #: 204** **Date Created: 10/11/2018**

| Answer Company | Answered By | Author Company   | Authored By    |
|----------------|-------------|--|----------------|
|                |             | Flintco, LLC<br>1624 West 21st Street<br>Tulsa, OK 74107 | Nicole Broceus |

| Subject                           | Discipline | Category |
|-----------------------------------|------------|----------|
| Bulletin 20 Signage Clarification |            |          |

**Question** **Date Required: 10/18/2018**

Reference Bulletin 20 and attached sheets:

Please verify on the following in Bulletin 20:

- 1) In Bulletin 20, L-1.0 on the sign type quantity summary says there are 8 of these signs (7 new & 1 existing to relocated) but the message schedule shows 8 new and 1 existing. Please verify how many L-1.0 is correct.
- 2) The sign type quantity summary calls out to provide unit pricing for type B-4.0 but there are no drawings for type B-4.0. There is however drawings for a type B-3.5 but no reference to B-3.5 in the message schedule. Please provide clarification on if B-4.0 and B-3.5 are the same or different type of signage.
- 3) On the drawings in Bulletin 20 there is a 48.2 sign called out on level one but it is not listed on the interior message schedule found in Bulletin 20. Please verify if there is suppose to be a sign at this location and if so what type of signage is required. Please update Interior message schedule if required.
- 4) Please reference attached sheet. There appears to be a discrepancy between the sign type quantity summary and the message schedule itself. Please verify the quantity of each signage type.

**Answer** **Date Answered:**

- 1) 8 new and 1 existing is correct. The summary page has been updated and is attached.
  - 2) The sign type is B-3.5, it was mislabeled in the summary.
  - 3) Location 48.2 should be a B-1 sign to read "STAFF ONLY". Message schedule has been updated and is attached.
  - 4) Revised quantities on summary sheet. Note that D-1.0 signs are double faced, only 2 signs.
- Bryan Broaddrick - ERA 10/12/2018

|       | Level 1 | level 2 | total |
|-------|---------|---------|-------|
| F-1.0 | 19      | 12      | 31    |
| F-2.0 | 5       | 3       | 8     |
| D-1.0 | 4       | 0       | 4     |
| L1.0  | 6       | 3       | 9     |
| B-1.0 | 20      | 3       | 23    |
| B-2.0 | 4       | 1       | 5     |
| V-1.0 | 4       | 0       | 4     |
| V-2.0 | 8       | 0       | 8     |
| Total | 70      | 22      | 92    |

1 relocate 8 new

A/E  
Verify

Missing Sign type 48.2 on  
interior message schedule and  
sign type quantity summary

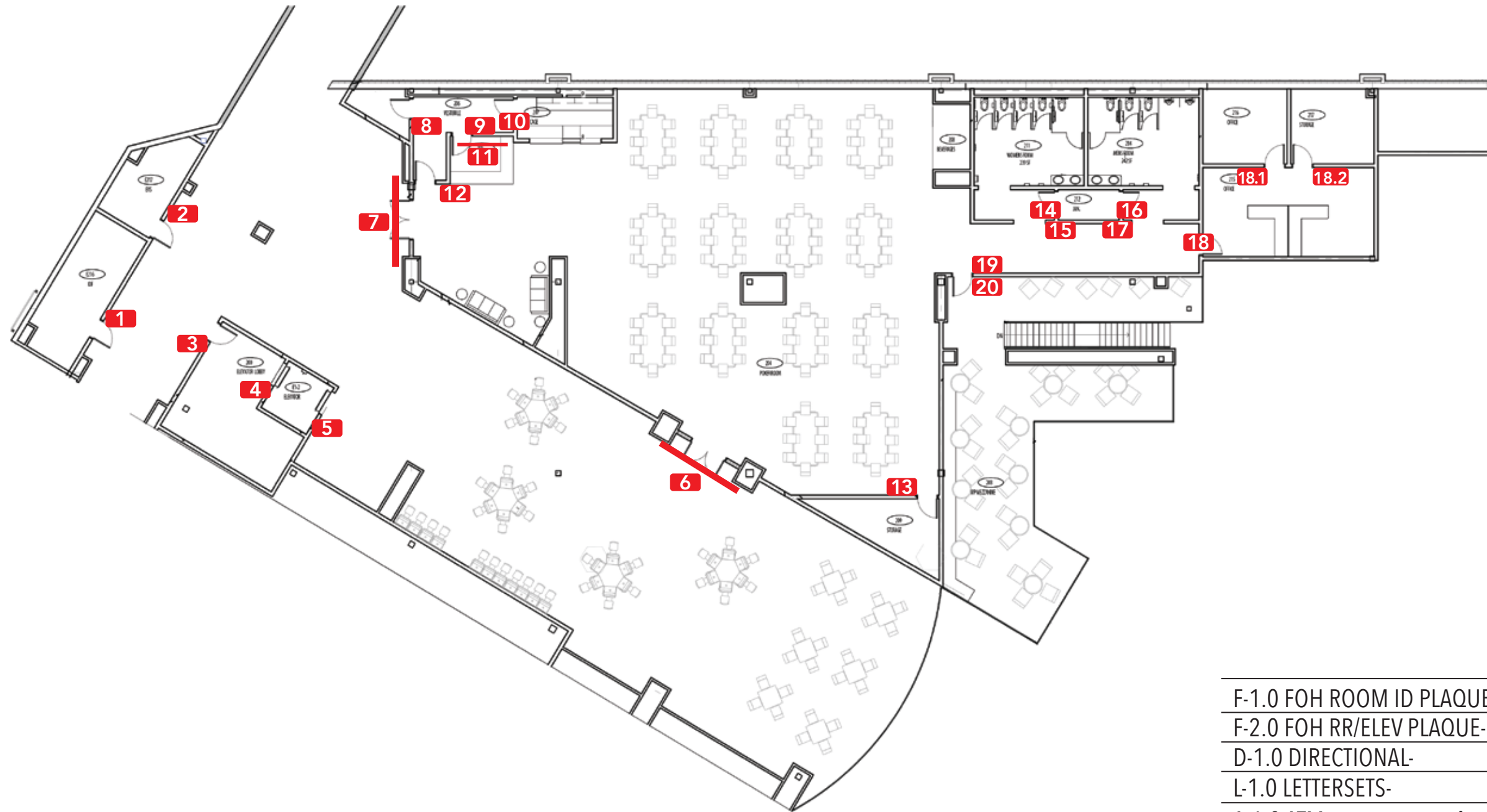

|                           | LVL 1                       | LVL 2     | TOTAL          |
|---------------------------|-----------------------------|-----------|----------------|
| F-1.0 FOH ROOM ID PLAQUE- | 19                          | 12        | 31             |
| F-2.0 FOH RR/ELEV PLAQUE- | 5                           | 3         | 8              |
| D-1.0 DIRECTIONAL-        | 2                           | 0         | 2              |
| L-1.0 LETTERSETS-         | 6                           | 3         | 8 new, 1 moves |
| A-1.0 ATM topper-         | give unit price, qty unkown |           |                |
| B-1.0 BOH ROOM ID PLAQUE- | 21                          | 3         | 24             |
| B-2.0 BOH RR/ELEV PLAQUE- | 4                           | 1         | 5              |
| B-3.0 Info/small-         | give unit price, qty unkown |           |                |
| B-3.5 Info/small-         | give unit price, qty unkown |           |                |
| V-1.0 Entry vinyls-       | 4                           | 0         | 4              |
| V-2.0 Misc vinyls-        | 8                           | 0         | 8              |
| <b>TOTAL</b>              | <b>69</b>                   | <b>22</b> | <b>91</b>      |



11810 S. OSWEGO AVE  
TULSA, OK 74137  
PH: (918) 645 - 5132

DETAILS SHOWN ARE SUGGESTED FABRICATION METHODS TO ACHIEVE AN OVERALL VISUAL AESTHETIC. FABRICATORS MAY OFFER ALTERNATIVE FABRICATION TECHNIQUES FOR REVIEW WHICH ACHIEVE THE SAME VISUAL INTENT. NO VISUAL CHANGES WILL BE ACCEPTABLE. FABRICATORS MUST SUBMIT DETAILED SHOP DRAWINGS FOR REVIEW/APPROVAL PRIOR TO FABRICATION.

PROJECT/CLIENT NAME:  
**HARD ROCK CASINO-  
EXPANSION**

ACCOUNT EXECUTIVE:  
**MELISSA MIRSAEDI**  
DESIGNER:  
**JOE KESTERSON**

LOCATION:  
**CATOOSA, OK**  
DATE OF ORIGINAL DWG:  
**JUNE 27, 2018**

REVISION HISTORY:  
06.27.18 V 1.0

**2**

SHEET:

**INTERIOR  
SLP- LEVEL TWO**

INTERIOR MESSAGE SCHEDULE-CASINO 4

| LOC  | FLOOR   | FOH/BOH | SIGN TYPE | MESSAGE   | ADDITIONAL INFO/NOTES |
|------|---------|---------|-----------|---|-----------------------|
| 01   | LEVEL 1 | FOH     | V-1.0     | (hard rock logo door vinyls)  |                       |
| 02   | LEVEL 1 | FOH     | V-1.0     | (hard rock logo door vinyls)  |                       |
| 03a  | LEVEL 1 | FOH     | D-1.0     | → MULTI-PURPOSE ROOM (NEED FINAL NAME FROM CLIENT)<br>↗ RESTROOM<br>↑ COUNTRY BAR (NEED FINAL NAME FROM CLIENT)<br>↑ CASHIER<br>↑ SMOKE SHOP<br>↑ RESTAURANTS |                       |
| 03b  | LEVEL 1 | FOH     | D-1.0     | ← MULTI-PURPOSE ROOM (NEED FINAL NAME FROM CLIENT)<br>↖ COAT CHECK  |                       |
| 04   | LEVEL 1 | FOH     | L-1.0     | BEVERAGES   |                       |
| 05   | LEVEL 1 | FOH     | F-1.0     | ELECTRICAL  |                       |
| 06   | LEVEL 1 | FOH     | L-1.0     | CASHIER   |                       |
| 07   | LEVEL 1 | FOH     | F-1.0     | STAFF ONLY  |                       |
| 07.1 | LEVEL 1 | FOH     | F-1.0     | CAGE  |                       |
| 07.2 | LEVEL 1 | FOH     | F-1.0     | TECH ROOM   |                       |
| 08   | LEVEL 1 | FOH     | V-1.0     | (hard rock logo door vinyls)  |                       |
| 09   | LEVEL 1 | FOH     | V-1.0     | (hard rock logo door vinyls)  |                       |
| 10   | LEVEL 1 | FOH     | L-1.0     | SMOKE SHOP  |                       |
| 11   | LEVEL 1 | FOH     | F-1.0     | STAFF ONLY  |                       |
| 12a  | LEVEL 1 | FOH     | D-1.0     | ← ELEVATOR<br>↖ RESTROOM<br>↗ COUNTRY BAR (NEED FINAL NAME FROM CLIENT)<br>→ CASHIER<br>→ SMOKE SHOP<br>→ MULTI-PURPOSE ROOM (NEED FINAL NAME FROM CLIENT)    |                       |
| 12b  | LEVEL 1 | FOH     | D-1.0     | ↑ RESTAURANTS<br>↑ THE JOINT<br>→ ELEVATOR<br>← SMOKE SHOP<br>← CASHIER   |                       |

## INTERIOR MESSAGE SCHEDULE-CASINO 4

| LOC  | FLOOR   | FOH/BOH | SIGN TYPE | MESSAGE  | ADDITIONAL INFO/NOTES |
|------|---------|---------|-----------|--|-----------------------|
| 13   | LEVEL 1 | FOH     | F-1.0     | STAFF ONLY   |                       |
| 14   | LEVEL 1 | FOH     | F-2.0     | (ELEVATOR PLAQUE) IN CASE OF FIRE DO NOT USE ELEVATOR USE STAIRS |                       |
| 15   | LEVEL 1 | FOH     | F-1.0     | ELECTRICAL   |                       |
| 16   | LEVEL 1 | FOH     | F-2.0     | MEN (RESTROOM PLAQUE)  |                       |
| 17   | LEVEL 1 | FOH     | F-1.0     | HOUSEKEEPING   |                       |
| 18   | LEVEL 1 | FOH     | L-1.0     | RESTROOM   |                       |
| 19   | LEVEL 1 | FOH     | F-1.0     | HOUSEKEEPING   |                       |
| 20   | LEVEL 1 | FOH     | F-2.0     | WOMEN (RESTROOM PLAQUE)  |                       |
| 21   | LEVEL 1 | FOH     | L-1.0     | (BAR SIGN- UNKOWN AT THIS TIME- DO NOT BID)                      |                       |
| 22   | LEVEL 1 | FOH     | L-1.0     | (BAR SIGN- UNKOWN AT THIS TIME- DO NOT BID)                      |                       |
| 23   | LEVEL 1 | FOH     | L-1.0     | (BAR SIGN- UNKOWN AT THIS TIME- DO NOT BID)                      |                       |
| 24   | LEVEL 1 | FOH     | F-1.0     | STAFF ONLY   |                       |
| 25   | LEVEL 1 | FOH     | F-2.0     | WOMEN (RESTROOM PLAQUE)  |                       |
| 26   | LEVEL 1 | FOH     | F-1.0     | HOUSEKEEPING   |                       |
| 27   | LEVEL 1 | FOH     | L-1.0     | RESTROOM   |                       |
| 28   | LEVEL 1 | FOH     | F-1.0     | HOUSEKEEPING   |                       |
| 29   | LEVEL 1 | FOH     | F-2.0     | MEN (RESTROOM PLAQUE)  |                       |
| 30   | LEVEL 1 | FOH     | F-1.0     | STAFF ONLY   |                       |
| 31   | LEVEL 1 | FOH     | L-1.0     | CONCESSION   |                       |
| 32   | LEVEL 1 | FOH     | F-1.0     | STAFF ONLY   |                       |
| 33   | LEVEL 1 | BOH     | B-1.0     | STAFF ONLY   |                       |
| 34   | LEVEL 1 | BOH     | B-1.0     | STAFF ONLY   |                       |
| 35   | LEVEL 1 | BOH     | B-1.0     | STAFF ONLY   |                       |
| 36.1 | LEVEL 1 | BOH     | V-2.0     | STAFF ONLY BEYOND THIS POINT                                     |                       |
| 36.2 | LEVEL 1 | BOH     | V-2.0     | OUT (LEFT DOOR) IN (RIGHT DOOR)                                  |                       |
| 37   | LEVEL 1 | BOH     | B-1.0     | MULTI-PURPOSE ROOM (NEED FINAL NAME FROM CLIENT)                 |                       |
| 38   | LEVEL 1 | BOH     | B-1.0     | STAFF ONLY   |                       |
|      |         |         |           |  |                       |

## INTERIOR MESSAGE SCHEDULE-CASINO 4

| LOC  | FLOOR   | FOH/BOH | SIGN TYPE | MESSAGE  | ADDITIONAL INFO/NOTES |
|------|---------|---------|-----------|--|-----------------------|
| 39.1 | LEVEL 1 | BOH     | V-2.0     | OUT (LEFT DOOR) IN (RIGHT DOOR)                  |                       |
| 39.2 | LEVEL 1 | BOH     | V-2.0     | STAFF ONLY BEYOND THIS POINT                     |                       |
| 40   | LEVEL 1 | BOH     | B-1.0     | MULTI-PURPOSE ROOM (NEED FINAL NAME FROM CLIENT) |                       |
| 41.1 | LEVEL 1 | BOH     | V-2.0     | OUT (LEFT DOOR) IN (RIGHT DOOR)                  |                       |
| 41.2 | LEVEL 1 | BOH     | V-2.0     | STAFF ONLY BEYOND THIS POINT                     |                       |
| 42   | LEVEL 1 | BOH     | B-1.0     | MULTI-PURPOSE ROOM (NEED FINAL NAME FROM CLIENT) |                       |
| 43.1 | LEVEL 1 | BOH     | V-2.0     | OUT (LEFT DOOR) IN (RIGHT DOOR)                  |                       |
| 43.2 | LEVEL 1 | BOH     | V-2.0     | STAFF ONLY BEYOND THIS POINT                     |                       |
| 44   | LEVEL 1 | BOH     | B-1.0     | MULTI-PURPOSE ROOM (NEED FINAL NAME FROM CLIENT) |                       |
| 45   | LEVEL 1 | BOH     | B-1.0     | STORAGE  |                       |
| 46   | LEVEL 1 | BOH     | B-1.0     | STORAGE  |                       |
| 46.1 | LEVEL 1 | BOH     | B-1.0     | BIB ROOM   |                       |
| 47   | LEVEL 1 | BOH     | B-1.0     | IDF  |                       |
| 48   | LEVEL 1 | BOH     | B-1.0     | GREEN ROOM                                       |                       |
| 48.1 | LEVEL 1 | BOH     | B-2.0     | UNI-SEX (RESTROOM PLAQUE)                        |                       |
| 48.2 | LEVEL 1 | BOH     | B-1.0     | STAFF ONLY                                       |                       |
| 49   | LEVEL 1 | FOH     | F-1.0     | STAFF ONLY                                       |                       |
| 50   | LEVEL 1 | FOH     | F-1.0     | SOUND BOOTH                                      |                       |
| 51   | LEVEL 1 | FOH     | F-1.0     | HOUSEKEEPING                                     |                       |
| 52   | LEVEL 1 | FOH     | F-1.0     | FOOD STAGING                                     |                       |
| 53   | LEVEL 1 | FOH     | F-1.0     | STAFF ONLY                                       |                       |
| 54   | LEVEL 1 | BOH     | B-1.0     | STAFF ONLY                                       |                       |
| 55   | LEVEL 1 | BOH     | B-1.0     | KITCHENET  |                       |
| 56   | LEVEL 1 | BOH     | B-1.0     | HOUSEKEEPING                                     |                       |
| 57   | LEVEL 1 | FOH     | B-2.0     | WOMEN (RESTROOM PLAQUE)                          |                       |
| 58   | LEVEL 1 | FOH     | B-2.0     | MEN (RESTROOM PLAQUE)                            |                       |
| 59   | LEVEL 1 | BOH     | B-1.0     | STAFF ONLY                                       |                       |
| 60   | LEVEL 1 | BOH     | B-1.0     | HOUSEKEEPING                                     |                       |

## INTERIOR MESSAGE SCHEDULE-CASINO 4

| LOC              | FLOOR   | FOH/BOH | SIGN TYPE | MESSAGE  | ADDITIONAL INFO/NOTES |
|------------------|---------|---------|-----------|--|-----------------------|
| 61               | LEVEL 1 | BOH     | B-1.0     | EVS  |                       |
| 62               | LEVEL 1 | BOH     | B-1.0     | ELEVATOR MECHANICAL  |                       |
| 63               | LEVEL 1 | BOH     | B-2.0     | (ELEVATOR PLAQUE) IN CASE OF FIRE DO NOT USE ELEVATOR USE STAIRS |                       |
| <b>LEVEL TWO</b> |         |         |           |  |                       |
| 1                | LEVEL 2 | FOH     | F-1.0     | IDF  |                       |
| 2                | LEVEL 2 | FOH     | F-1.0     | EVS  |                       |
| 3                | LEVEL 2 | FOH     | F-1.0     | STAFF ONLY   |                       |
| 4                | LEVEL 1 | BOH     | B-2.0     | (ELEVATOR PLAQUE) IN CASE OF FIRE DO NOT USE ELEVATOR USE STAIRS |                       |
| 5                | LEVEL 1 | FOH     | F-2.0     | (ELEVATOR PLAQUE) IN CASE OF FIRE DO NOT USE ELEVATOR USE STAIRS |                       |
| 6                | LEVEL 2 | FOH     | L-1.0     | POKER (NEW SIGN)   |                       |
| 7                | LEVEL 2 | FOH     | L-1.0     | POKER (RE-LOCATE SIGN FROM CURRENT POKER ROOM)                   |                       |
| 8                | LEVEL 2 | BOH     | B-1.0     | (NEED NAME OF ROOM)  |                       |
| 9                | LEVEL 2 | BOH     | B-1.0     | DESK   |                       |
| 10               | LEVEL 2 | BOH     | B-1.0     | CAGE   |                       |
| 11               | LEVEL 2 | FOH     | L-1.0     | CHECK IN (NEED CONFIRMATION OF NAME)                             |                       |
| 12               | LEVEL 2 | FOH     | F-1.0     | STAFF ONLY   |                       |
| 13               | LEVEL 2 | FOH     | F-1.0     | STORAGE  |                       |
| 14               | LEVEL 1 | FOH     | F-1.0     | HOUSEKEEPING   |                       |
| 15               | LEVEL 1 | FOH     | F-2.0     | WOMEN (RESTROOM PLAQUE)  |                       |
| 16               | LEVEL 1 | FOH     | F-1.0     | HOUSEKEEPING   |                       |
| 17               | LEVEL 1 | FOH     | F-2.0     | MEN (RESTROOM PLAQUE)  |                       |
| 18               | LEVEL 2 | FOH     | F-1.0     | OFFICE (NEED CONFIRMATION)                                       |                       |
| 18.1             | LEVEL 2 | FOH     | F-1.0     | OFFICE   |                       |
| 18.2             | LEVEL 2 | FOH     | F-1.0     | STORAGE  |                       |
| 19               | LEVEL 2 | FOH     | F-1.0     | VIP  |                       |
| 20               | LEVEL 2 | FOH     | F-1.0     | POKER  |                       |
|                  |         |         |           |  |                       |
|                  |         |         |           |  |                       |