

Project Name: Tahlequah Casino
 Project Number: 17-06

Item Number: S-GG-01
 Item Description: Dining Chair

Issue Date: 10.5.18

Item Location: RM 15 & 76
 Item Quantity: 90

Manufacturer: Grand Rapids Chair Company
 Address: 1250 84th Street SW
 Byron Center, MI 49315

Source:
 Address:

Phone: 616.774.0561

Phone:

Fax: 866.453.4748

Fax:

Contact: Katie Escovedo

Contact: Katie Escovedo

E-mail: katieescovedo@hotmail.com

E-mail: katieescovedo@hotmail.com

Web: www.grandrapidschair.com

Web:

Description: Metal frame dining chair, with wooden seat.

Model Number: 577
 Model Name: Mama Melissa Chair
 Material/Finish: Frame: Ultra Bronze; Seat: Natural
 Dimensions:
 Overall Width: 19"
 Overall Depth: 22"
 Overall Height:
 Arm Height: N/A
 Seat Depth:
 Seat Cushion Style: Wood
 Back Cushion Style: N/A
 Cushion content: N/A
 COM/COL: N/A



Photo for chair model only, finishes not shown.

Notes: Manufacturers to notify JRC of any error or conflict in specifications as indicated.

Lead Time: Ship To: Attn:

Required Item(s) for Designer Approval Prior to Fabrication: Finish Sample

Prepared By: JKM

Instructions:



Project Name: Tahlequah Casino
Project Number: 17-06

Item Number: S-GG-02
Item Description: Custom Booth

Issue Date: 10.5.18

Item Location: RM 15
Item Quantity:

Manufacturer:
Address:

Source:
Address:

Phone:
Fax:
Contact:
E-mail:
Web:

Phone:
Fax:
Contact:
E-mail:
Web:

Description: Custom booth seating.

Model Number: N/A
Model Name: N/A
Material/Finish: Seat & Back: TX-01; Trim: PL-3 (Wilsonart Caffelle 7933-12) or wood to match PL-3
Dimensions: Ref: Sheet A11.2 & A11.15
Overall Width: Ref: Sheet A11.2 & A11.15
Overall Depth: Ref: Sheet A11.2 & A11.15
Overall Height: Ref: Sheet A11.2 & A11.15
Arm Height: N/A
Seat Depth: Ref: Sheet A11.2 & A11.15
Seat Cushion Style: Ref: Sheet A11.2 & A11.15
Back Cushion Style: Ref: Sheet A11.2 & A11.15
Cushion content: Ref: Sheet A11.2 & A11.15
COM/COL: TX-01

Notes: Seats to be removable in 4' segments.
Manufacturers to notify JRC of any error or conflict in specifications as indicated.

Lead Time: Ship To: Attn:
Required Item(s) for Designer Approval Prior to Fabrication: Finish Sample Prepared By: JKM

Instructions:

Project Name: Tahlequah Casino
Project Number: 17-06

Item Number: S-L-01
Item Description: Barstool

Issue Date: 10.5.18

Item Location: RM 16
Item Quantity: 44

Manufacturer: Grand Rapids Chair Company
Address: 1250 84th Street SW
Byron Center, MI 49315

Source:
Address:

Phone: 616.774.0561

Phone:

Fax: 866.453.4748

Fax:

Contact: Katie Escovedo

Contact: Katie Escovedo

E-mail: katieescovedo@hotmail.com

E-mail: katieescovedo@hotmail.com

Web: www.grandrapidschair.com

Web:

Description: Metal frame barstool, with upholstered seat.

Model Number: 577BS
Model Name: Mama Melissa Barstool
Material/Finish: Frame: Ultra Bronze; Seat: TX-05
Dimensions:
Overall Width: 19.25"
Overall Depth: 20.25"
Overall Height:
Arm Height: N/A
Seat Depth:
Seat Cushion Style: Upholstered COM
Back Cushion Style: N/A
Cushion content: N/A
COM/COL: TX-05



Photo for chair model only, finishes not shown.

Notes: Manufacturers to notify JRC of any error or conflict in specifications as indicated.

Lead Time: Ship To: Attn:

Required Item(s) for Designer Approval Prior to Fabrication: Finish Sample

Prepared By: JKM

Instructions:

Project Name: Tahlequah Casino
Project Number: 17-06

Item Number: S-L-02
Item Description: Swivel Barstool

Issue Date: 10.5.18

Item Location: RM 17
Item Quantity: 13

Manufacturer: Grand Rapids Chair Company
Address: 1250 84th Street SW
Byron Center, MI 49315

Source:
Address:

Phone: 616.774.0561
Fax: 866.453.4748
Contact: Katie Escovedo
E-mail: katieescovedo@hotmail.com
Web: www.grandrapidschair.com

Phone:
Fax:
Contact: Katie Escovedo
E-mail: katieescovedo@hotmail.com
Web:

Description: Metal frame swivel barstool, with upholstered seat.

Model Number: 6577BS
Model Name: Mama Melissa Swivel Barstool
Material/Finish: Frame: Ultra Bronze; Seat: TX-05
Dimensions:
Overall Width: 19.25"
Overall Depth: 20.25"
Overall Height:
Arm Height: N/A
Seat Depth:
Seat Cushion Style: Upholstered COM
Back Cushion Style: N/A
Cushion content: N/A
COM/COL: TX-05



Photo for chair model only, finishes not shown.

Notes: Manufacturers to notify JRC of any error or conflict in specifications as indicated.

Lead Time: Ship To: Attn:

Required Item(s) for Designer Approval Prior to Fabrication: Finish Sample

Prepared By: JKM

Instructions:



Project Name: Tahlequah Casino
Project Number: 17-06

Item Number: S-L-03
Item Description: Custom Booth

Issue Date: 10.5.18

Item Location: RM 16
Item Quantity:

Manufacturer:
Address:

Source:
Address:

Phone:

Phone:

Fax:

Fax:

Contact:

Contact:

E-mail:

E-mail:

Web:

Web:

Description: Custom booth seating.

Model Number: N/A

Model Name: N/A

Material/Finish: Seat & Back: TX-01; Trim: PL-3 (Wilsonart Caffelle 7933-12) or wood to match PL-3

Dimensions: Ref: Sheet A11.2 & A11.15

Overall Width: Ref: Sheet A11.2 & A11.15

Overall Depth: Ref: Sheet A11.2 & A11.15

Overall Height: Ref: Sheet A11.2 & A11.15

Arm Height: N/A

Seat Depth: Ref: Sheet A11.2 & A11.15

Seat Cushion Style: Ref: Sheet A11.2 & A11.15

Back Cushion Style: Ref: Sheet A11.2 & A11.15

Cushion content: Ref: Sheet A11.2 & A11.15

COM/COL: TX-01

Notes: Seats to be removable in 4' segments.
Manufacturers to notify JRC of any error or conflict in specifications as indicated.

Lead Time: Ship To: Attn:

Required Item(s) for Designer Approval Prior to Fabrication: Finish Sample

Prepared By: JKM

Instructions:

Project Name: Tahlequah Casino
Project Number: 17-06

Item Number: S-DN-01
Item Description: Dining Chair

Issue Date: 10.5.18

Item Location: RM 83, 84, & 84A
Item Quantity: ~~12~~ 130

Manufacturer: Sandler Seating
Address: Sandler Seating Inc. 1201
Peachtree Street NE, Suite 1625
Atlanta, GA 30361

Source:
Address:

Phone: 214.232.1745

Phone:

Fax:

Fax:

Contact: Nicki Coussons Salmon

Contact: Nicki Coussons Salmon

E-mail: nicki@coussonsgroup.com

E-mail: nicki@coussonsgroup.com

Web: www.sandlerseating.com

Web: www.coussonsgroup.com

Description: Metal frame dining chair, with upholstered seat.

Model Number: Woodlook 1.3
Model Name: Woodlook 1.3
Material/Finish: Frame: 24A Walnut; Seat: TX-02
Dimensions:
Overall Width: 19.3"
Overall Depth: 20.3"
Overall Height: 33.7"
Arm Height: N/A
Seat Depth:
Seat Cushion Style:
Back Cushion Style:
Cushion content:
COM/COL: TX-02
COM Yardage: 0.44 yds



Photo for chair model only, finishes not shown.

Notes: Manufacturers to notify JRC of any error or conflict in specifications as indicated.
12 chairs added for additional seating in RM 83.

Lead Time: Ship To: Attn:

Required Item(s) for Designer Approval Prior to Fabrication: Finish Sample

Prepared By: JKM

Instructions:

Project Name: Tahlequah Casino
Project Number: 17-06

Item Number: S-DN-02
Item Description: Barstool

Issue Date: 10.5.18

Item Location: RM 85
Item Quantity: 20

Manufacturer: Sandler Seating
Address: Sandler Seating Inc. 1201
Peachtree Street NE, Suite 1625
Atlanta, GA 30361

Source:
Address:

Phone: 214.232.1745

Phone:

Fax:

Fax:

Contact: Nicki Coussons Salmon
E-mail: nicki@coussonsgroup.com
Web: www.sandlerseating.com

Contact: Nicki Coussons Salmon
E-mail: nicki@coussonsgroup.com
Web: www.coussonsgroup.com

Description: Metal frame woodlook barstool, with upholstered seat.

Model Number: Woodlook 3.3
Model Name: Woodlook 3.3
Material/Finish: Frame: 24A Walnut; Seat: TX-03
Dimensions:
Overall Width: 18.5"
Overall Depth: 19.8"
Overall Height: 42.5"
Arm Height: N/A
Seat Depth:
Seat Cushion Style:
Back Cushion Style:
Cushion content:
COM/COL: TX-03
COM Yardage: 0.44 yds



Photo for chair model only, finishes not shown.

Notes: Manufacturers to notify JRC of any error or conflict in specifications as indicated.

Lead Time: Ship To: Attn:

Required Item(s) for Designer Approval Prior to Fabrication: Finish Sample

Prepared By: JKM

Instructions:



Project Name: Tahlequah Casino
Project Number: 17-06

Item Number: S-DN-04
Item Description: Custom Booth

Issue Date: 10.5.18

Item Location: RM 84
Item Quantity:

Manufacturer:
Address:

Source:
Address:

Phone:

Phone:

Fax:

Fax:

Contact:

Contact:

E-mail:

E-mail:

Web:

Web:

Description: Custom booth seating.

Model Number: N/A

Model Name: N/A

Material/Finish: Seat: TX-02; Back: TX-05; Trim: PL-3 (Wilsonart Caffelle 7933-12) or wood to match PL-3

Dimensions: Ref: Sheet A11.2 & A11.15

Overall Width: Ref: Sheet A11.2 & A11.15

Overall Depth: Ref: Sheet A11.2 & A11.15

Overall Height: Ref: Sheet A11.2 & A11.15

Arm Height: N/A

Seat Depth: Ref: Sheet A11.2 & A11.15

Seat Cushion Style: Ref: Sheet A11.2 & A11.15

Back Cushion Style: Ref: Sheet A11.2 & A11.15

Cushion content: Ref: Sheet A11.2 & A11.15

COM/COL: TX-02 & TX-05

Notes: Manufacturers to notify JRC of any error or conflict in specifications as indicated.

Lead Time: Ship To: Attn:

Required Item(s) for Designer Approval Prior to Fabrication: Finish Sample

Prepared By: JKM

Instructions:



Project Name: Tahlequah Casino
Project Number: 17-06

Item Number: TX-01
Item Description: Vinyl Upholstery

Issue Date: 10.5.18

Item Location: S-GG-02, S-L-03, S-GR-01, S-GR-02
Item Quantity:

Manufacturer: Wolf Gordon
Address: 333 Seventh Avenue
New York, NY 10001

Source:
Address:

Phone: 901.606.2039
Fax:
Contact: Kristen Lafhameyer
E-mail: Kristen.Lafhameyer@wolfgordon.com
Web: www.wolfgordon.com

Phone:
Fax:
Contact: Kristen Lafhameyer
E-mail: Kristen.Lafhameyer@wolfgordon.com
Web: www.wolfgordon.com

Description: Vinyl upholstery.

Pattern Number: GOH 12449235
Pattern Name: Zigrino
Color: Marlin
Width: 54"
Repeat: N/A
Type: Upholstery
Weight: 35 oz per linear yard
Content: 100% Vinyl
Backing: Woven Polyester/Cotton
Fire Rating: Cal TB 117-2013; NFPA 260/UFAC
Cleaning: W = Clean with only a waterbased cleaning agent
A diluted bleach solution can be used
Durability: 200,000 double rubs, Wyzenbeek method
Finish: Spill and stain resistant



Notes: Manufacturers to notify JRC of any error or conflict in specifications as indicated.

Lead Time: Ship To: Attn:
Required Item(s) for Designer Approval Prior to Fabrication: Cutting Prepared By: JKM

Instructions:



Project Name: Tahlequah Casino
Project Number: 17-06

Item Number: TX-02
Item Description: Polyurethane Upholstery

Issue Date: 10.5.18

Item Location: S-DN-01, S-DN-03, S-DN-04, S-PF-02
Item Quantity:

Manufacturer: Wolf Gordon
Address: 333 Seventh Avenue
New York, NY 10001

Source:
Address:

Phone: 901.606.2039
Fax:
Contact: Kristen Lafhameyer
E-mail: Kristen.Lafhameyer@wolfgordon.com
Web: www.wolfgordon.com

Phone:
Fax:
Contact: Kristen Lafhameyer
E-mail: Kristen.Lafhameyer@wolfgordon.com
Web: www.wolfgordon.com

Description: Polyurethane upholstery.

Pattern Number: GOH 12427638
Pattern Name: Deltana
Color: Harbor
Width: 54"
Repeat: N/A
Type: Upholstery
Weight: 20 oz per linear yard
Content: 100% Polyurethane
Backing: Polyester Knit
Fire Rating: Cal TB 117-2013; NFPA 260/UFAC
Cleaning: W = Clean with only a waterbased cleaning agent
A diluted bleach solution can be used
Durability: 250,000 double rubs, Wyzenbeek method
Finish: Graffiti proof stain and ink resistant treatment



Notes: Manufacturers to notify JRC of any error or conflict in specifications as indicated.

Lead Time: _____ Ship To: _____ Attn: _____
Required Item(s) for Designer Approval Prior to Fabrication: Cutting _____ Prepared By: JKM

Instructions:

Project Name: Tahlequah Casino
Project Number: 17-06

Item Number: TX-03
Item Description: Vinyl Upholstery

Issue Date: 10.5.18

Item Location: S-DN-02
Item Quantity:

Manufacturer: Wolf Gordon
Address: 333 Seventh Avenue
New York, NY 10001

Source:
Address:

Phone: 901.606.2039
Fax:
Contact: Kristen Lafhameyer
E-mail: Kristen.Lafhameyer@wolfgordon.com
Web: www.wolfgordon.com

Phone:
Fax:
Contact: Kristen Lafhameyer
E-mail: Kristen.Lafhameyer@wolfgordon.com
Web: www.wolfgordon.com

Description: Vinyl upholstery.

Pattern Number: GOH 12449234
Pattern Name: Zigrino
Color: Sepia
Width: 54"
Repeat: N/A
Type: Upholstery
Weight: 35 oz per linear yard
Content: 100% Vinyl
Backing: Woven Polyester/Cotton
Fire Rating: Cal TB 117-2013; NFPA 260/UFAC
Cleaning: W = Clean with only a waterbased cleaning agent
A diluted bleach solution can be used
Durability: 200,000 double rubs, Wyzenbeek method
Finish: Spill and stain resistant



Notes: Manufacturers to notify JRC of any error or conflict in specifications as indicated.

Lead Time: Ship To: Attn:
Required Item(s) for Designer Approval Prior to Fabrication: Cutting

Prepared By: JKM

Instructions:

Project Name: Tahlequah Casino
Project Number: 17-06

Item Number: TX-05
Item Description: Vinyl Upholstery

Issue Date: 10.5.18

Item Location: S-L-01, S-L-02, S-L-04, S-DN-04
Item Quantity:

Manufacturer: Wolf Gordon
Address: 333 Seventh Avenue
New York, NY 10001

Source:
Address:

Phone: 901.606.2039

Phone:

Fax:

Fax:

Contact: Kristen Lafhameyer

Contact: Kristen Lafhameyer

E-mail: Kristen.Lafhameyer@wolfgordon.com

E-mail: Kristen.Lafhameyer@wolfgordon.com

Web: www.wolfgordon.com

Web: www.wolfgordon.com

Description: Vinyl Upholstery

Pattern Number: GOH 12666626

Pattern Name: Plexus

Color: Charcoal

Width: 54"

Repeat:

Type: Upholstery

Weight: 30 oz per linear yard

Content: 100% Vinyl

Backing: Polyester Knit

Fire Rating: Cal TB 117-2013; NFPA 260/UFAC

Cleaning: W - S: Water or solvent based cleaning agent,
or diluted bleach solution

Durability: 100,000 double rubs, Wyzenbeek method

Finish:



Notes:

Manufacturers to notify JRC of any error or conflict in specifications as indicated.

Lead Time: Ship To: Attn:

Required Item(s) for Designer Approval Prior to Fabrication: Cutting

Prepared By: JKM

Instructions:



James R. Childers
Architects, Inc.
1000 W. 15th St.
Tulsa, Oklahoma 74106
www.jrchilders.com



CHEROKEE NATION ENTERTAINMENT
TAHEQUAH CASINO
TAHEQUAH OKLAHOMA

Project Name: FFBE

Job No.	100518	Rev.	17-28
Client	Cherokee Nation	Date	A11.12
Project Location		Equipment Plan	

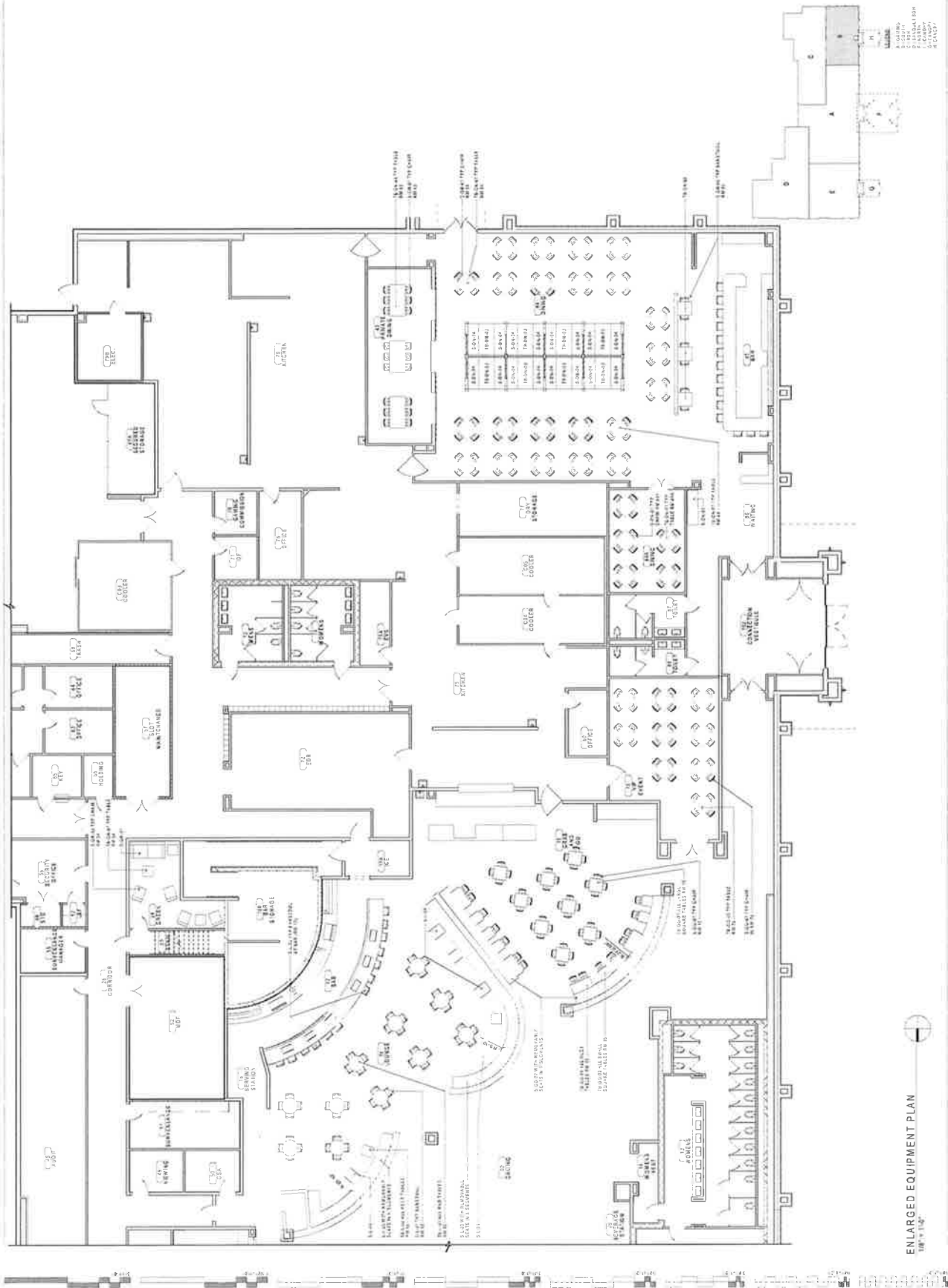

ENLARGED EQUIPMENT PLAN
1/8" = 1'-0"

- A. CASINO
- B. CASINO
- C. CASINO
- D. CASINO
- E. CASINO
- F. CASINO
- G. CASINO
- H. CASINO
- I. CASINO
- J. CASINO
- K. CASINO
- L. CASINO
- M. CASINO
- N. CASINO
- O. CASINO
- P. CASINO
- Q. CASINO
- R. CASINO
- S. CASINO
- T. CASINO
- U. CASINO
- V. CASINO
- W. CASINO
- X. CASINO
- Y. CASINO
- Z. CASINO



James R. Chadders
Architects, Inc.
1500 W. 10th Street
Tulsa, Oklahoma 74106
918.438.1111
www.jrchadders.com



Contract No. _____
Drawing No. _____



CHEROKEE NATION ENTERTAINMENT
TALEQUAH CASINO
TALEQUAH OKLAHOMA

PROJECT NO. _____
FILE _____

DATE	DESCRIPTION

DATE: 01/25/13
DRAWN BY: JRC
SCALE: A11.15
DETAILS

