

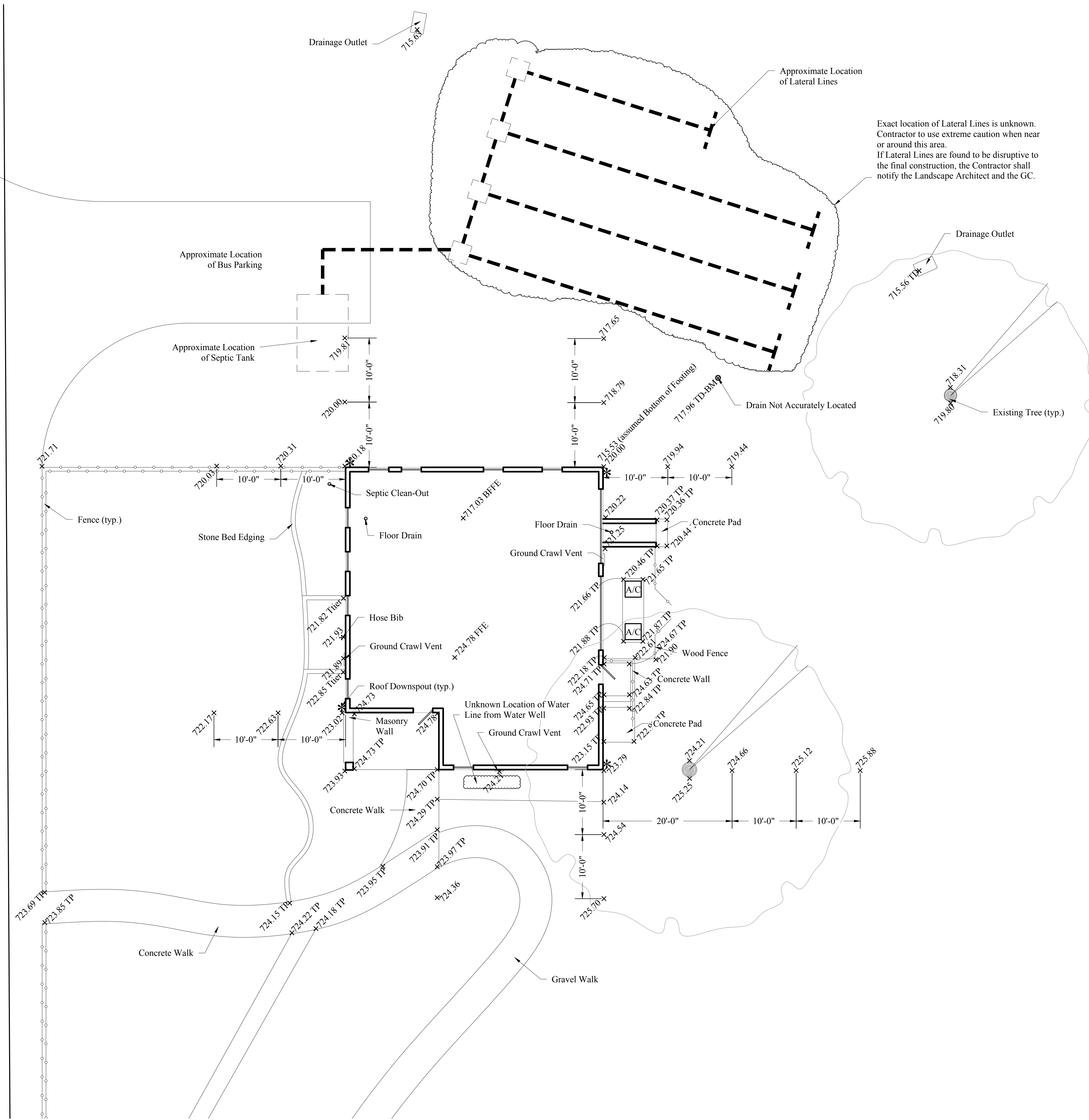

7022 South Birmingham Court Tulsa, Oklahoma 74136
Ph- 918.232.4978
E-Mail - carl.soboc@gmail.com



Exact location of Lateral Lines is unknown. Contractor to use extreme caution when near or around this area. If Lateral Lines are found to be disruptive to the final construction, the Contractor shall notify the Landscape Architect and the GC.

Revisions		
#	Description	Date

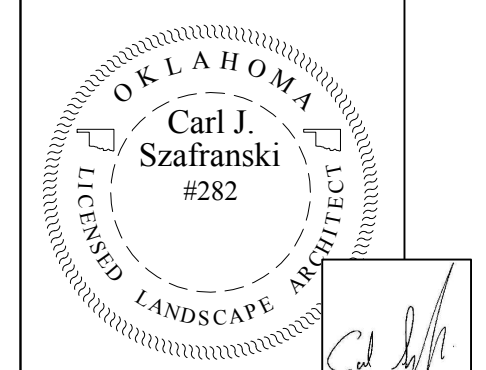

Project
John Ross Museum
22366 S. 530 Road
Park Hill, Oklahoma 74451

Sheet Title
Existing Site

Scale: 1" = 8'-0"
Drawn: KRC
Checked: CJS
Issue Date: 11/1/19

Sheet #:
L1