



7022 South Birmingham Court Tulsa, Oklahoma 74136
 Ph- 918.232.4978
 E-Mail - carl.sob@gmail.com



Grading Legend:

| | |
|--------------------------|----------|
| Existing Grade | ± 000.00 |
| Proposed Grade | ± 000.00 |
| Bottom of Vent | BV |
| Top of Threshold | TT |
| Bottom of Threshold | BT |
| Bench Mark | BM |
| Top of Wall Elevation | TW |
| Bottom of Wall Elevation | BW |
| Top of Step Elevation | TS |
| Bottom of Step Elevation | BS |
| Finished Floor Elevation | FFE |
| Basement Finished Floor | BFFE |
| Top Of Paving Elevation | TP |
| Top of Pipe Elevation | TPIPE |
| Top of Drain Inlet | TDI |
| Top of Tier Elevation | ← |
| Drainage Direction | |

Revisions

| # | Description | Date |
|---|-------------|------|
| | | |
| | | |
| | | |
| | | |

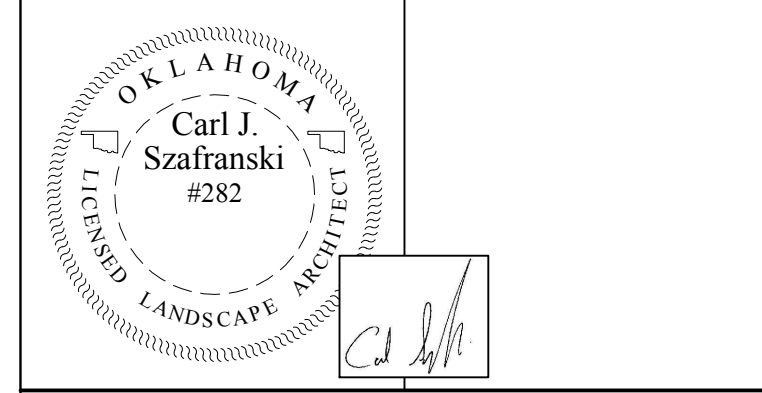

Project
John Ross Museum
 22366 S. 530 Road
 Park Hill, Oklahoma 74451

Sheet Title
Grading Plan

Scale: 1"= 8'-0"
 Drawn: KRC
 Checked: CJS
 Issue Date: 11/1/19

Sheet #:
L3

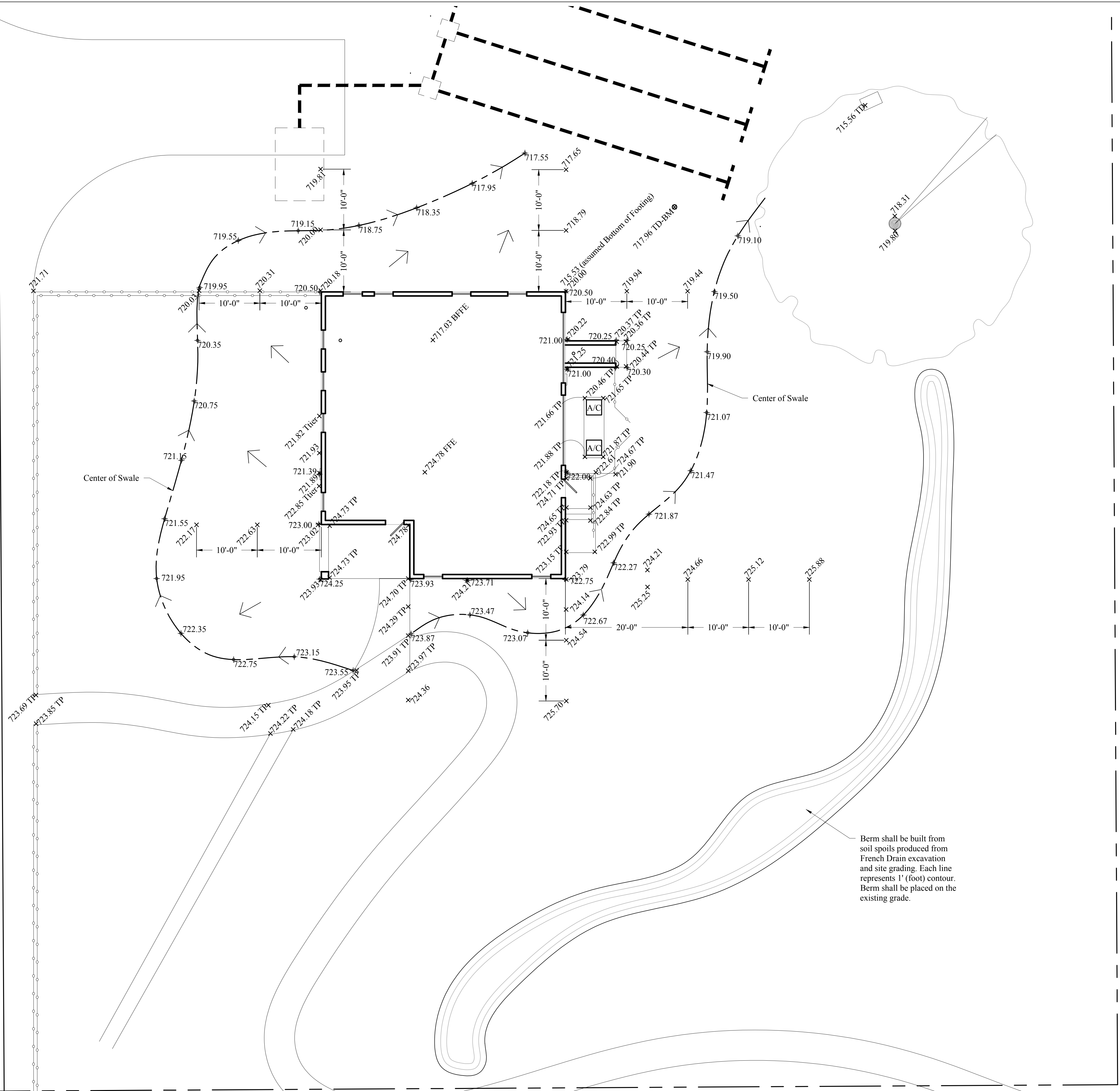

Berm shall be built from soil spoils produced from French Drain excavation and site grading. Each line represents 1' (foot) contour. Berm shall be placed on the existing grade.