

- GENERAL NOTES:**
- EQUIPMENT SHOWN IN FLOOR PLAN IS REPRESENTATIVE OF TYPICALS AND OWNER REQUESTED ITEMS AND IS SHOWN PURELY FOR SPACE PLANNING. LAYOUTS OF ROOMS ARE SUBJECT TO CHANGE IN DESIGN DEVELOPMENT AND CONSTRUCTION DOCUMENTS.
 - FURTHER PLANNING ON SPECIFIC EQUIPMENT AND EXACT LOCATIONS IS TO BE DETERMINED IN DESIGN DEVELOPMENT AND CONSTRUCTION DOCUMENTS.
 - MECHANICAL, ELECTRICAL, PLUMBING, AND STRUCTURAL COORDINATION HAS NOT YET BEEN DONE, BUT WILL BE ADDRESSED LATER IN DESIGN.
 - ITEMS HIGHLIGHTED AND SHOWN TO BE PROVIDED BY A SPECIFIC VENDOR ARE STILL UNDER DESIGN AND SUBJECT TO CHANGE IN THE FUTURE. DRAWINGS WILL BE COORDINATED BY INTERIOR LOGISTICS UNLESS NOTED OTHERWISE.
 - REFERENCE APPENDIX A FOR A BASELINE EQUIPMENT LIST FOR THE FACILITY. ALL THE ABOVE NOTES APPLY TO THE BASELINE EQUIPMENT LIST.

James R. Childers
Architect, Inc.
45 South 4th Street
Fort Smith, AR 72901
479-783-2480
www.childersarchitect.com

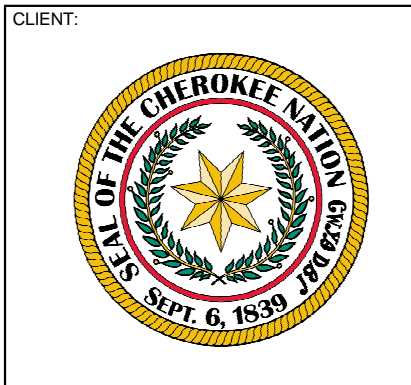

CHEROKEE NATION
W.W. HASTINGS REPLACEMENT HOSPITAL
TAHELEQUAH, OKLAHOMA

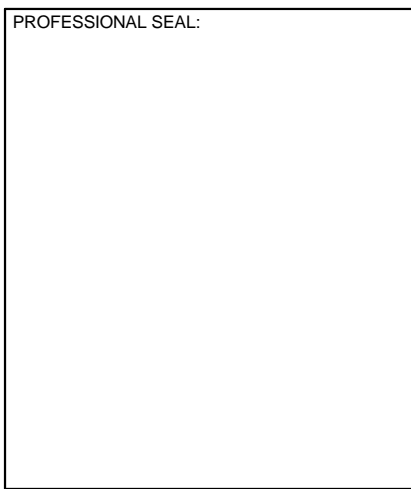
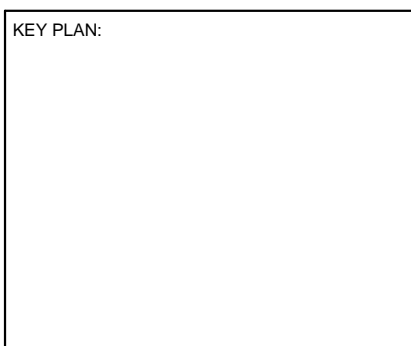

PROJECT PHASE:
SCHEMATIC DESIGN

#	DATE	REVISIONS	DESCRIPTION

JOB NUMBER: 21-08.21
DATE: 05-06-2022
SHEET NUMBER:
EQ1.0
SHEET TITLE:
LEVEL 1/ ED



LEVEL 1 - OVERALL FLOOR PLAN

- Level 01 - ED - Triage**
1/8" = 1'-0"
- Level 01 - ED - Treatment**
1/8" = 1'-0"
- Level 01 - ED - Trauma**
1/8" = 1'-0"
- Level 01 - ED - Clean Supply & Meds**
1/8" = 1'-0"

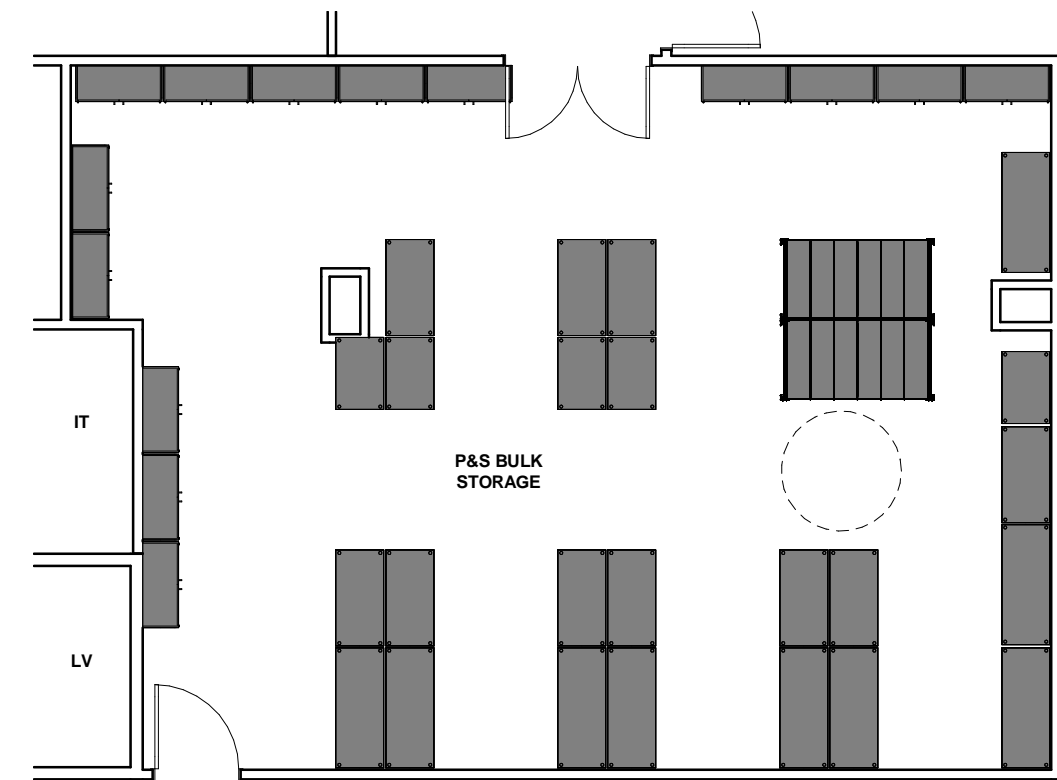
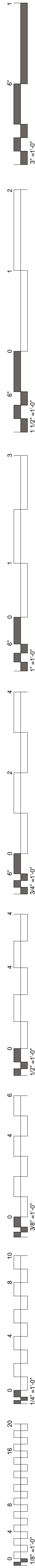

1 Level 03 - P&S - Bulk Storage
1/8" = 1'-0"

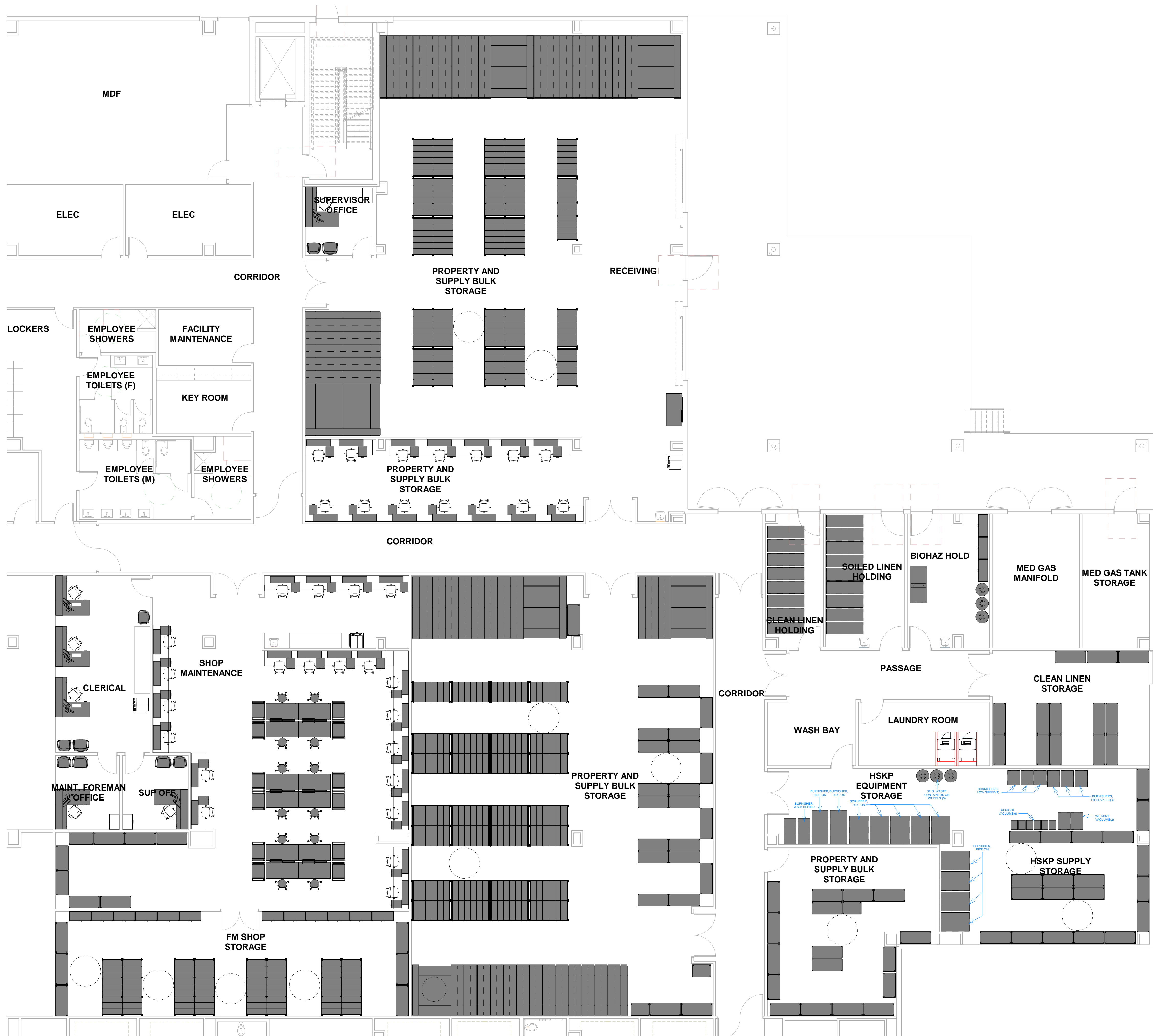

2 Level 01 - P&S/ Facilities Management/
Houskeeping & Linens
1/8" = 1'-0"

GENERAL NOTES:

1. EQUIPMENT SHOWN IN FLOOR PLAN IS REPRESENTATIVE OF TYPICALS AND OWNER REQUESTED ITEMS AND IS SHOWN PURELY FOR SPACE PLANNING. LAYOUTS OF ROOMS ARE SUBJECT TO CHANGE IN DESIGN DEVELOPMENT AND CONSTRUCTION DOCUMENTS.
2. FURTHER PLANNING ON SPECIFIC EQUIPMENT AND EXACT LOCATIONS IS TO BE DETERMINED IN DESIGN DEVELOPMENT AND CONSTRUCTION DOCUMENTS.
3. MECHANICAL, ELECTRICAL, PLUMBING, AND STRUCTURAL COORDINATION HAS NOT YET BEEN DONE, BUT WILL BE ADDRESSED LATER IN DESIGN.
4. ITEMS HIGHLIGHTED AND SHOWN TO BE PROVIDED BY A SPECIFIC VENDOR ARE STILL UNDER DESIGN AND SUBJECT TO CHANGE IN THE FUTURE. DRAWINGS WILL BE COORDINATED BY INTERIOR LOGISTICS UNLESS NOTED OTHERWISE.
5. REFERENCE APPENDIX A FOR A BASELINE EQUIPMENT LIST FOR THE FACILITY, ALL THE ABOVE NOTES APPLY TO THE BASELINE EQUIPMENT LIST.

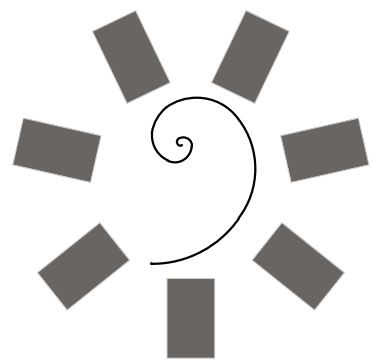

James R. Childers
Architect, Inc.
45 South 4th Street
Fort Smith, AR 72901
479-783-2480
www.childersarchitect.com

PROFESSIONAL SEAL:

CONSULTANT LOGO:



CLIENT:



CHEROKEE NATION
W.W. HASTINGS REPLACEMENT HOSPITAL
TAHLEQUAH, OKLAHOMA

KEY PLAN:

PROJECT PHASE:

SCHEMATIC DESIGN

#	DATE	REVISIONS	DESCRIPTION

JOB NUMBER: 21-08.21

DATE: 05-06-2022

SHEET NUMBER:

EQ1.1

SHEET TITLE:

PROPERTY & SUPPLY,
FACILITIES MAN,
CLINICAL ENGINEERING

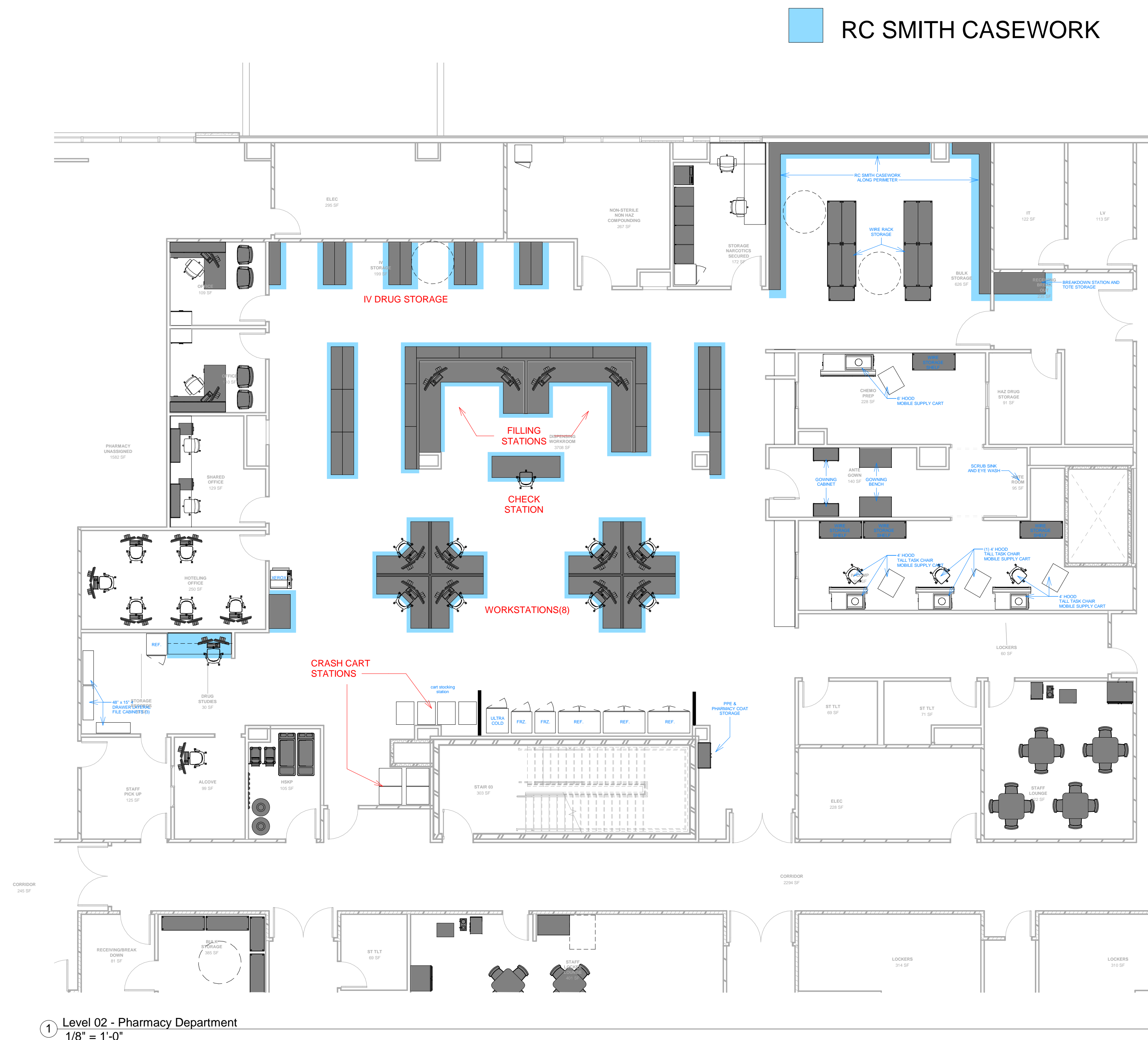
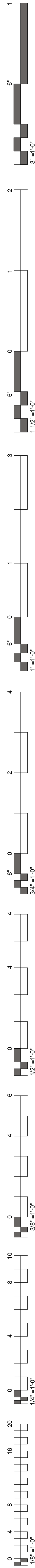

LEVEL 2 - OVERALL FLOOR PLAN

- GENERAL NOTES:**
- EQUIPMENT SHOWN IN FLOOR PLAN IS REPRESENTATIVE OF TYPICALS AND OWNER REQUESTED ITEMS AND IS SHOWN PURELY FOR SPACE PLANNING. LAYOUTS OF ROOMS ARE SUBJECT TO CHANGE IN DESIGN DEVELOPMENT AND CONSTRUCTION DOCUMENTS.
 - FURTHER PLANNING ON SPECIFIC EQUIPMENT AND EXACT LOCATIONS IS TO BE DETERMINED IN DESIGN DEVELOPMENT AND CONSTRUCTION DOCUMENTS.
 - MECHANICAL, ELECTRICAL, PLUMBING, AND STRUCTURAL COORDINATION HAS NOT YET BEEN DONE, BUT WILL BE ADDRESSED LATER IN DESIGN.
 - ITEMS HIGHLIGHTED AND SHOWN TO BE PROVIDED BY A SPECIFIC VENDOR ARE STILL UNDER DESIGN AND SUBJECT TO CHANGE IN THE FUTURE. DRAWINGS WILL BE COORDINATED BY INTERIOR LOGISTICS UNLESS NOTED OTHERWISE.
 - REFERENCE APPENDIX A FOR A BASELINE EQUIPMENT LIST FOR THE FACILITY. ALL THE ABOVE NOTES APPLY TO THE BASELINE EQUIPMENT LIST.

James R. Childers Architect, Inc.
45 South 4th Street
Fort Smith, AR 72901
479-783-2480
www.childersarchitect.com

PROFESSIONAL SEAL:

CONSULTANT LOGO

Interior Logistics

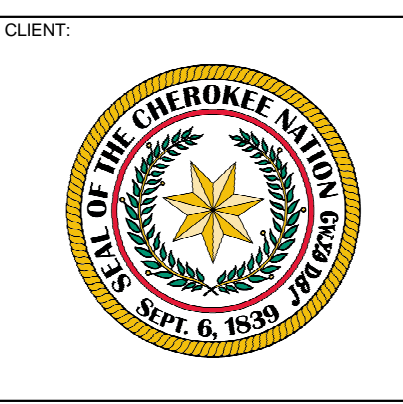

CHEROKEE NATION
W.W. HASTINGS REPLACEMENT HOSPITAL
TAHLEQUAH, OKLAHOMA

KEY PLAN:

PROJECT PHASE:
SCHEMATIC DESIGN

#	DATE	REVISIONS	DESCRIPTION

JOB NUMBER: 21-08.21
DATE: 05-06-2022
SHEET NUMBER:
EQ2.0
SHEET TITLE:
PHARMACY LAYOUT
REVISED

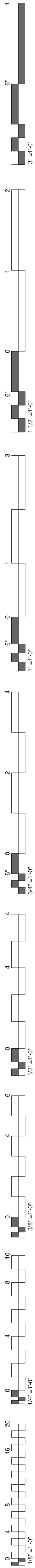

1 Level 02 - Laboratory Department
1/8" = 1'-0"



2 Level 02 - SPD Department
1/8" = 1'-0"

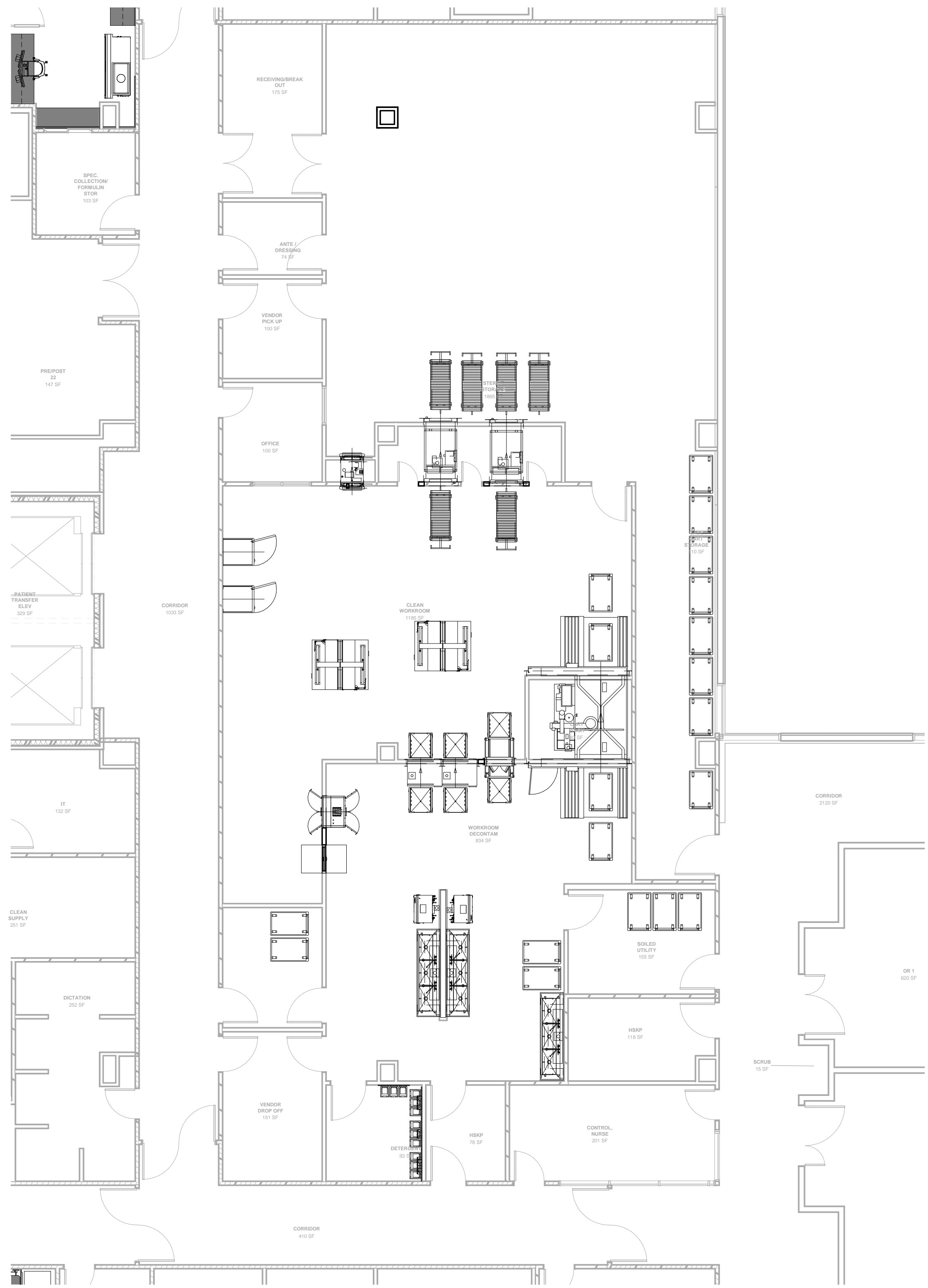

- GENERAL NOTES:**
- EQUIPMENT SHOWN IN FLOOR PLAN IS REPRESENTATIVE OF TYPICALS AND OWNER REQUESTED ITEMS AND IS SHOWN PURELY FOR SPACE PLANNING. LAYOUTS OF ROOMS ARE SUBJECT TO CHANGE IN DESIGN DEVELOPMENT AND CONSTRUCTION DOCUMENTS.
 - FURTHER PLANNING ON SPECIFIC EQUIPMENT AND EXACT LOCATIONS IS TO BE DETERMINED IN DESIGN DEVELOPMENT AND CONSTRUCTION DOCUMENTS.
 - MECHANICAL, ELECTRICAL, PLUMBING, AND STRUCTURAL COORDINATION HAS NOT YET BEEN DONE, BUT WILL BE ADDRESSED LATER IN DESIGN.
 - ITEMS HIGHLIGHTED AND SHOWN TO BE PROVIDED BY A SPECIFIC VENDOR ARE STILL UNDER DESIGN AND SUBJECT TO CHANGE IN THE FUTURE. DRAWINGS WILL BE COORDINATED BY INTERIOR LOGISTICS UNLESS NOTED OTHERWISE.
 - REFERENCE APPENDIX A FOR A BASELINE EQUIPMENT LIST FOR THE FACILITY, ALL THE ABOVE NOTES APPLY TO THE BASELINE EQUIPMENT LIST.

**James R. Childers
Architect, Inc.**
45 South 4th Street
Fort Smith, AR 72901
479-783-2480
www.childersarchitect.com

PROFESSIONAL SEAL:

CONSULTANT LOGO

Interior Logistics

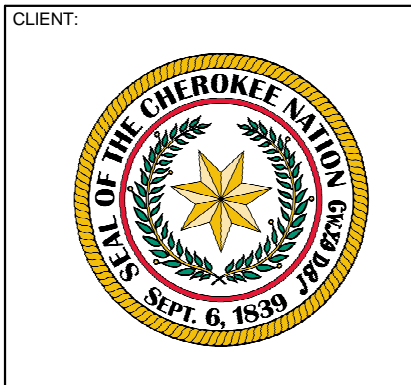

CHEROKEE NATION
W.W. HASTINGS REPLACEMENT HOSPITAL
TAHLEQUAH, OKLAHOMA

KEY PLAN:

PROJECT PHASE:
SCHEMATIC DESIGN

#	DATE	REVISIONS DESCRIPTION

JOB NUMBER: 21-08.21
DATE: 05-06-2022
SHEET NUMBER:
EQ2.1
SHEET TITLE:
LAB/ STERILE PROCESSING

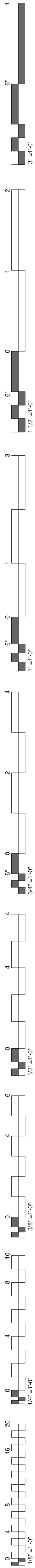

- GENERAL NOTES:**
- EQUIPMENT SHOWN IN FLOOR PLAN IS REPRESENTATIVE OF TYPICALS AND OWNER REQUESTED ITEMS AND IS SHOWN PURELY FOR SPACE PLANNING. LAYOUTS OF ROOMS ARE SUBJECT TO CHANGE IN DESIGN DEVELOPMENT AND CONSTRUCTION DOCUMENTS.
 - FURTHER PLANNING ON SPECIFIC EQUIPMENT AND EXACT LOCATIONS IS TO BE DETERMINED IN DESIGN DEVELOPMENT AND CONSTRUCTION DOCUMENTS.
 - MECHANICAL, ELECTRICAL, PLUMBING, AND STRUCTURAL COORDINATION HAS NOT YET BEEN DONE, BUT WILL BE ADDRESSED LATER IN DESIGN.
 - ITEMS HIGHLIGHTED AND SHOWN TO BE PROVIDED BY A SPECIFIC VENDOR ARE STILL UNDER DESIGN AND SUBJECT TO CHANGE IN THE FUTURE. DRAWINGS WILL BE COORDINATED BY INTERIOR LOGISTICS UNLESS NOTED OTHERWISE.
 - REFERENCE APPENDIX A FOR A BASELINE EQUIPMENT LIST FOR THE FACILITY. ALL THE ABOVE NOTES APPLY TO THE BASELINE EQUIPMENT LIST.

James R. Childers Architect, Inc.
45 South 4th Street
Fort Smith, AR 72901
479-783-2480
www.childersarchitect.com

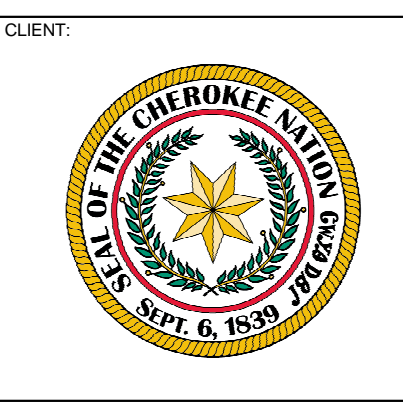

CHEROKEE NATION
W.W. HASTINGS REPLACEMENT HOSPITAL
TAHLEQUAH, OKLAHOMA

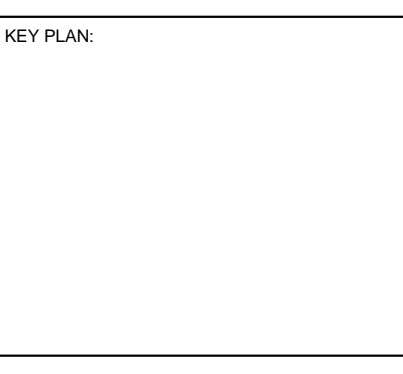

PROJECT PHASE:
SCHEMATIC DESIGN

#	DATE	REVISIONS	DESCRIPTION

JOB NUMBER: 21-08.21
DATE: 05-06-2022
SHEET NUMBER: **EQ3.0**
SHEET TITLE: ADMIN/ HEALTH EDU/ IT

- 1** Level 03 - Education - Nursing Classroom
1/8" = 1'-0"
- 2** Level 03 - Admin - Admin Office Copy 1
1/8" = 1'-0"
- 3** Level 03 - Admin - Assistant Office Copy 1
1/8" = 1'-0"
- 4** Level 03 - IT - Storage & Workroom
1/8" = 1'-0"
- 6** Level 03 - Hospice - Patient Room
1/8" = 1'-0"
- 7** Level 03 - ICU - Patient Room
1/8" = 1'-0"
- 8** Level 03 - Dialysis - Dialysis Bay
1/8" = 1'-0"



LEVEL 3 - OVERALL FLOOR PLAN

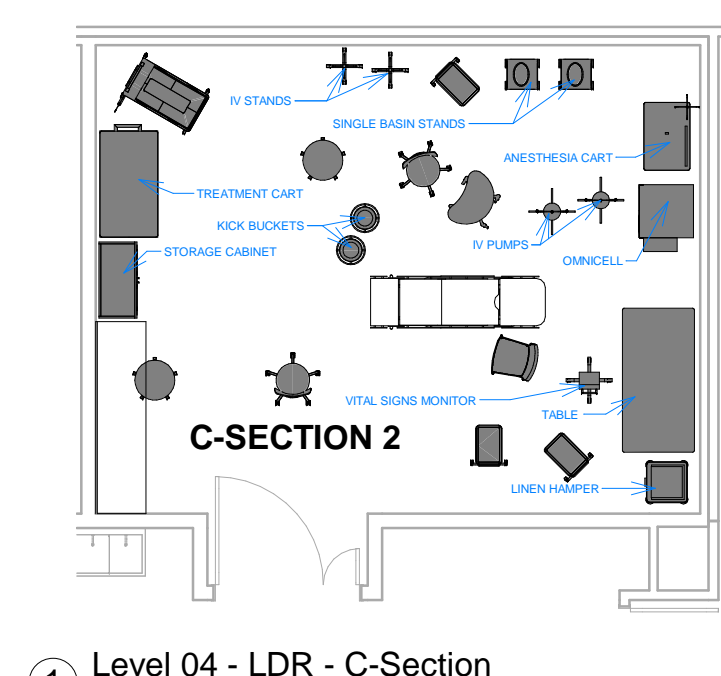
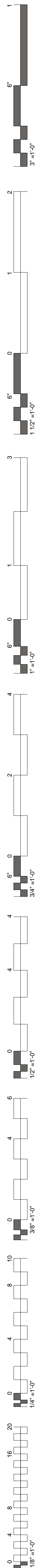

① Level 04 - LDR - C-Section
1/8" = 1'-0"

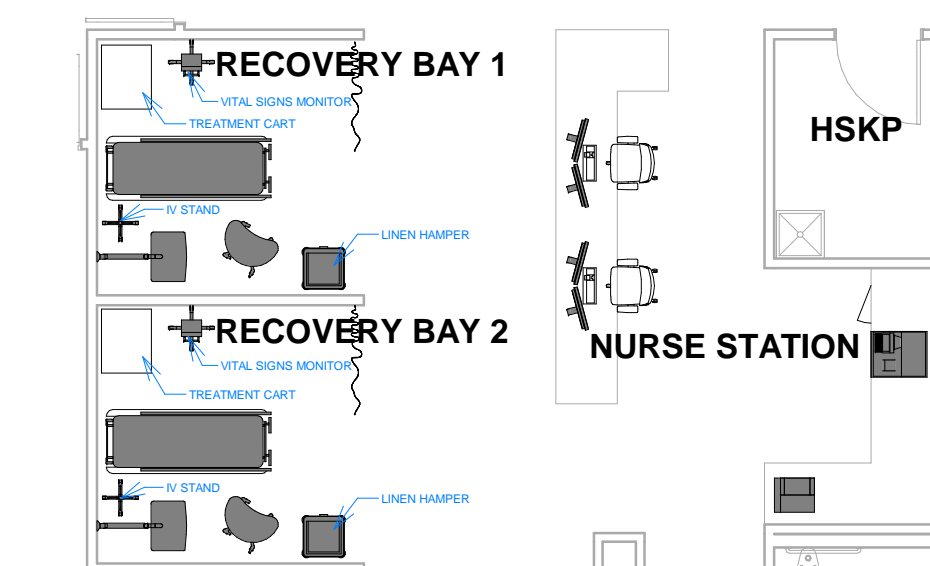

② Level 04 - LDR - Recovery Bays
1/8" = 1'-0"

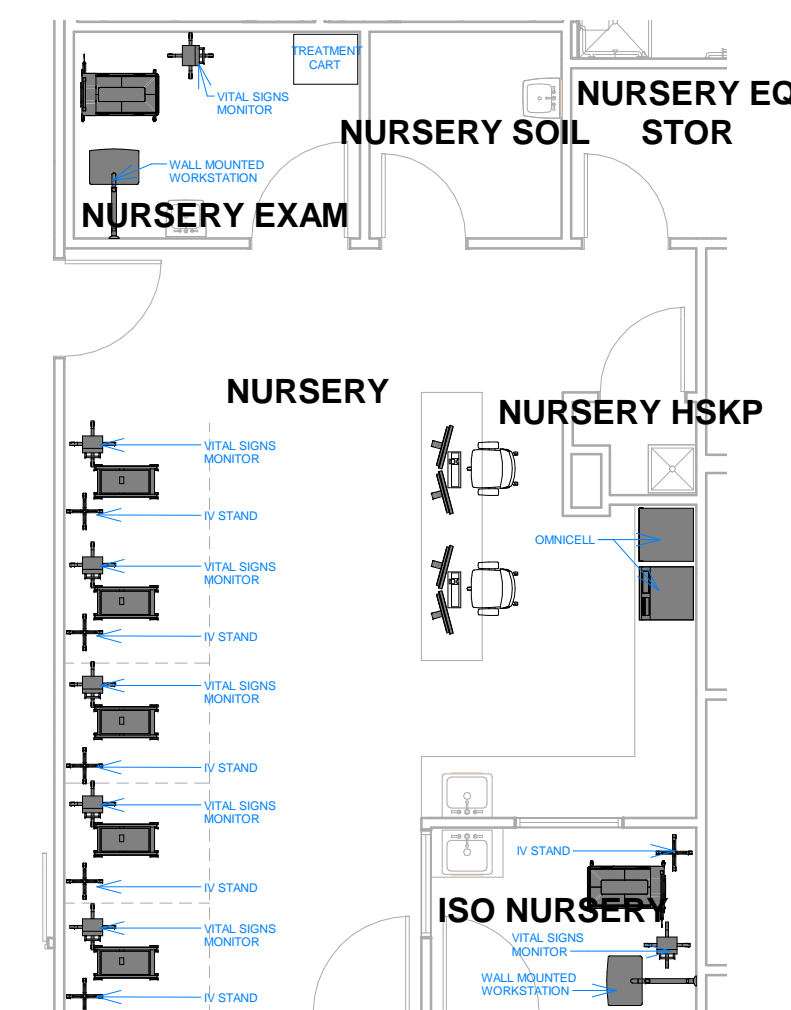

3 Level 04 - LDR - Nursery
1/8" = 1'-0"

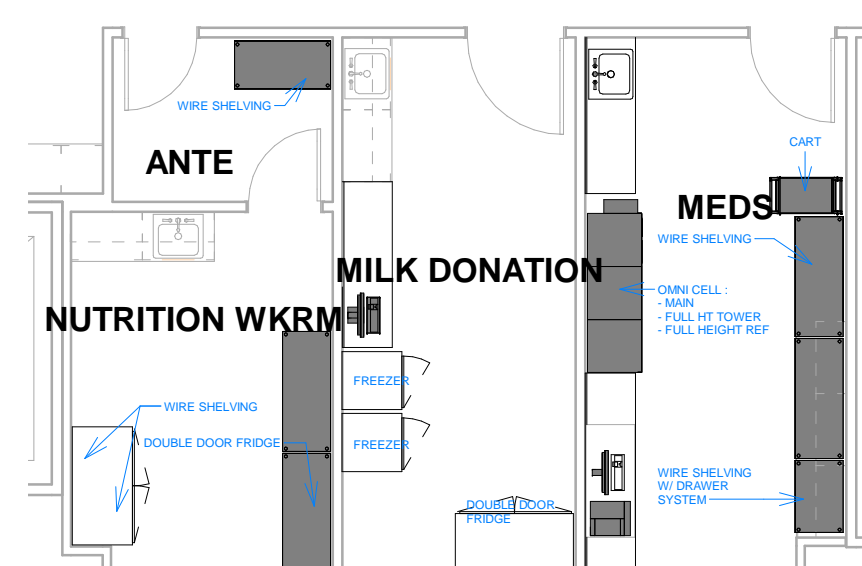

4 Level 04 - NICU - Ante/Nutrition
Workroom/Milk Donation/Meds
1/8" = 1'-0"

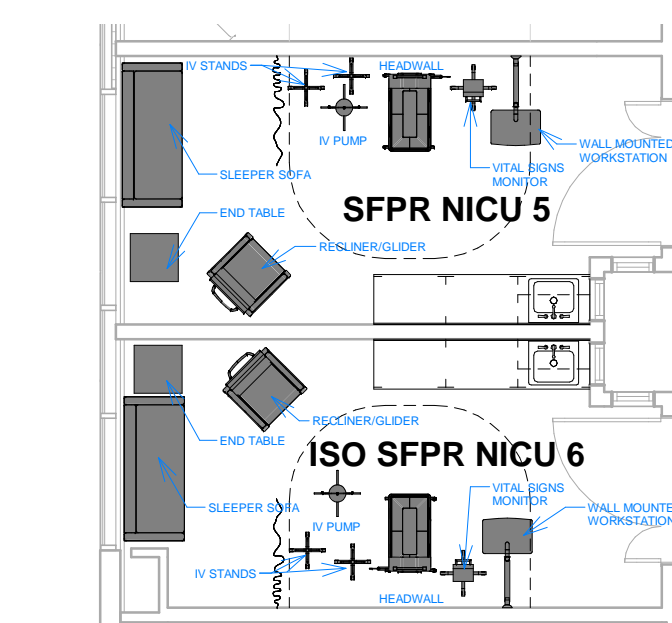

5 Level 04 - NICU - Patient Room
1/8" = 1'-0"

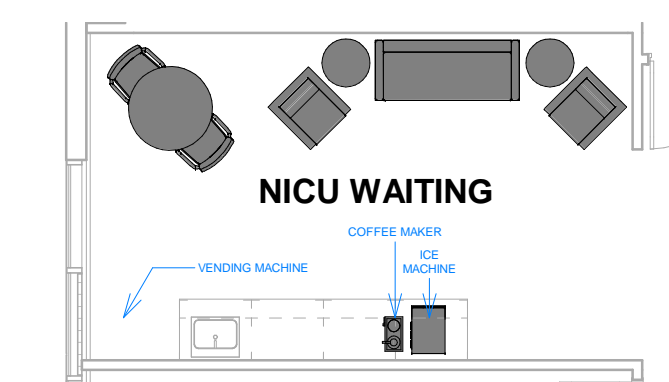

6 Level 04 - NICU - Waiting
1/8" = 1'-0"

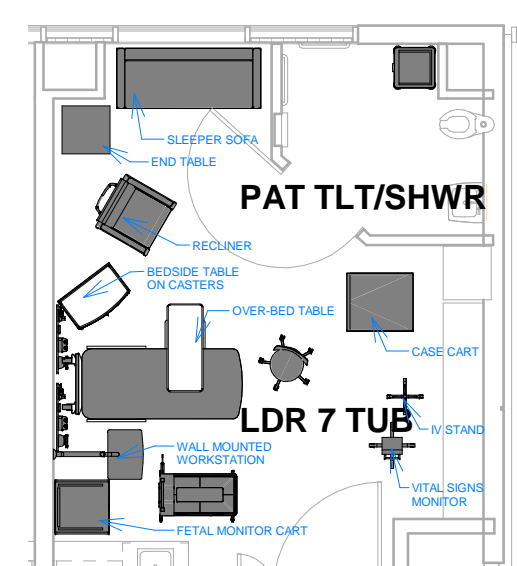

7 Level 04 - LDR - Patient Room
1/8" = 1'-0"

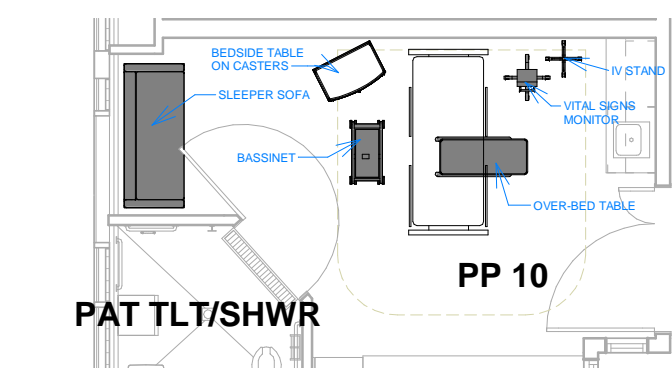

8 Level 04 - LDR - Post Partum
1/8" = 1'-0"

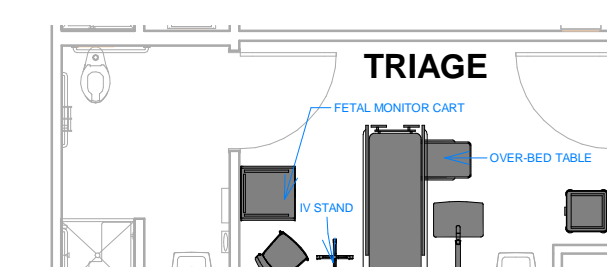

9 Level 04 - LDR -Triage
1/8" = 1'-0"



LEVEL 4 - OVERALL FLOOR PLAN

GENERAL NOTES:

1. EQUIPMENT SHOWN IN FLOOR PLAN IS REPRESENTATIVE OF TYPICALS AND OTHER REQUESTED ITEMS AND IS SHOWN PURELY FOR SPACE PLANNING. LAYOUTS OF ROOMS ARE SUBJECT TO CHANGE IN ORDER TO ACCOMMODATE OTHER EQUIPMENT REQUESTS.

2. FURTHER PLANNING ON SPECIFIC EQUIPMENT AND EXACT LOCATIONS TO BE DETERMINED IN DESIGN DEVELOPMENT AND CONSTRUCTION DOCUMENTS.

3. MECHANICAL, ELECTRICAL, PLUMBING, AND STRUCTURAL COORDINATION HAS NOT YET BEEN DONE, BUT WILL BE ADDRESSED LATER IN DESIGN.

4. ITEMS HIGHLIGHTED AND SHOWN TO BE PROVIDED BY A SPECIFIC VENDOR ARE STILL UNDER DESIGN AND SUBJECT TO CHANGE IN THE FUTURE. DRAWINGS WILL BE COORDINATED BY INTERESTED PARTIES AND NOT FOR CONSTRUCTION.

5. REFERENCE APPENDIX A FOR A BASELINE EQUIPMENT LIST FOR THE FACILITY. ALL THE ABOVE NOTES APPLY TO THE BASELINE EQUIPMENT LIST.

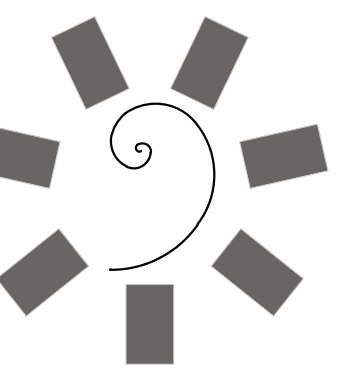

James R. Childers
Architect, Inc.
45 South 4th Street
Fort Smith, AR 72901
479-783-2480
www.childersarchitect.com

PROFESSIONAL SEAL:



Interior Logistics

NT:



CHEROKEE NATION
W.W. HASTINGS REPLACEMENT HOSPITAL
TAHLEQUAH, OKLAHOMA

MILLER & SMITH, OREGON 10101

PLAN:

SCHEMATIC DESIGN

[illegible]

NUMBER: 21-08.21

05-06-2022

EQ4.0

ET TITLE:

DR/PP/NICU/NURSERY/C-SECTION

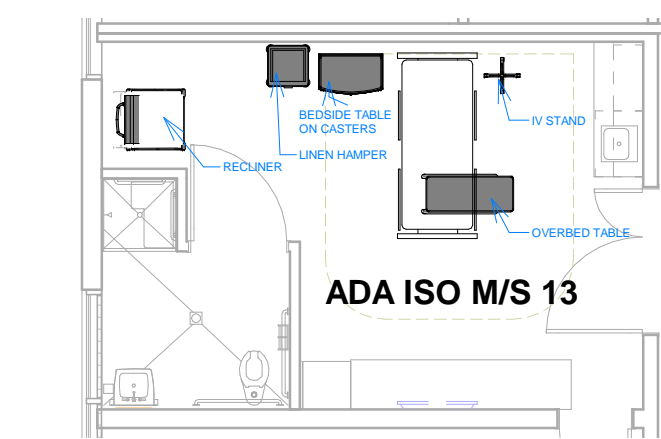
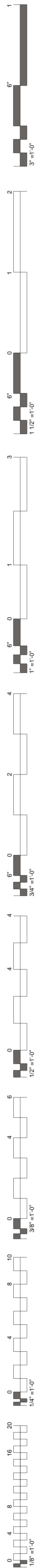

1 Level 06 - Acute Care - ISO M/S
1/8" = 1'-0"

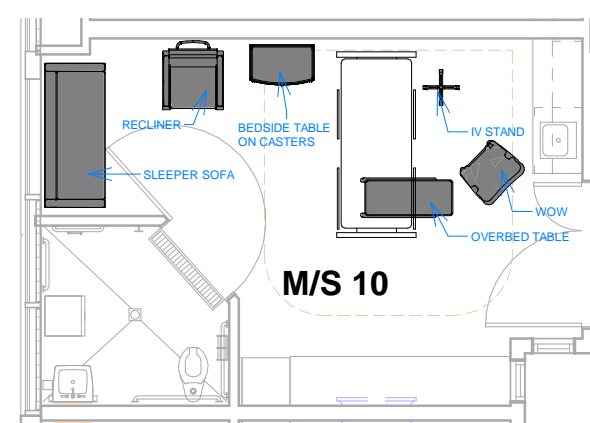

2 Level 06 - Acute Care - M/S Room
1/8" = 1'-0"

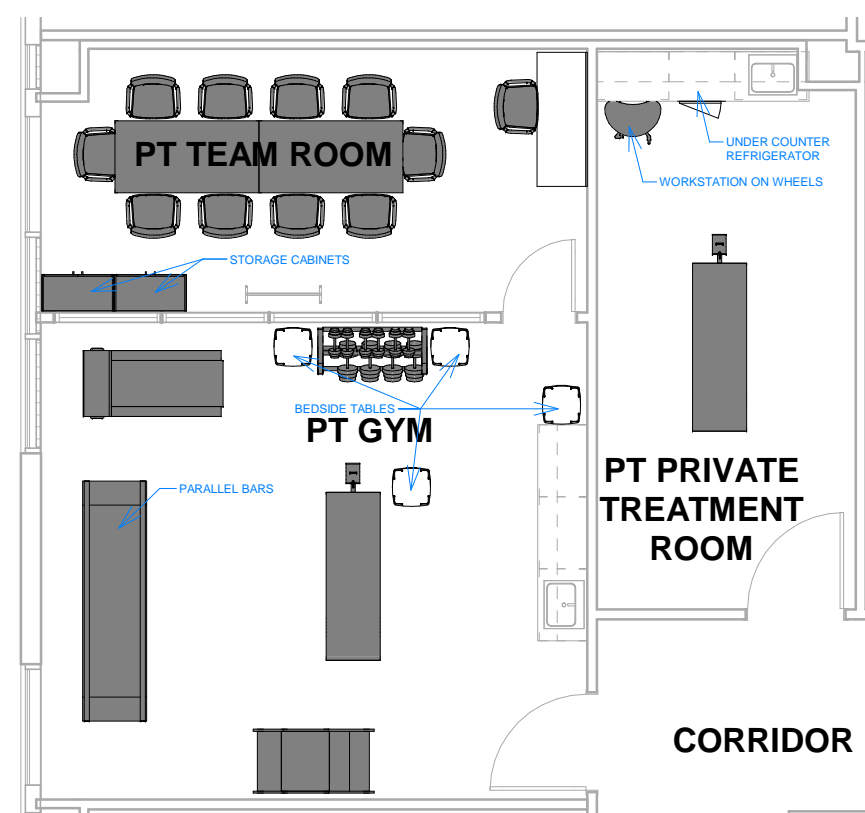

Level 06 - PT - Team Room/Gym/Private
Treatment Room
③ $1/8" = 1'-0"$

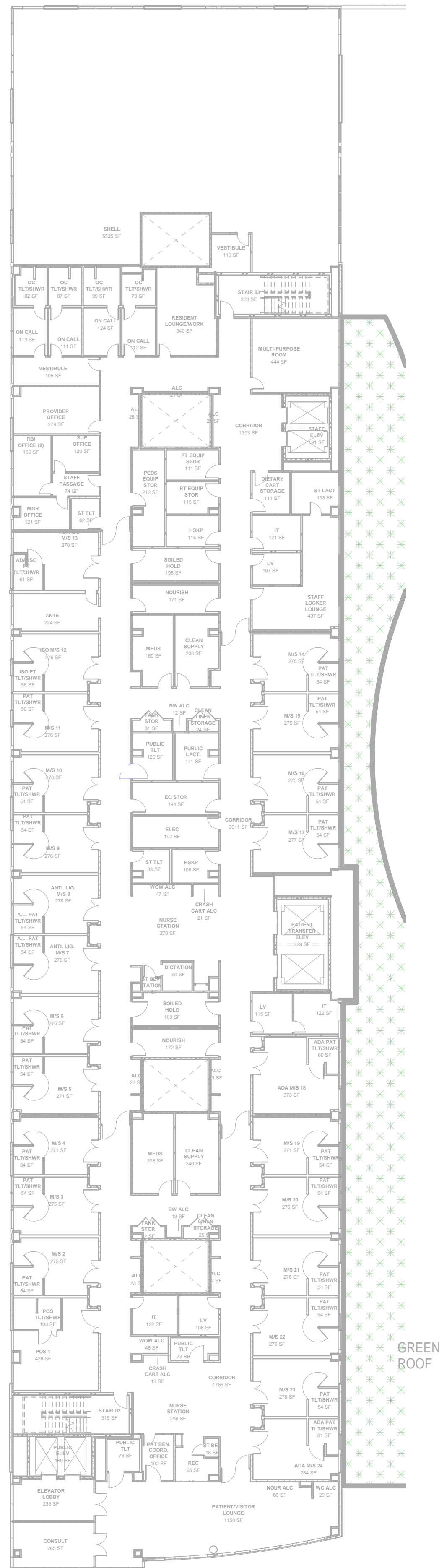

LEVEL 5 - OVERALL FLOOR PLAN

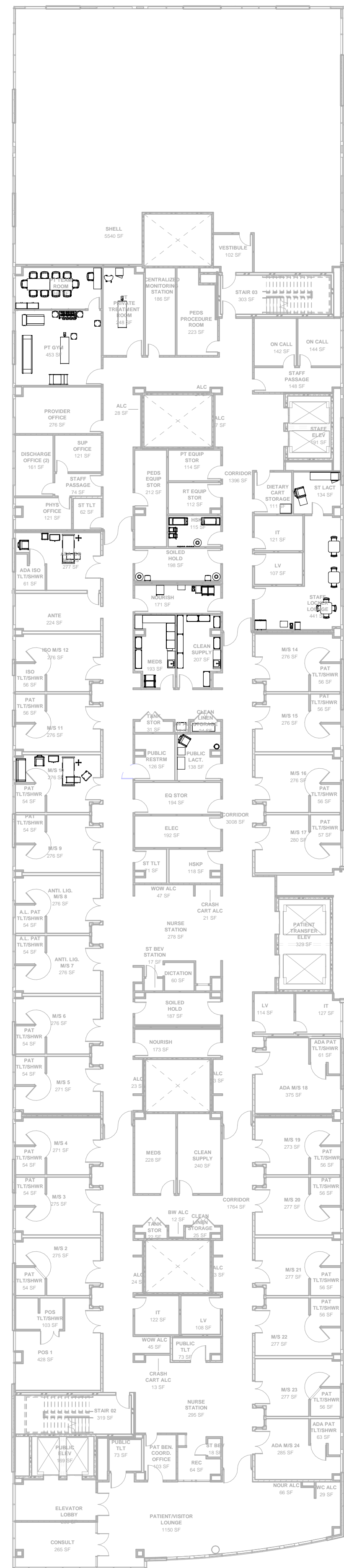

LEVEL 6 - OVERALL FLOOR PLAN

GENERAL NOTES:

1. EQUIPMENT SHOWN IN FLOOR PLAN IS REPRESENTATIVE OF TYPICALS AND OWNER REQUESTED ITEMS AND IS SHOWN PURELY FOR SPACE PLANNING. LAYOUTS OF ROOMS ARE SUBJECT TO CHANGE IN DESIGN DEVELOPMENT AND CONSTRUCTION DOCUMENTS.
2. FURTHER PLANNING ON SPECIFIC EQUIPMENT AND EXACT LOCATIONS IS TO BE DETERMINED IN DESIGN DEVELOPMENT AND CONSTRUCTION DOCUMENTS.
3. MECHANICAL, ELECTRICAL, PLUMBING, AND STRUCTURAL COORDINATION HAS NOT YET BEEN DONE, BUT WILL BE ADDRESSED LATER IN DESIGN.
4. ITEMS HIGHLIGHTED AND SHOWN TO BE PROVIDED BY A SPECIFIC VENDOR ARE STILL UNDER DESIGN AND SUBJECT TO CHANGE IN THE FUTURE. DRAWINGS WILL BE COORDINATED BY INTERIOR LOGISTICS UNLESS NOTED OTHERWISE.
5. REFERENCE APPENDIX A FOR A BASELINE EQUIPMENT LIST FOR THE FACILITY. ALL THE ABOVE NOTES APPLY TO THE BASELINE EQUIPMENT LIST.

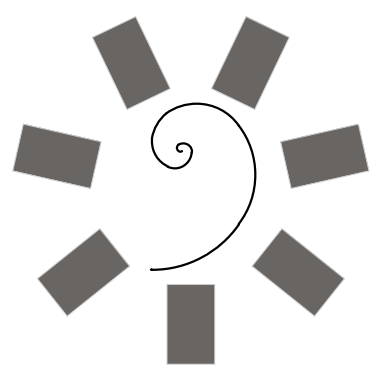

James R. Childers
Architect, Inc.

45 South 4th Street
Fort Smith, AR 72901
479-783-2480
www.childersarchitect.com

PROFESSIONAL SEAL:

CONSULTANT LOGO



CLIENT:



**CHEROKEE NATION
W.W. HASTINGS REPLACEMENT HOSPITAL**

TAHLEQUAH, OKLAHOMA

KEY PLAN:

PROJECT PHASE:

SCHEMATIC DESIGN

[illegible]

OB NUMBER: 21-08.21

DATE: 05-06-2022

SHEET NUMBER:

EQ5.0

SHEET TITLE:

ACUTE CARE/ MS,
PHYS. THER.

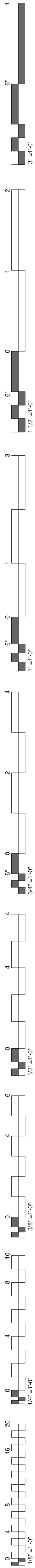

GENERAL NOTES:

1. EQUIPMENT SHOWN IN FLOOR PLAN IS REPRESENTATIVE OF TYPICALS AND OWNER REQUESTED ITEMS AND IS SHOWN PURELY FOR SPACE PLANNING. LAYOUTS OF ROOMS ARE SUBJECT TO CHANGE IN DESIGN DEVELOPMENT AND CONSTRUCTION DOCUMENTS.

2. FURTHER PLANNING ON SPECIFIC EQUIPMENT AND EXACT LOCATIONS IS TO BE DETERMINED IN DESIGN DEVELOPMENT AND CONSTRUCTION DOCUMENTS.

3. MECHANICAL, ELECTRICAL, PLUMBING, AND STRUCTURAL COORDINATION HAS NOT YET BEEN DONE, BUT WILL BE ADDRESSED LATER IN DESIGN.

4. ITEMS HIGHLIGHTED AND SHOWN TO BE PROVIDED BY A SPECIFIC VENDOR ARE STILL UNDER DESIGN AND SUBJECT TO CHANGE IN THE FUTURE. DRAWINGS WILL BE COORDINATED BY INTERIOR LOGISTICS UNLESS NOTED OTHERWISE.

5. REFERENCE APPENDIX A FOR A BASELINE EQUIPMENT LIST FOR THE FACILITY. ALL THE ABOVE NOTES APPLY TO THE BASELINE EQUIPMENT LIST.



**James R. Childers
Architect, Inc.**
45 South 4th Street
Fort Smith, AR 72901
479-783-2480
www.childersarchitect.com

PROFESSIONAL SEAL:

CONSULTANT LOGO



Interior Logistics

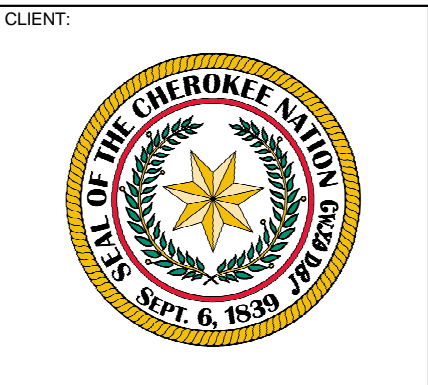

CHEROKEE NATION

W.W. HASTINGS REPLACEMENT HOSPITAL

TAHLEQUAH, OKLAHOMA

KEY PLAN:

PROJECT PHASE:
SCHEMATIC DESIGN

#	DATE	REVISIONS DESCRIPTION

JOB NUMBER: 21-08.21
DATE: 05-06-2022
SHEET NUMBER:
EQ6.0
SHEET TITLE:
TYPICALS EQUIPMENT LAYOUTS

